

Ball Valves/ Catalog



CONTI

valve manufacturer since 1919





1919-2009: a 90-year history of quality and reliability

CONTI RUBINETTERIE, established in 1919 by Giovanni Conti, was the first valve manufacturing company to be erected in Valduggia which is located in northeastern Piedmont. Valduggia became in time one of the most important production areas of valves and fittings in the world. With its more than 90-year experience, today Conti Rubinetterie has become a major leader in the production of bronze and brass valves and its products are sold in more than 50 countries worldwide.

Thanks to its advanced manufacturing techniques and equipment, its continued programme of engineering research, its skilled craftsmen and technical expertise, Conti designs and constructs reliable products for these fields and applications:

- Petrochemical industry
- Irrigation systems
- Mining and infrastructure industries
- Shipyard industry
- Compressed air
- Textile industry
- Mechanical industry
- Steam applications
- Other various industries

In addition to these, Conti Rubinetterie has become highly successful at developing specialized bronze and bronze alloy valves for industries which require the following characteristics:

- Desalination
- Highly corrosive environments

Conti Rubinetterie is the ideal business partner for any industrial sector, thanks to its wide range of products (ball valves, gate valves, globe valves, check valves, etc.) as well as custom-made solutions, making it one of the most complete in Europe. In addition to the European market the valves are successfully sold in South America, North and South Africa, Middle East, Australia and Singapore.

The company is still ran by the Conti family who over time has created a solid organization aimed at building up an innovative environment based on quality, reliability and availability.

Conti Rubinetterie has two manufacturing plants as well as its own bronze foundry (a very rare case in the industry), which allows it to have complete control over every aspect of the production process: purchase of the raw materials, casting of the individual pieces, tooling and machining of all components, assembling and packaging of all items. A final testing is carried out on each valve before it is considered ready to be shipped.

Today, Conti Rubinetterie is a complete premier source for all valve needs and 100% of its production is proudly "Made in Italy".

Directions

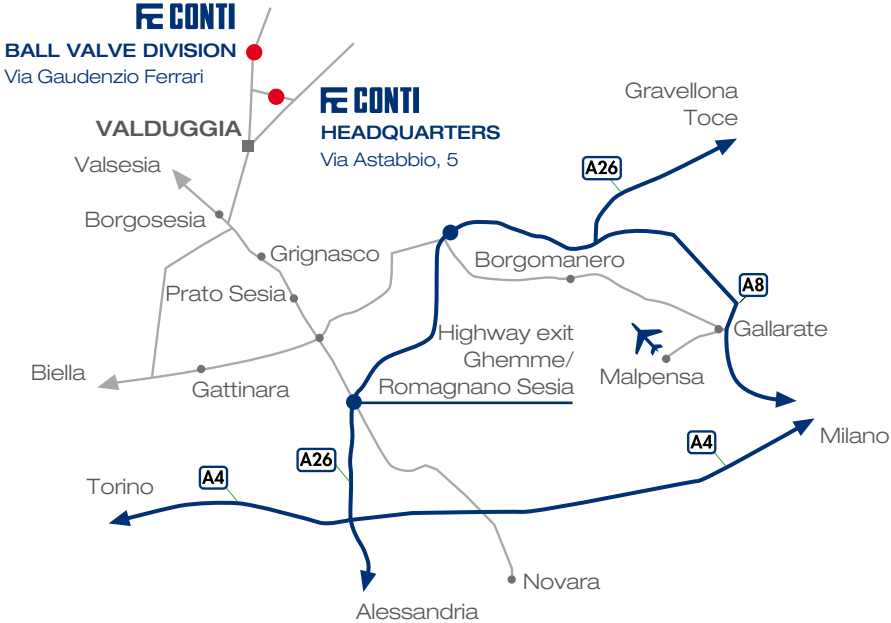

→ Conti manufacturing facilities and foundry

Certified know-how

Conti holds a leading role in the quest of quality construction and production processes. Our valves completely designed and manufactured in our factories by a skilled team and with the most innovative equipment, are constructed to last over time. They undergo a stringent and rigorous sequence of tests and internal inspections. Today, just as 90 years ago, product quality continues to be at the heart of every stage of the production cycle.

Qualified certifying laboratories worldwide have certified our valves for their performance, solidity and duration.



→ Conti Rubinetterie has a quality system certificate in compliance with UNI EN ISO 9001:2008 standards



→ Our valves are manufactured according to the European PED 97/23/CE standards

100% Production Control



→ Raw materials are purchased directly from certified suppliers



→ Internal foundry guarantees quality from the earliest stages of production



→ Bodies and components are entirely machined on-site



→ Tooling, assembly and testing machineries have been developed according to our specific needs

Technology



→ All production processes use the most technologically advanced equipment

Reliability



→ Each and every valve is tested before being sent out

Solutions

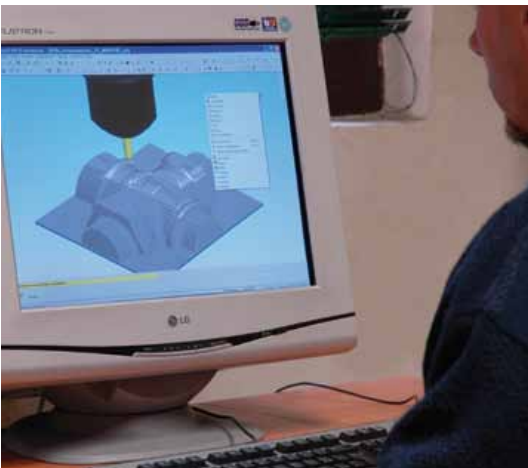

→ Special requirements and custom needs are taken care of quickly and with expertise

Respecting the Environment



The SUN provides 40% of the energy our production process requires



The WATER used during the production processes is purified with a filtration system and recycled



The AIR from the foundry vapors is gathered, purified by a certified filtration system and released clean into the environment



INDEX

PAGE

THREADED BALL VALVES	07
BALL VALVES WITH HOSE JOINTS	14
THREADED MINI BALL VALVES	15
COPPER COMPRESSION-END BALL VALVES	16
FLANGED BALL VALVES	18
MATERIAL COMPATIBILITY SUMMARY	19

CUSTOM OPTIONS AVAILABLE

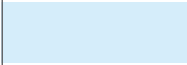
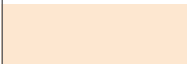
Upon customer requests the following alloys and/or materials may be chosen. Please note that each color corresponds to a specific option shown in the catalog.

	STAINLESS STEEL AISI 316
	ALUMINIUM/BRONZE ALLOY
	MONEL 400 ALLOY
	CAST IRON GS 400

■ THREADED VALVES can be manufactured according to the following standards:

ANSI - ASME B1.20.1 - NPT
GAS UNI - ISO228
ISO7/1 RC - RP THREADS

■ FLANGED VALVES can be manufactured according to the following standards:

PN16
PN20
B16.24 ASA 150



04352

**BRASS BALL VALVE PN25 FULL WAY FXF
BLOW-OUT PROOF STEM,
ADJUSTABLE PACKING**
PN25 600WOG

04355

PN25 600WOG
AISI 316 BALL AND STEM

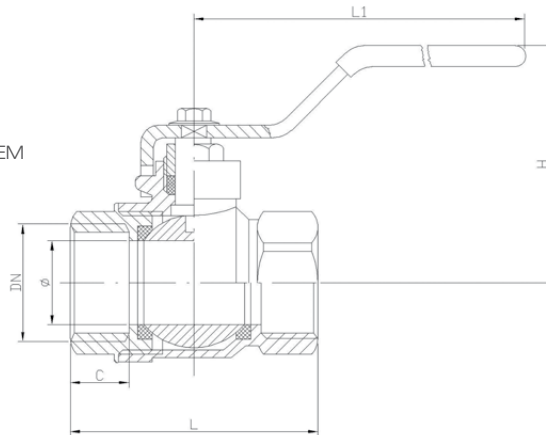

STANDARD MATERIALS	
Body	Brass-CW617N UNI EN12165
Body End	Brass-CW617N UNI EN12165
Ball	Brass-CW614N UNI EN12164
Stem	Brass-CW614N UNI EN12164
Seat	PTFE

	1-4"	3-8"	1-2"	3-4"	1"	1"1-4	1"1-2	2"	2"1-2	3"	4"
Ø (mm)	10	10	15	20	25	32	40	50	65	80	100
L (mm)	39	39	55	62	71	83	95	114	147	169	191
L1 (mm)	80	80	93	91	128	128	140	140	286	286	286
H (mm)	39	39	53	58	65	70	82	92	120	130	145
C (mm)	9	9	13	14	16	17	18	21	28	28	32
WEIGHT (Kg)	0,100	0,110	0,220	0,325	0,515	0,710	1,170	1,800	3,810	5,570	8,900



04354

**DZR BRASS BALL VALVE PN25 FULL WAY FXF
BLOW-OUT PROOF STEM,
ADJUSTABLE PACKING**
PN25 600WOG

04357

PN25 600WOG
BALL AISI 316 BALL SUITABLE
FOR DRINKING WATER

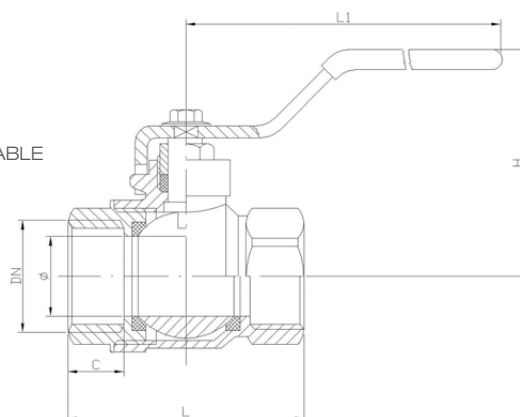

STANDARD MATERIALS	
Body	Dzr Brass-CW602N UNI EN12165
Body End	Dzr Brass-CW602N UNI EN12165
Ball	Dzr Brass-CW602N UNI EN12164
Stem	Dzr Brass-CW602N UNI EN12164
Seat	PTFE

	1-4"	3-8"	1-2"	3-4"	1"	1"1-4	1"1-2	2"
Ø (mm)	10	10	15	20	25	32	40	50
L (mm)	39	39	55	62	71	83	95	114
L1 (mm)	80	80	93	91	128	128	140	140
H (mm)	39	39	53	58	65	70	82	92
C (mm)	9	9	13	14	16	17	18	21
WEIGHT (Kg)	0,100	0,110	0,220	0,325	0,515	0,710	1,170	1,800



04363

**BRASS BALL VALVE PN25 FULL WAY FxF
LONG NECK, ADJUSTABLE PACKING**
PN25 600WOG

STANDARD MATERIALS	
Body	Brass-CW617N UNI EN12165
Body end	Brass-CW617N UNI EN12165
Ball	Brass-CW614N UNI EN12164
Stem	Brass-CW614N UNI EN12164
Seat	PTFE

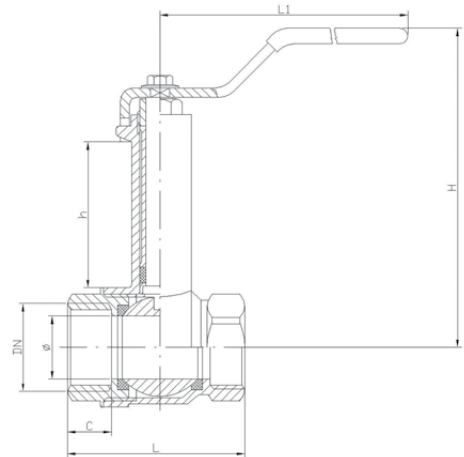

	3-8"	1-2"	3-4"	1"	1"-4"	1"-2"	2"
Ø (mm)	10	15	20	25	32	40	50
h (mm)	14	46,5	46,5	50,2	50,2	57,5	57,5
H (mm)	50	94	98	106	111	130	138
L (mm)	39	54,5	61,5	70	84	95,5	114
C (mm)	9	13	14	16	17	18	21
L1 (mm)	80	92	92	129	129	140	140
WEIGHT (Kg)	0,280	0,330	0,400	0,600	0,800	1,350	2,000



04364

**DZR BRASS BALL VALVE PN25 FULL WAY FxF
LONG NECK, ADJUSTABLE PACKING**
PN25 600WOG

STANDARD MATERIALS	
Body	Dzr Brass-CW602N UNI EN12165
Body End	Dzr Brass-CW602N UNI EN12165
Ball	Dzr Brass-CW602N UNI EN12164
Stem	Dzr Brass-CW602N UNI EN12164
Seat	PTFE

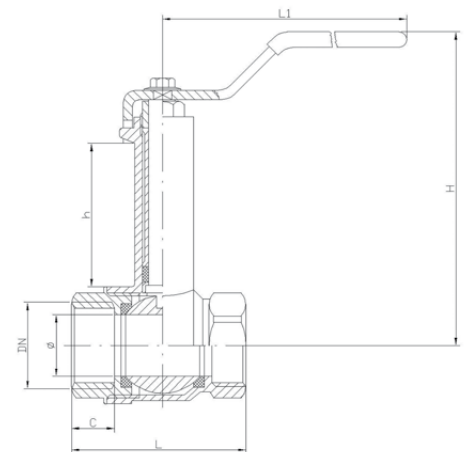

	3-8"	1-2"	3-4"	1"	1"-4"	1"-2"	2"
Ø (mm)	10	15	20	25	32	40	50
h (mm)	14	46,5	46,5	50,2	50,2	57,5	57,5
H (mm)	50	94	98	106	111	130	138
L (mm)	39	54,5	61,5	70	84	95,5	114
C (mm)	9	13	14	16	17	18	21
L1 (mm)	80	92	92	129	129	140	140
WEIGHT (Kg)	0,280	0,330	0,400	0,600	0,800	1,350	2,000



04456

**BRONZE BALL VALVE PN25 FULL WAY FXF
LONG NECK, ADJUSTABLE PACKING**
PN25 600WOG

04458

PN25/B 150WSP 300WOG
AISI 316 BALL AND STEM

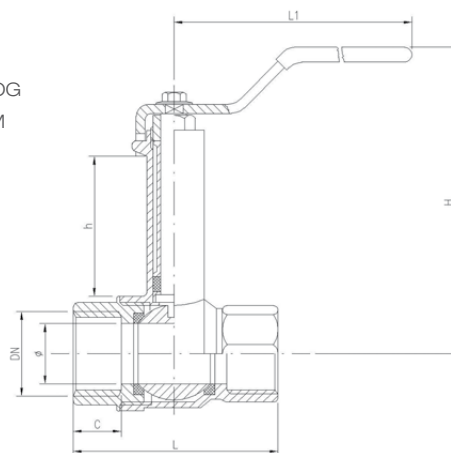

STANDARD MATERIALS

Body	Brass-CC491K UNI EN1982
Body end	Brass-CC491K UNI EN1982
Ball	Brass-CW614N UNI EN12164
Stem	Brass-CW614N UNI EN12164
Seat	PTFE

	1-2"	3-4"	1"	1"1-4	1"1-2	2"
Ø (mm)	15	20	25	32	40	46
h (mm)	46,5	46,5	50,2	50,2	57,5	55
H (mm)	94	98	106	111	130	138
L (mm)	57	68	79	93	101	121
C (mm)	14	16	19	21	22	26
L1 (mm)	92	92	129	129	140	140
WEIGHT (Kg)	0,300	0,440	0,660	0,890	1,500	2,780



04366

**BRASS BALL VALVE PN16 FULL WAY FXF
DOUBLE NECK, ADJUSTABLE PACKING**
PN16 600WOG

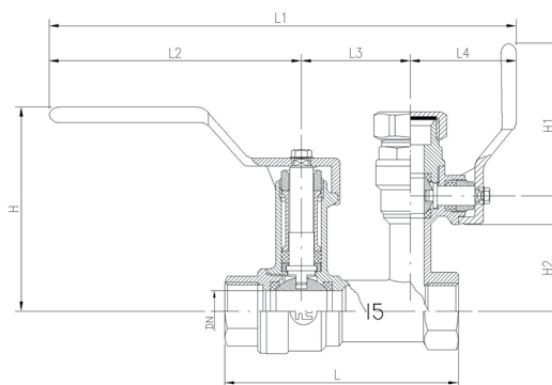

STANDARD MATERIALS

Body	Brass-CW617N UNI EN12165
Body end	Brass-CW617N UNI EN12165
Ball	Brass-CW614N UNI EN12164
Stem	Brass-CW614N UNI EN12164
Seat	PTFE

	1-2"	3-4"	1"	1"1-4	1"1-2	2"
Ø (mm)	15	20	25	32	40	46
L (mm)	85,4	91	98,8	106,8	117	119
L1 (mm)	169,7	169	202,5	202,5	220	225,5
L2 (mm)	93	93	125,5	125,5	140	144,5
L3 (mm)	39,7	39	40	40	43	44
L4 (mm)	37	37	37	37	37	37
H (mm)	75	80	85	90	100	138
H1 (mm)	80	80	80	80	80	80
H2 (mm)	31,65	45,2	48,6	53	66	84
WEIGHT (Kg)	0,408	0,550	0,800	1,200	1,800	2,570



04001

**BRASS BALL VALVE PN16 REDUCE WAY FXF
BLOW-OUT PROOF STEM,
ADJUSTABLE PACKING
PN16**

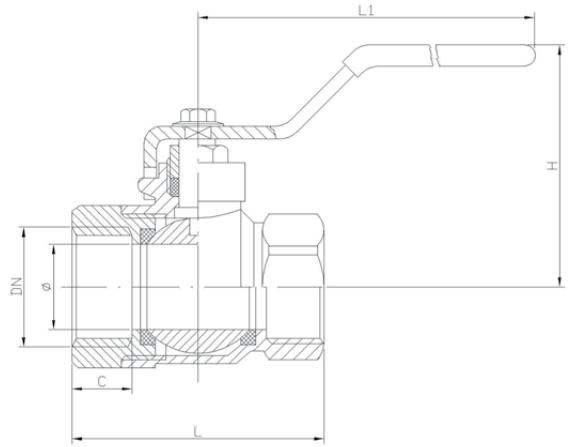

STANDARD MATERIALS	
Body	Brass-CW617N UNI EN12165
Body end	Brass-CW617N UNI EN12165
Ball	Brass-CW614N UNI EN12164
Stem	Brass-CW614N UNI EN12164
Seat	PTFE

	1-2"	3-4"	1"	1"1-4	1"1-2	2"	2"1-2	3"
Ø (mm)	12	15	20	25	32	40	50	65
L (mm)	53	65	71	83	95	117	148	169
L1 (mm)	91	91	128	128	140	140	240	286
H (mm)	52	56	64	69	80	95	125	130
C (mm)	13	13	16	17	18	19	28	28
WEIGHT (Kg)	0,216	0,345	0,522	0,835	1,180	1,880	3,460	5,570



04452

**BRASS BALL VALVE PN25 FULL WAY MXF,
BLOW-OUT PROOF STEM,
ADJUSTABLE PACKING
PN25 600WOG**

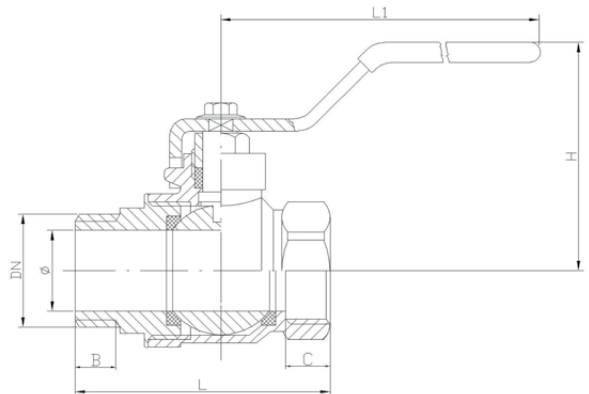

STANDARD MATERIALS	
Body	Brass-CW617N UNI EN12165
Body End	Brass-CW617N UNI EN12165
Ball	Brass-CW614N UNI EN12164
Stem	Brass-CW614N UNI EN12164
Seat	PTFE

	1-4"	3-8"	1-2"	3-4"	1"	1"1-4	1"1-2	2"
Ø (mm)	10	10	15	20	25	32	40	50
L (mm)	47	47	64	71	82	96	108	127
L1 (mm)	80	80	93	93	126	126	145	145
H (mm)	39	39	53	56	65	70	80	88
C (mm)	9	9	12	13	15	15	16	18
B (mm)	10	10	12	12	16	18	19	21
WEIGHT (Kg)	0,130	0,127	0,340	0,530	0,530	0,840	1,260	1,890



04442

**BRONZE BALL VALVE PN40 FULL WAY FXF,
BLOW-OUT PROOF STEM,
ADJUSTABLE PACKING**

PN40 600WOG

04443

PN40 600WOG
ALL IN Bz/AI

04445

PN40 600WOG
Bz/AI BALL AND STEM

04446

PN40 600WOG
AISI 316 BALL AND STEM

04448

PN40 600WOG
Bz/AI BODY, AISI 316 BALL AND STEM

04449

PN40 600WOG
MONEL 400 BALL AND STEM

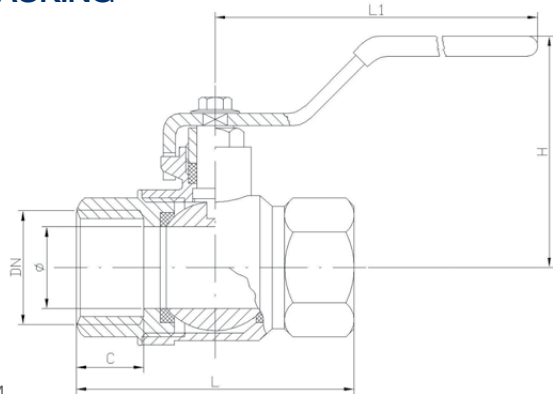

	STANDARD MATERIALS
Body	Bronze-CC491K UNI EN1982
Body End	Bronze-CC491K UNI EN1982
Ball	Brass-CW614N UNI EN12164
Stem	Brass-CW614N UNI EN12164
Seat	PTFE

	1-4"	3-8"	1-2"	3-4"	1"	1"1-4	1"1-2	2"	2"1/2	3"	4"
Ø (mm)	10	10	15	20	25	32	40	50	65	80	100
L (mm)	39	39	57	68	79	93	107	130	152	175	200
L1 (mm)	80	80	92	92	126	126	142	142	286	286	286
H (mm)	38	38	55	56	68	72	82	91	125	135	165
C (mm)	9	9	14	17	19	21	22	26	30	30	30
WEIGHT (Kg)	0,110	0,120	0,255	0,380	0,580	0,920	1,650	2,300	4,150	5,800	9,100



04480

**BRONZE BALL VALVE PN64 FULL WAY FXF,
BLOW-OUT PROOF STEM**

PN64 800WOG

04481

PN64 800WOG
Bz/AI BALL

04482

PN64 800WOG
ALL IN Bz/AI

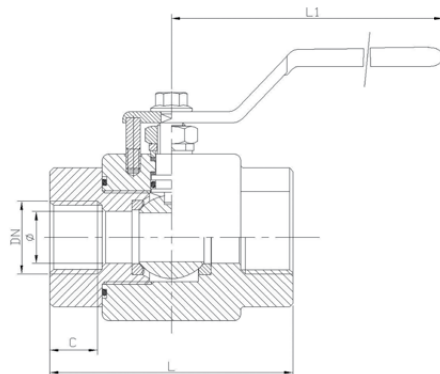

	STANDARD MATERIALS
Body	Bronze CC491K UNI EN1982
Body End	Bronze CC491K UNI EN1982
Ball	Bronze CC491K UNI EN1982
Stem	AISI 316
Seat	PTFE

	1-2"	3-4"	1"	1"1-4	1"1-2	2"
Ø (mm)	15	20	25	32	40	50
L (mm)	70	80	95	115	120	140
L1 (mm)	90	90	125	125	142	142
C (mm)	15	16	18	19	19	19



VSF04302

BRASS BALL VALVE PN20 FULL WAY FXF, BLOW-OUT PROOF STEM
PN20

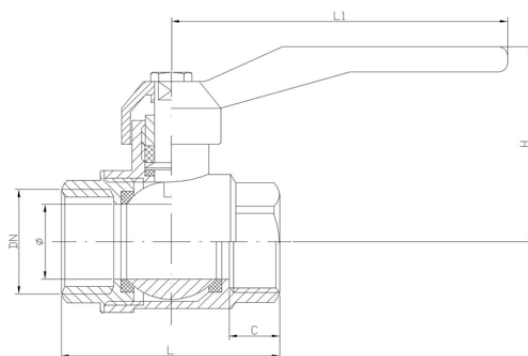

STANDARD MATERIALS	
Body	Brass-CW617N UNI EN12165
Body End	Brass-CW617N UNI EN12165
Ball	Brass-CW614N UNI EN12164
Stem	Brass-CW614N UNI EN12164
Seat	PTFE

	1-4"	3-8"	1-2"	3-4"	1"	1"1-4	1"1-2	2"	2"1-2	3"	4"
Ø (mm)	10	10	14	19	25	31	39	49	63	75	100
L (mm)	42	42	49	58	68	82	89	105	131	150	190
L1 (mm)	90	90	90	90	115	115	150	150	270	270	320
H (mm)	40	40	45	50	58	65	80	87	110	120	155
C (mm)	10	10	12	13	14	16	16	17	23	25	26
PN	20	20	20	20	20	16	16	16	10	10	10
WEIGHT (Kg)	0,148	0,148	0,148	0,200	0,342	0,542	0,810	1,280	2,675	4,424	7,000



VSF04342

BRASS BALL VALVE PN20 FULL WAY MXF, BLOW-OUT PROOF STEM
PN20

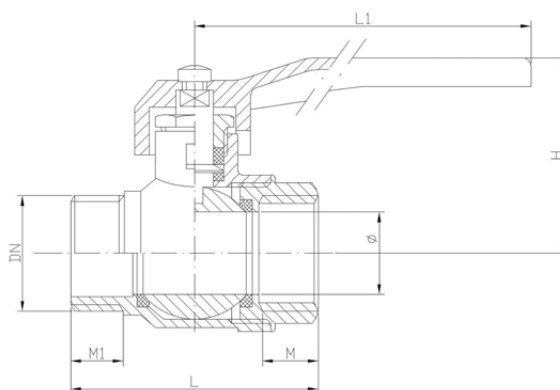

STANDARD MATERIALS	
Body	Brass-CW617N UNI EN12165
Body End	Brass-CW617N UNI EN12165
Ball	Brass-CW614N UNI EN12164
Stem	Brass-CW614N UNI EN12164
Seat	PTFE

	1-4"	3-8"	1-2"	3-4"	1"	1"1-4	1"1-2	2"
Ø (mm)	10	10	14	19	25	31	39	49
L (mm)	42	42	54	59	68	82	89	105
L1 (mm)	90	90	90	90	115	115	150	150
H (mm)	40	40	45	50	58	68	80	87
M (mm)	10	10	12	13	14	17	17	19
M1 (mm)	9	10	13	14	16	18	18	20
PN	20	20	20	20	20	16	16	16

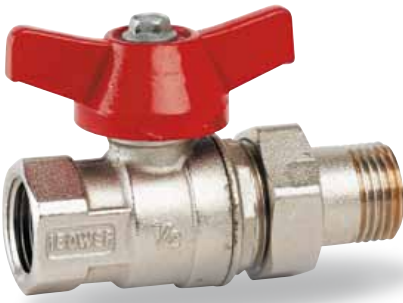

04505

**BRASS BALL VALVE PN25 FULL WAY MXF,
BLOW-OUT PROOF STEM WITH PIPE UNION**
PN25 600WOG

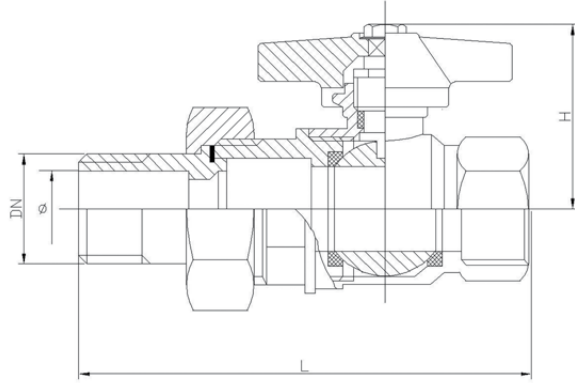

STANDARD MATERIALS	
Body	Brass-CW617N UNI EN12165
Body End	Brass-CW617N UNI EN12165
Ball	Brass-CW614N UNI EN12164
Stem	Brass-CW614N UNI EN12164
Seat	PTFE

	1-2"	3-4"	1"
Ø (mm)	15	20	25
L (mm)	84	97	112
H (mm)	55	56	78



VSF04900

**BRASS BALL VALVE PN25 THREE WAY
SCREWED ENDS, BLOW-OUT PROOF STEM**
PN25 600WOG

- L**
BALL TYPE "L"
- T1**
BALL TYPE "T1"
- T2**
BALL TYPE "T2"

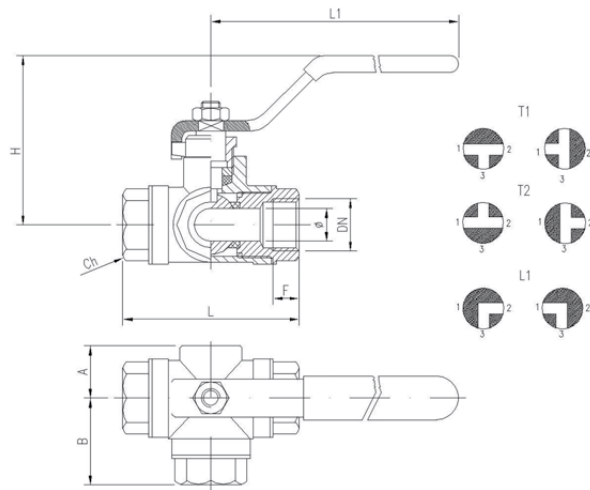

STANDARD MATERIALS	
Body	Brass-CW617N UNI EN12165
Body End	Brass-CW617N UNI EN12165
Ball	Brass-CW614N UNI EN12164
Stem	Brass-CW614N UNI EN12164
Seat	PTFE

	1/4"	3/8"	1-2"	3-4"	1"	1"1-4	1"1-2	2"
Ø (mm)	10	10	12	15	20	25	32	40
F (mm)	12	12	14	16	19	21	23	26
L (mm)	74	74	80	90	105	115	138	161
H (mm)	58	58	60	64	73	79	100	105
L1 (mm)	90	90	125	125	140	140	220	220
A (mm)	22	22	24	28	31	35	42	48
B (mm)	37	37	39	46	52	58	69	80
Ch (mm)	22	22	29	34	42	50	57	68
PN (mm)	32	32	32	32	32	25	25	25



VSF04708

**BRASS BALL BIBCOCK PN10 M
WITH HOSE JOINTS**
PN10

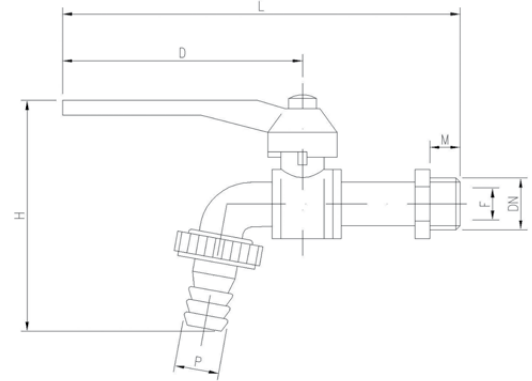

STANDARD MATERIALS	
Body	Brass-CW617N UNI EN12165
Body End	Brass-CW617N UNI EN12165
Ball	Brass-CW614N UNI EN12164
Stem	Brass-CW614N UNI EN12164
Seat	PTFE

	1-2"	3-4"	1"
D (mm)	90	90	90
H (mm)	92	103	118
L (mm)	136	155	170
M (mm)	10	14	15
P (mm)	14	20	25
F (mm)	10	12	14
WEIGHT (Kg)	0,190	0,320	0,435



VSF05700

**BRASS BALL VALVE PN16
FOR DRAINING BOILER**
PN16

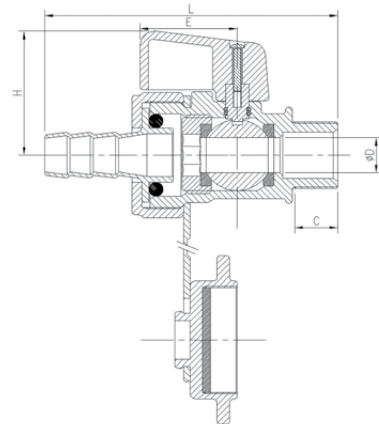

STANDARD MATERIALS	
Body	Brass-CW617N UNI EN12165
Body End	Brass-CW617N UNI EN12165
Ball	Brass-CW614N UNI EN12164
Stem	Brass-CW614N UNI EN12164
Seat	PTFE

	3-8"	1-2"
Ø (mm)	10	11
L (mm)	69	69
H (mm)	31	31
E (mm)	22	22
C (mm)	9	10



VSF05650

HOT PRESSED BRASS MINI BALL VALVE PN16 FXM

PN16

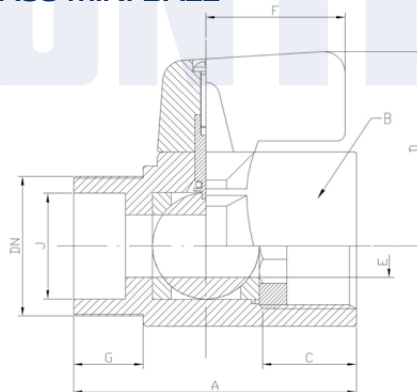

STANDARD MATERIALS	
Body	Brass-CW617N UNI EN12165
Ball	Brass-CW614N UNI EN12164
Stem	Brass-CW614N UNI EN12164
Seat	PTFE

	1-4"	3-8"	1-2"	1-2"	1-2"	1-2"	3-4"	1"
J (mm)	8	12	12	14	15	16	18	25
G (mm)	9	10	10,5	10,5	10,5	10,5	13,5	15
C (mm)	10	10	10,5	10,5	10,5	10,5	13,5	15
A (mm)	39	40	45	45	45	45	51	62,5
E (mm)	8	8	10	10	10	10	12	17,5
B (mm)	21	21	25	25	25	25	30	37
D (mm)	27	27	29	29	29	29	31,5	35
F (mm)	22	22	22	22	22	22	22	22



VSF05500

BRASS MINI BALL VALVE PN16 FXF

PN16

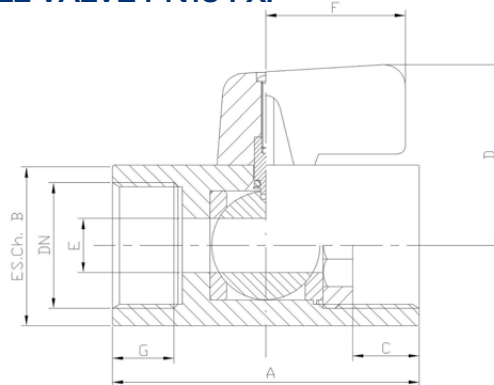

STANDARD MATERIALS	
Body	Brass-CW614N UNI EN12164
Ball	Brass-CW614N UNI EN12164
Stem	Brass-CW614N UNI EN12164
Seat	PTFE

	1-8"	1-4"	3-8"	1-2"	3-4"
G (mm)	9	9	10	10,5	13,5
C (mm)	9	9	9	10,5	13,5
A (mm)	39	39	42	47	54
E (mm)	6	8	8	10	12
B (mm)	21	21	21	25	30
D (mm)	27	27	27	29	31,5
F (mm)	22	22	22	22	22



VSF05550

BRASS MINI BALL VALVE PN16 FXM

PN16

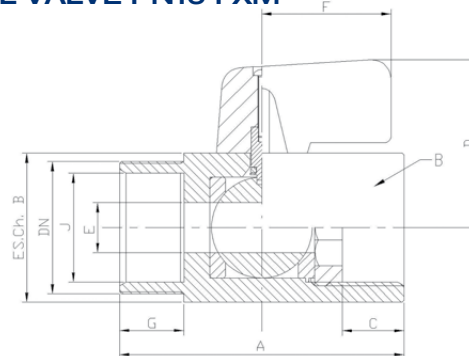

STANDARD MATERIALS	
Body	Brass-CW614N UNI EN12164
Ball	Brass-CW614N UNI EN12164
Stem	Brass-CW614N UNI EN12164
Seat	PTFE

	1-8"	1-4"	3-8"	3-8"	1-2"	1-2"	1-2"	1-2"	3-4"
J (mm)	6	8	10	12	12	14	15	16	18
G (mm)	9	9	10	10	10,5	10,5	10,5	10,5	13,5
C (mm)	10	10	10	10	10,5	10,5	10,5	10,5	13,5
A (mm)	39	39	40	40	45	45	45	45	51
E (mm)	6	8	8	8	10	10	10	10	12
B (mm)	21	21	21	21	25	25	25	25	30
D (mm)	27	27	27	27	29	29	29	29	31,5
F (mm)	22	22	22	22	22	22	22	22	22



04372

COPPER COMPRESSION DZR BRASS BALL VALVE PN25 FULL WAY, BLOW-OUT PROOF STEM, ADJUSTABLE PACKING

PN25 600WOG

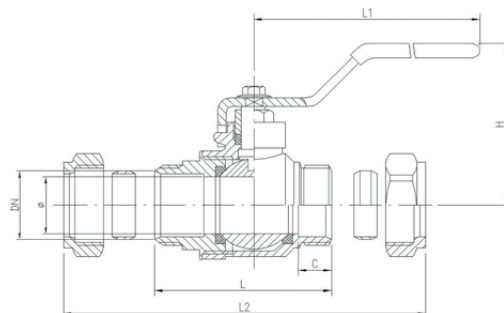

	STANDARD MATERIALS
Body	DZR Brass-CW602N UNI EN12165
Body End	DZR Brass-CW602N UNI EN12165
Ball	DZR Brass-CW602N UNI EN12164
Stem	DZR Brass-CW602N UNI EN12164
Seat	PTFE

	10	12	15	18	22	28	35	42	54
Ø (mm)	10	10	14	16	20	25	32	40	50
L (mm)	46	46	57	63	67	77	93	104	113
L1 (mm)	80	80	95	95	95	127	128	140	140
L2 (mm)	60	60	74	80	85	97	112	128	140
H (mm)	38	38	52	56	56	64	69	80	88
C (mm)	9	9	13	15	13	16	17	20	20
WEIGHT (Kg)	0,165	0,165	0,250	0,290	0,390	0,600	1,000	1,600	2,430



04383

COPPER COMPRESSION DZR BRASS BALL VALVE PN25 FULL WAY MEDIUM NECK, BLOW-OUT PROOF STEM, ADJUSTABLE PACKING

PN25 600WOG

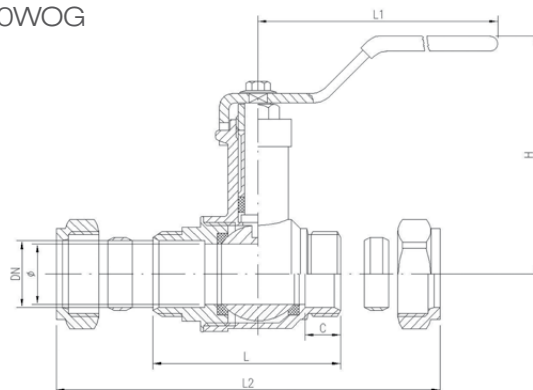

	STANDARD MATERIALS
Body	DZR Brass-CW602N UNI EN12165
Body End	DZR Brass-CW602N UNI EN12165
Ball	DZR Brass-CW602N UNI EN12164
Stem	DZR Brass-CW602N UNI EN12164
Seat	PTFE

	10	12	15	18	22	28	35	42	54
Ø (mm)	10	10	14	20	20	25	32	40	50
L (mm)	46	46	57	67	67	77	93	104	113
L1 (mm)	80	80	95	95	95	127	128	140	140
L2 (mm)	60	60	74	85	85	97	112	128	142
H (mm)	50	50	78	81	81	84	90	96	105
C (mm)	9	9	13	13	13	16	17	20	20
WEIGHT (Kg)	0,170	0,170	0,290	0,420	0,420	0,650	1,100	1,443	2,110



04470

DZR BRASS BALL VALVE PN16 FULL WAY SHORT NECK PRESS FITTING ENDS, BLOW-OUT PROOF STEM, ADJUSTABLE PACKING

PN16

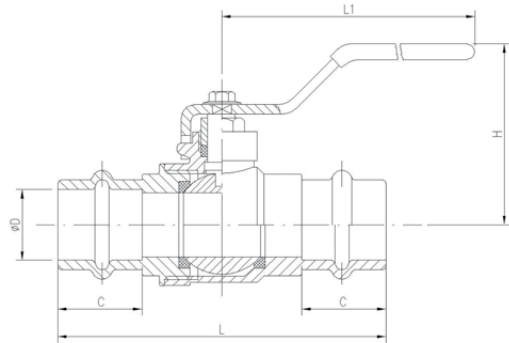

STANDARD MATERIALS

Body	DZR Brass-CW602N UNI EN12165
Body End	DZR Brass-CW602N UNI EN12165
Ball	DZR Brass-CW602N UNI EN12164
Stem	DZR Brass-CW602N UNI EN12164
Seat	PTFE

	15	22	28
Ø (mm)	15,2	22,3	28,3
L (mm)	86	105	122
L1 (mm)	95	95	127
H (mm)	52	56	64
C (mm)	20	24	24



04471

DZR BRASS BALL VALVE PN16 FULL WAY MEDIUM NECK PRESS FITTING ENDS, ADJUSTABLE PACKING

PN16

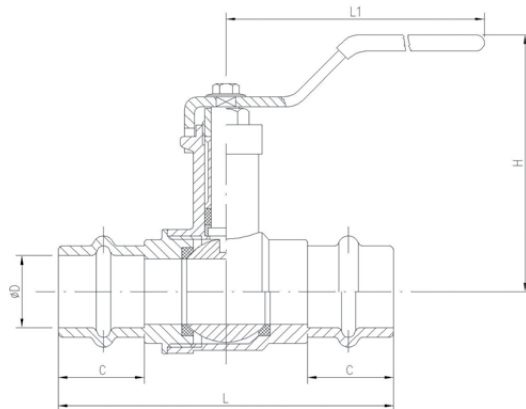

STANDARD MATERIALS

Body	DZR Brass-CW602N UNI EN12165
Body End	DZR Brass-CW602N UNI EN12165
Ball	DZR Brass-CW602N UNI EN12164
Stem	DZR Brass-CW602N UNI EN12164
Seat	PTFE

	15	22	28
Ø (mm)	15,2	22,3	28,3
L (mm)	86	105	122
L1 (mm)	95	95	127
H (mm)	78	81	84
C (mm)	20	24	24

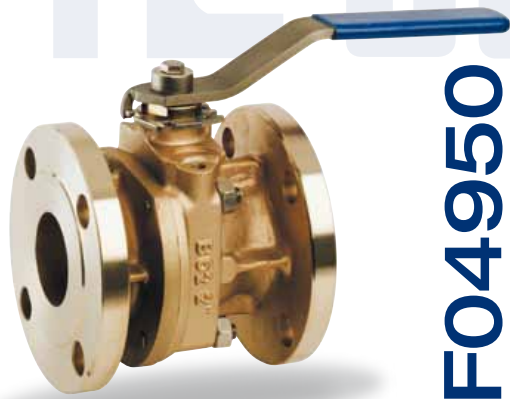

VSF04950

BRONZE BALL VALVE PN16 FULL WAY FLANGED ENDS PN16

VSF04951

PN16
ALL Bz/Al

VSF04953

PN16
BALL AND STEM Bz/Al

VSF04954

PN16
BALL AND STEM AISI 316

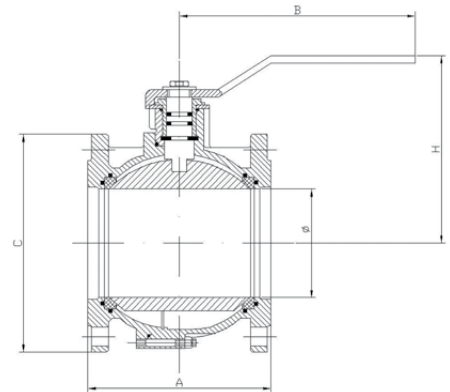

STANDARD MATERIALS

Body	Bronze-CC491K UNI EN1982
Body End	Bronze-CC491K UNI EN1982
Ball	Brass-CW617N UNI EN12165
Stem	Brass-CW614N UNI EN12164
Seat	PTFE+GRAPHITE

	1/2"	3/4"	1"	1 1/4"	1 1/2"	2"	2 1/2"	3"	4"	5"	6"	8"
Ø (mm)	15	20	25	32	40	50	63	76	95	120	145	190
A (mm)	115	120	125	130	140	150	170	180	190	200	210	400
B (mm)	160	160	170	170	220	220	284	284	360	447	560	1000
C (mm) (PN16)	95	105	115	140	150	165	185	200	220	250	285	340
H (mm)	84	84	95	100	118	125	152	166	180	225	242	320
OP.TORQUE (Nm)	15	15	18	18	18	20	40	70	100	180	250	600
WEIGHT (Kg)	2,800	3,400	4,800	5,600	7,900	10,500	15,100	19,100	24,000	36,700	44,600	93,000



VSF04956

CAST IRON BALL VALVE PN16 FULL WAY FLANGED ENDS PN16

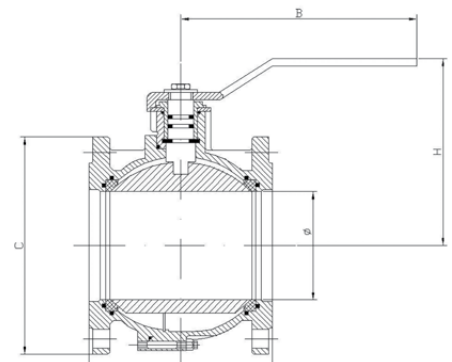

STANDARD MATERIALS

Body	CAST IRON G25
Body End	CAST IRON G25
Ball	CAST IRON G25
Stem	BRASS-CW614N UNI EN12164
Seat	PTFE+GRAPHITE

	1/2"	3/4"	1"	1 1/4"	1 1/2"	2"	2 1/2"	3"	4"	5"	6"
Ø (mm)	15	20	25	32	40	50	63	76	95	120	145
A (mm)	115	120	125	130	140	150	170	180	190	200	210
B (mm)	160	130	170	170	220	220	284	284	360	447	560
C (mm) (PN16)	95	105	115	140	150	165	185	200	220	250	285
H (mm)	84	85	95	100	118	125	152	166	180	225	242
OP.TORQUE (Nm)	15	15	18	18	18	20	40	70	100	180	250
WEIGHT (Kg)	2,800	3,400	4,800	5,600	7,900	10,500	19,100	24,000	36,700	44,600	93,000

LIQUID	Series 400	AISI304	AISI316	MONEL	CAST IRON	BRONZE	COPPER	NBR	EPDM	NICKEL	VITON
Butile acetate		1	1			1					
Amyl acetate		1	1	1		2					
Ethyl acetate		2	1		3		2		2		
Acetylene		1	1	1							
Vinegar	1	1	1			2		2	1		1
Acetone		1	1	1	1	1				1	
Acetic acid	1	1	1		4	1			1		
Glacial acetic acid	2	3	1			4					
Boric acid		1	1	1	4	2				1	
Bromidic acid		4	4	3	4	3				3	
Hydrocyanic acid		1	1	1	3						
Citric acid		2	1		3	3		1	1		1
Hydrochloric acid (HCl + H ₂ O)		1	1		2						1
Hydrochloric acid (HCl)		4	4								1
Chloroacetic acid		4	4		4	4				2	
Chlorosulphonic acid		2		2							
Chromic acid			1	2		4					
Fluoridic acid		4	4		4	2					1
Fluosilicic acid		4	4	3	4						
Formic acid		4	3		4	3			1		
Phosphoric acid (85% 80°C)		2	3			2			1		1
Phosphoric acid (25% < 80°C)	2	1	1			3			1		1
Phosphoric acid (60% < 20°C)	1	1	1		4	2			1		1
Hydrofluoric acid											
Lactic acid cold		3	2	1	4	3				1	
Nitric acid		1	1		4	4			2		1
Oleic acid		1	1	1	4	4				1	
Oxalic acid		2	2		4	2		3	1		1
Palmitic acid		1	1	1	1	1					
Sulfamic acid											
Sulfonic acid											
Sulfuric acid		4	2		4	2					
Sulfurous acid											
Stearic acid		1	1	1	3	3				1	
Tannic acid		2	2	1		1				1	
Tartaric acid		2	1					1	2		1
Acid mineral water with oxydising salts		1	1	4	4	3				4	
Deionised water									1		
Demineralsed water		2	1		3	4	4		1		1
Desalinated water		1	1		3			1	1		1
Distilled water											
Ionised water		1	1		3	3	3	1	1		
Oxygenated water		1	1					3	3		1
Salinated turpentine		2	2		3			1	1		1
Saline water		2	2		4						1
Water + abrasives		1	1		2	2		1	1		1
Ethyl alcohol		1	1					2	1		3
Isopropyl alcohol		1	1		1	1		2	1		1
Amide									1		
Ammoniac (NH ₄ OH)		2	2		2			1	1		1
Ammoniac (NH ₃)		2	2						1		
Carbonic anhydride liq.		1	1		3			1	2		2
Carbonic anhydride +H ₂ O		1	1		3			2	1		1
Maleic anhydride		2	1		3						1
Aniline, aniline oil		1	1	1	1	4					
Asphalts		1	1	1	1	1					
Photo developing baths		2	1						1		
Photo fixing baths		2	1						2		
Nickeling bath		2	1						1		2
Gasoline and water	1	1	1			1		1			1
Ammonium bicarbonate									1		
Sodium bicarbonate		3	3	1	4	2				1	
Calcium bisulfite			1	4	4	4					
Carbon bisulfite		1	1	1	1	4					
Chlorine dioxide		4	4		4	4					1
Beer								1	1		1
Wine lees fertiliser								2	1		3
Potassium bromide											
Butane			1	1	1						
Butanol, buticil alcohol				1	1	1					
Butyrolactone		1	1		2			3	3		3
Sodium carbonate								1	1		
Tar		1			1						
Kerosene		1	1	1	1	1					
Potassium cyanide								1	1		1
Pure actice chlorine (BATE)		2	2		2	2					1
Calcium chloride		2	3		2		2	1	1		1
Magnesium chloride	2	2	2					1	1		1
Potassium chloride								1	1		1
Sodium chloride		2	2		4	3		1	1		1
Hydrogen chloride											1
Ethyl chloride											2
Ammonium chloride		2	2	2	3	4				2	
Aluminium chloride		4	4	1	2	2					
Calcium chloride		3	3	2	1	1					
Nickel chloride		2	2	3		4					
Copper chloride		4	4	2	2	3					
Methyl chloride				1	1	1					
Zinc chloride		4	4	1	3	4					
Sulfur chloride			3	3	3	4					
Ferric chloride		4	4	4	4	4				4	
Stannous chloride		3	3	4	4	4				4	
Mercuric chloride		4	4	4	3	4				4	
Barium chloride		2	1							1	
Creosote, timber		1	1	1	1	1					
Liquid detergent									1		2
Dowtherm					1	4					
Hexane		1	1		1	1		1	4		1
Ethers				1	1	1					
Ethyl benzene		1	1		1	1					1
Ethyl cellulose				1						1	
Phenol											1
Phenol pentachloride		1	1		1	1					
Aluminium fluoride		3	3								
Formaldehyde		1	2		4		2		2		
Ferrious phosphates		1	1		2						1
Calcium phosphate		2	2					1	1		1
Trisodium phosphate			1	1	1	3				1	
Tribasic ammonium phosphate		1	1	1	1	2				1	
Furaldehyde		1	1	1	1	1					
Freon 111		1	1								2
Freon 113 (R113)	1	1	1		1	1		1			2
Freon 12		2	1		1			1	2		1
Blast furnace gas		3		3	1	4					
Carbon furnace gas			1	1	1	1					

LIQUID	Series 400	AISI304	AISI316	MONEL	CAST IRON	BRONZE	COPPER	NBR	EPDM	NICKEL	VITON
Natural gas		1	1	1	1	3					
Gasogene				1	1	3					
Diesel											1
White diesel	1	1	1		2			3	3		1
Glycerine								1	1		1
Diethylene glycol		1	1					1	1		1
Propylene glycol	1	1	1						1		
Triethylene glycol (Radiator fluid)	1	1	1						1		2
Glucose		1	1	1	1	1					
Calcium hydrate/hydroxide		1	1			1		1	1		1
Sodium hydroxide											
Potassium hydroxide		2	2	1	3	4				1	
Calcium hypochlorite		3	3	3	3	3					
Sodium hypochlorite		4	4	3	4	3				3	
Isocyanate											2
Kerosene		1	1		1	1		3	2		1
Aviation kerosene		1	1		1	1		3	2		1
Kerosene + foaming agents +H ₂ O		1	1		1						1
Varnishes		1	1	1	3	3					
Varnish solutions		1	1	1	3	3					
Lactate		1	2		3	3		1	1		1
Calcium lactate		2	1		2				1		
Methylene chloride		2	1		3						2
Mercury		1	1	1	1	4					
Sodium metaphosphate		1		1		3				1	
1-methyl-2-pyrrolidone	1	2	1		-	3	-	4	4		4
Ammonium nitrate		1	1	3	1	4					
Sodium nitrate		2	1	1	1	2				1	
Nitrobenzene			1		1	2					
Cutting oil + H ₂ O	1	1	1		1			3	3		1
Combustible oil		1		1	1	3					
Linseed oil		1	1		1			1	4		1
Castor oil		1		1	1						
Diathermic oil	1	1	1		1	4					1
Mineral oil	1	1	1		1						1
Oil SEA 10W30	1	1	1								1
Oil SEA 20W 50HD	1	1	1								1
Cerium oxide + water											
Carbon oxide warm		1	1		1	4					
Magnesium oxide		1	1	1	1	4				1	
Frozen oxygen		1	1	1	1	1					
Ozone + water											
P3 ferrosfos 8579 (Henkel)	1	1	1		1						1
Sodium perborate		1	1	1	3					1	
Perchloroethylene /ethyl		2	2			3					1
Percolate											
Hydrogen peroxide											1
Sodium peroxide		1	1	1	3					1	
Crude oil		1	1	3	1	3				3	
Polyol		1	1						1		2
Potassium nitrate											
Perfume		1	1						1		
Propane		1	1	1	1						
R ethanol (ethane)		1	1		1			2	1		2
Blood + water		1	1		1	1	1	1	1		1
Brine		1	1		3	1	1				
Pure liquid soap		1	1		4	4		2	1		2
Sodium silicate		1	1		1	1		1	1		1
Whey		1	1		4	-	-	4	4		1
Caustic soda + H ₂ O		2	1		2			1	1		2
Soda (5%) + nitric acid (5%)											
Sodium hypochlorite		3	2		4			2	2		1
Sodium sulfite		1	1					1	1		1
Ammonium sulfate		1	1	1	1	2					
Aluminium sulfate	2	1	1		4	2		1	1		1
Magnesium sulfate		1	1	1	1	1					
Calcium sulfate		1	1						1		
Ferrous sulfate		2	2		4				1		
Copper sulfate		2	2		4	3		1	1		1
Sodium sulfate		1	1	1	1	1				1	
Zinc sulfate		1	1	1	3	4					
Potassium sulfate		2	2	1	1	1				1	
Bicarbonate sulfate		1	1	2	1	4				2	
Barium sulfate		1	1	1		4					
Soap solutions		1		1	1	3					
Solvents with nitrus (explos.)		1	1		1			3	3		3
Concentrated orange juice								1	1		1
Tropical orange juice								1	1		1
Lemon juice											
Concentrated apple juice											
Concentrated cranberry juice											
Tomato juice											
Grapefruit juice								1	1		1
Concentrated grape juice											
Tensides + water		1	1								1
Tetrachlorethylene											
Carbon tetrachloride		3	3	1	3	3					
Aniline tincture		1		1							
Toluene				1	1						
Turpentine		1	1	1		3					
Triacetin + veg. Carbon		2	1			4			2		
Trichloroethylene		3	3	1	3	3					
Trichloroethane (solution)		1	1								1
Trieline/acetone/toluene		2	1		2			4	3		3
Trieline/ethylene trichloride		1	2		2			4	4		1
Triethyle amina		1	1					1	4		4
Urea									2		
Steam below 260 °C		1	1	1	1	1				1	
Steam from 260°C to 530°C		1	1	3	1	3				3	
Vaseline								1			1
White vaseline 206903											
Vaseline F3 Codex											
Wine	1	1	1		1	1		1	1		1
Vodka		1	1					2	1		3
Whiskey		1	1					1	1		1
Yoghurt								1			
Sulphur		2	2	4	1	4				4	
Sugar + Water 65° Brix		1	1					1	1		1

LEGEND

INDEX OF METAL RESISTANCE TO CORROSION

Class	Resistance
Corrosion	
1	optimum
2	sufficient
3	insufficient
4	poor



FE CONTI

Via Astabbio, 5
13018 Valduggia (VC)
Tel: +39 0163 487704
Fax: +39 0163 48107
info@contivalves.com
www.contivalves.com

BALL VALVE DIVISION
Via Gaudenzio Ferrari
13018 Valduggia (VC)

