

Tides, current and wind can have an effect on how your boat \_\_\_\_\_ while maneuvering. Hull \_\_\_\_\_ also has an effect on how you boat \_\_\_\_\_. (FILL IN THE BLANKS)

Tide tables provide a wide range of information about tides, including when high and low tides will occur and what high and low tides will be at a given location. (TRUE / FALSE)

List some of the ways to get weather information: (LIST)

---

---

---

---

---

List some of the things you should do if you are about to be caught in a thunderstorm: (LIST)

---

---

---

---

---

Thunderstorms generally move in what direction?

- a) From W to E
- b) From N to S
- c) From NW to SE
- d) From ESE to WNW

When experiencing foggy conditions it is usually best to hug the shore and head back to harbor rather than heading to an uncongested and deep area of water and waiting. (TRUE / FALSE)

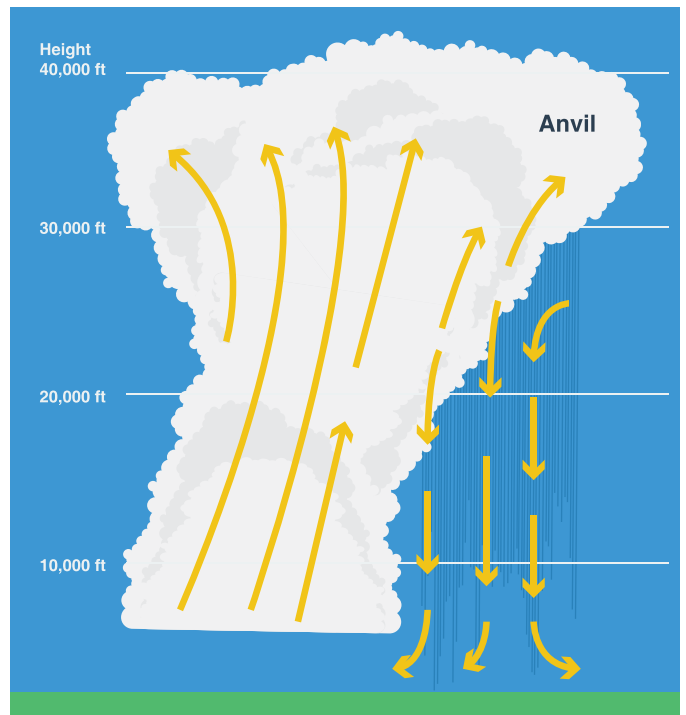

Lightning is usually accompanied by tall anvil shaped clouds called \_\_\_\_\_.  
(FILL IN THE BLANKS)

Lightning is unpredictable and very \_\_\_\_\_.

Define Small Craft Advisory: \_\_\_\_\_  
\_\_\_\_\_  
\_\_\_\_\_.

What are thru-hull fittings? \_\_\_\_\_  
\_\_\_\_\_. Think about where they are on your boat or on the boat you typically operate. Do you know where all of the fittings are and have you inspected them recently to know they are in good shape and will operate trouble-free? (YES / NO)

More boats sink at the \_\_\_\_\_ than they do in open \_\_\_\_\_.  
(FILL IN THE BLANK)

Think about the boat you typically operate and list five things you can do to prevent it from sinking. (LIST)

\_\_\_\_\_  
\_\_\_\_\_  
\_\_\_\_\_

When you store your boat for extended periods of time list some of the things you should do when you store it so you will have a hassle-free experience when the time comes to get going again.

\_\_\_\_\_  
\_\_\_\_\_  
\_\_\_\_\_



Check the items that are important in order to keep your fuel clean and your boat running trouble-free.

- \_\_\_\_\_ Install and maintain a fuel water filter
- \_\_\_\_\_ Keep fuel fill cap tightly closed and inspect O-ring
- \_\_\_\_\_ Use your boat often so you are always adding fresh fuel
- \_\_\_\_\_ Keep fuel lines, filters and tanks clean and replace if needed

According to safety experts, it is recommended that you not exceed what percent of a trailer's gross vehicle weight rating when loading your trailer? (SELECT)

- a) 50%
- b) 85%
- c) 100%
- d) 125%

The ideal tongue weight of a trailer should be approximately \_\_\_\_\_% of the total loaded weight. If the weight is too little it could cause the trailer to \_\_\_\_\_ and if the weight is too \_\_\_\_\_ the vehicle might be difficult to \_\_\_\_\_.

What is the purpose of safety chains and how should they be attached to the tow vehicle? \_\_\_\_\_

\_\_\_\_\_

\_\_\_\_\_

\_\_\_\_\_

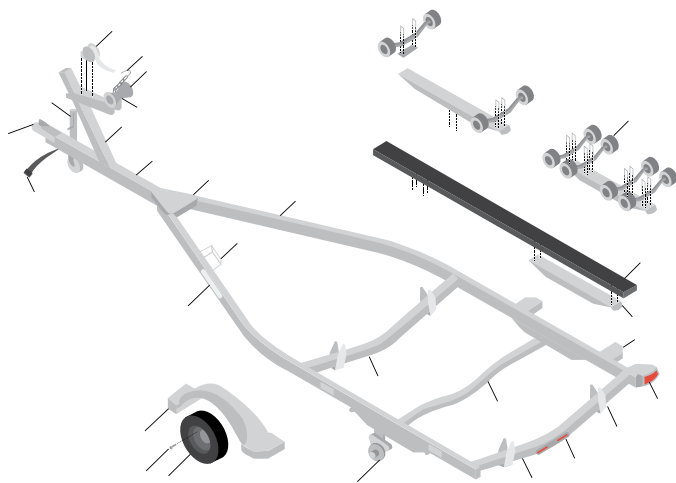

List at least 5 things that you should inspect on the boat trailer before making a trip. (LIST)

\_\_\_\_\_

\_\_\_\_\_

\_\_\_\_\_

\_\_\_\_\_

What does boat ramp etiquette mean to you? What will you do so that you're not "that guy" at the boat ramp? \_\_\_\_\_

\_\_\_\_\_

\_\_\_\_\_

\_\_\_\_\_

\_\_\_\_\_

\_\_\_\_\_

List and define at least one law regarding trailering that you didn't know before reading this chapter.

\_\_\_\_\_

\_\_\_\_\_

\_\_\_\_\_

Gasoline vapors are LIGHTER / HEAVIER than air and can accumulate in LOW / HIGH places INSIDE / OUTSIDE of the boat and you should always LISTEN / SNIFF for a dangerous situation. (CIRCLE).

Put the following refueling procedures in the proper order. (NUMBER in ORDER)

- \_\_\_\_\_ Do the sniff test
- \_\_\_\_\_ Open all ports, hatches and doors
- \_\_\_\_\_ Fill carefully and always hold nozzle
- \_\_\_\_\_ Extinguish all open flames
- \_\_\_\_\_ Re-board passengers
- \_\_\_\_\_ Turn off engine/s
- \_\_\_\_\_ Remove all passengers
- \_\_\_\_\_ Operate blower for at least 4 minutes
- \_\_\_\_\_ Start engines
- \_\_\_\_\_ Close all ports, hatches, and doors