

Cable Channel Covers

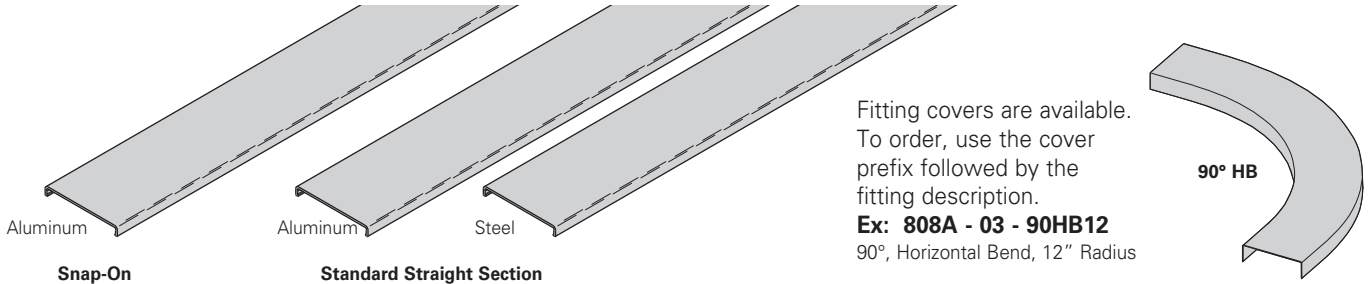

Covers Part Numbering

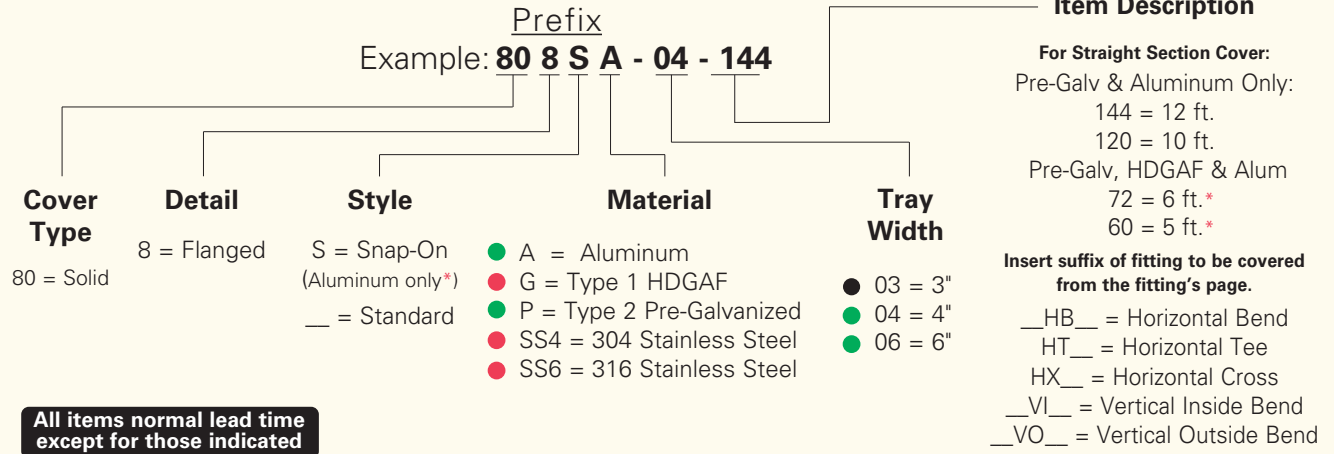

| Material | Length | | Channel Width - Straight Section Part Number | | |
|---|--------|-------|--|-------------|-------------|
| | ft | (m) | in. (mm) | in. (mm) | in. (mm) |
| ● Aluminum (.032) ● Solid | 12 | 3.56m | 3 (76) | 4 (101) | 6 (152) |
| | 10 | 3.05m | 808A-03-144 | 808A-04-144 | 808A-06-144 |
| ● Type II Pre-Galvanized Steel (20 Ga.) ● Solid | 12 | 3.56m | 808A-03-120 | 808A-04-120 | 808A-06-120 |
| | 10 | 3.05m | 808P-03-144 | 808P-04-144 | 808P-06-144 |
| ● Type I Hot Dip Galvanized Steel (18 Ga.) ● Solid | 12 | 3.56m | 808P-03-120 | 808P-04-120 | 808P-06-120 |
| | 10 | 3.05m | 808G-03-72 | 808G-04-72 | 808G-06-72 |
| | | | 808G-03-60 | 808G-04-60 | 808G-06-60 |

Wrap-Around Cover Clamp

Wrap-Around Cover Clamps are used to securely hold a cover on cable channel in locations where strong winds can prevail.

- Furnished as one clamp with hardware.
- (*) Insert **A G P SS4 SS6**

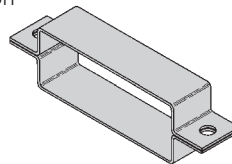

| Catalog No. | Channel Width |
|-------------|---------------|
| | in. (mm) |
| 9(*)-9033 | 3 (76) |
| 9(*)-9034 | 4 (101) |
| 9(*)-9036 | 6 (152) |

Combination Hold-Down & Cover Clamp

This clamp is used to hold both the cable channel and cover in place at the same time.

- Furnished as one clamp.
- Order 1/4" hardware separately.
- (*) Insert **A G P SS6**

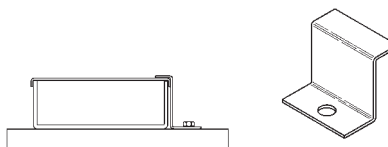

| Catalog No. | Channel Width |
|-------------|---------------|
| | in. (mm) |
| 9(*)-9023 | 3 (76) |
| 9(*)-9024 | 4 (101) |
| 9(*)-9024 | 6 (152) |

● Green = Fastest shipped items ● Black = Normal lead-time items ● Red = Normally long lead-time items

All dimensions in shaded areas are millimeters unless otherwise specified.