



Get a FREE Custom Message Board
 Talk about:

> [Buy CDs Now](#)
 > [Auctions](#)
 > [CreditReport](#)
 > [Free Web Site](#)

You are here: [About](#) > [Hobbies](#) > [Woodworking](#)



Woodworking

with [Larry Eastman](#) Your Guide to One of Over [700 Sites](#)

Search for

[Home](#) · [Recent Articles](#) · [Visit Forums](#) · [Chat Live](#) · [Contact Guide](#) · [Free Newsletter](#)

Subjects

[Adhesives/Glues](#)
[Antique Tools](#)
[Bandsaws](#)
[Conversion Charts](#)
[Education](#)
[Finishes](#)
[Free Catalogs](#)
[Hand/Power Tools](#)
[Kiln Drying](#)
[Machinery](#)
[Magazines](#)
[Museums/Galleries](#)
[Planers](#)
[Plans Index](#)
[Pneumatic Tools](#)
[Safety/Supplies](#)
[Sawmills](#)
[Software](#)
[Supplies](#)
[Tablesaws](#)
[Tips/Techniques](#)
[Tole Painting](#)
[TV Shows](#)
[Unfinished Items](#)
[Web Articles](#)
[Web Rings](#)
[Wooden Kits](#)
[Wood/Components](#)
[Woodworkers' Sites](#)
[Hardware](#)

[Subject Library](#)

[All articles on this topic](#)

Free Woodworking Plans

Whenever possible I locate free plans on the internet, and occasionally I draw some up that hopefully will be beneficial to you. On the following four pages you will find a list of both types of free plans.

We all would like to see more free plans available to us at a click of the mouse. There are many unique [plans available on the internet](#).

There are links to thousands of plans on this Woodworking site. More plans will be added on a regular basis. If you can't locate a plan at this time, please take advantage of this Woodworking.About.com's [Forum](#). Someone may see your posted question, and know exactly where you can find what your looking for, or perhaps you can help out another fellow woodworker, by answering a question they may have.

Free Plans From the Internet A-C

[Aldo Leopold Bench](#)

Wild Ones has a free bench plan that is made from 2" x 6", 2" x 8", and 2" x 10" material.

[Aquarium Table](#) new

An article that describes how to make a table that can support a 3' long fish tank. The table also includes a shelf underneath. Material list measurements are in millimeters.

[Artist's Easel](#)

Benjamin Grosser shows how to build a heavy duty easel with free drawings and instructions.

[Baby Changing Table](#)

Amateur Woodworker has instructions, and a

Related Sites

from About

[Architecture](#)
[Basketry](#)
[Decorative Arts](#)
[Folk Art](#)
[Forestry](#)
[Home Repair](#)
[Interior Decorating](#)
[Landscaping](#)
[Miniatures](#)
[Model Railroading](#)

Also Recommended

[Apply to become a partner for this site.](#)

Magazine Offer

[Click Here](#)

Advertising

[HotJobs](#)

Onward! Upward!

[win millions!!](#)

Just three easy steps can make you a millionaire!

[PrizeCrazy.com](#)

win a Mercedes or \$50,000

[Grolier Books](#)

4 FREE gifts-all new from Scooby-Doo!

Stay up-to-date!
Subscribe to our newsletter.

Want a free web site?
It's easy with new **About
SiteBuilder!**

Get your site now

Want to add search to your
site?

Link to Sprinks - and earn
money!

Become an Affiliate

Got a question?
Ask an Expert

material list for building a Baby Changing Table,
that can also be used as a chest of drawers.

Ball and Bat Rack

HouseNet has a full-sized building diagram and
instructions for a Ball and Bat Rack that is
designed for two bats and three balls.

Barrister Bookcases

Popular Woodworking magazine offers a free
download construction drawing in PDF format
of Barrister Bookcases.

Baseball Cap Rack

Minwax® has this page that has free assembly
diagrams, procedure information, tips, plus a
tools, and materials list in order to make a
Baseball Cap Rack.

Bathroom Vanity

Popular Mechanics has a free project plan,
materials list, plus instructions for a bathroom
vanity that starts on this page.

Bedroom Organizer

Minwax® has this page that has free assembly
diagrams, procedure information, tips, plus a
tools, and materials list in order to make a
Bedroom Organizer.

Bedside Table

Minwax® has this page that has free assembly
diagrams, procedure information, tips, plus a
tools, and materials list in order to make a
Bedside Table.

Bench

California Redwood Association has free plans
and step-by-step instructions for building a
Mendocino Bench.

Birdhouse 1 new

L & R Designs offers a free PDF download plan
to build a traditional 9 1/2" high x 8 1/2" wide x
10" deep birdhouse. All built from 1" x 6"
material.

Birdhouse 2

Johnathon Press Home and Workshop Online has
a free plan and instructions for a family project
for a birdhouse that kids could make.

The Bird Ornament Patterns

WoodCraft Projects has free full scale patterns of
various bird ornaments for a weekend wood/craft
hobbyist. Painting instructions are included.

Blanket Chest 1

August Home Publishing Co. has free plans and
descriptions to build a Country Classic Blanket



Marketplace

- [make great gifts](#)
- [hot pc deals!](#)
- [online casino\\$](#)
- [\\$5 off used music](#)
- [\\$\\$ play lotto \\$\\$](#)
- [need a desktop?](#)
- [tech shopping](#)
- [make cash online](#)
- [get free stuff!](#)
- [oldsmobile](#)
- [gambling @ home](#)

Chest.

Blanket Chest 2

Popular Mechanics has a free project plan, materials list, plus instructions for a blanket chest that starts on this page.

Bluebird House Plans

Here's an article that describes how to build a bluebird house, complete with step by step instructions.

Booklet With Weekend Projects

Minwax® will send you a free Easy Weekend Projects booklet just by simply filling out a request form.

Book/Magazine Stand

Popular Woodworking Magazine offers free instructions, a material list, and a downloadable construction drawing for building a tall book/magazine stand.

Bread Box

Amateur Woodworker offers a free plan and instructions for building a Bread Box. Tools required are a drill, sander, jigsaw, and router.

Build An Office Desk

Popular Mechanics has a free project plan, materials list, plus instructions for a office desk that starts on this page.

Building An Inexpensive Wine Rack

 from About.com

Your About Wine Guide Lisa Shea has very nice colored photos and free instructions for building a wine rack with plywood and PVC pipe.

Bungalow Mailbox

Popular Woodworking magazine offers a free download construction drawing in PDF format of a Bungalow Mailbox.

Byrdcliffe Cabinet

Popular Woodworking magazine offers a free download construction drawing in PDF format of a Byrdcliffe Cabinet.

A Cabinetmaker's Toolchest

Ralph Brendler offers his free basic plans and a description of a toolchest.

CD Carousel new

Freeplans.com™ offers a free detailed plan and instructions for building a CD Carousel that looks like it could hold somewhere around 96 CDs.

CD Holder

Minwax® has this page that has free assembly diagrams, procedure information, tips, plus a tools, and materials list in order to make a CD Holder.

Chattahoochee Chair

Wolmanized® offers this page with material list, and detailed plan.

Classic Winter Sled

Drawings, instructions, material and hardware lists are included on this page to build a Classic Winter Sled that is just under four feet long, and it can be built with common tools.

Coffee Table

Popular Mechanics offers free instructions and photos for building a knock down Coffee Table that looks similar to a trestle table.

Computer Desk

Instructions and a cutting diagram for making a Computer Desk or Study Carrel from a single sheet of plywood.

Computer Desk, and More

Black & Decker has free project instructions, and detailed plans on how-to build an Adirondack Chair, Computer Desk, Indoor Firewood Rack, and an Outdoor Wood Organizer.

Corner Cabinet

Jeff Greef Woodworking supplies detailed instructions and photos for building a small wall mounted Corner Cabinet.

Corner Cupboard

Popular Mechanics offers detailed two part plans, with details on how-to do the case construction, doors, and trim, plus a materials list.

Continue

Free Plans From The Internet D-P

Continue on to a list of more free plans from the internet.

Free Plans From The Internet Q-Z

Continue on to a list of more free plans from the internet.

Free Plans From Your Woodworking Guide

Continue on to another list of links to free plans, drawn up by your Woodworking Guide.

Visit the **Woodworking Forums** to browse as a

guest, or register for free and post.

Bookmark
Woodworking.About.com
Thank You



Subscribe to The Woodworking Newsletter

Name

Email

Just One Click!

Please take a moment and click here.
It will help to keep Woodworking.About.com noticed.
Thank you!

Previous Features

Email this page!

Sponsored Links

Find Books About Woodworking at Half.com

Free \$5 on your first purchase and Get up to 50-90% off everyday! Buy and Sell previously owned Books, CDs, DVDs, Movies and Video Games.

<http://www.half.com/> (Listing fee: \$0.28)

Eagle Creek Custom Etched

Laser engraved and sand carved personalized gifts and awards for animal lovers. Let us transfer your ranch brand, logo, or photo of your special animal onto a lasting "treasure".

<http://www.custom-etched.com/> (Listing fee: \$0.18)

NBAF: Magazine Subscriptions

Best price or we pay you! hundreds of popular magazine subscriptions on every topic and interest.

<http://nbaf.com/> (Listing fee: \$0.09)

NorthernTool

Visit NorthernTool and find power tools, air tools, hand tools, hydraulics, lawn and garden, hunting and handyman products.

<http://www.northerntool-1.com/> (Listing fee: \$0.08)

[StreetFairAmerica.com](http://www.streetfairamerica.com/)

Buy and sell crafts. Free! StreetFairAmerica is the marketplace for crafts, handmade products. Sellers register online. Free setup and no monthly fees. Buyers can browse over 600 handmade items.

<http://www.streetfairamerica.com/> (Listing fee: \$0.06)

[More...](#)

[Buy a Link Now!](#)

ezboard 6.0 **Get a FREE Custom Message Board**
 Talk about:



Explore More on the About Network!

- | | | | |
|--------------------------------------|-----------------------------------|---------------------------------------|---------------------------------------|
| About Australia | Cultures | Internet/Online | Real Estate |
| About Canada | Education | Kids | Religion/Spirituality |
| About India | Food/Drink | Jobs/Careers | Science |
| About Ireland | Finance/Investing | Money | Shopping |
| About UK | Gadgets | Movies | Small Business |
| All About Japan | Games | Music/Performing Arts | Sports |
| Arts/Literature | Health/Fitness | News/Issues | Style |
| Autos | Hobbies | Parenting/Family | Teens |
| Cities/Towns | Home/Garden | People/Relationships | Travel |
| Comedy | Homework Help | Pets | TV/Radio |
| Computing/Technology | Industry | Recreation/Outdoors | |

[About Us](#) | [User Agreement](#) | [Privacy & Kids' Privacy Policy](#) | [Help](#)

Copyright © 2001 About.com, Inc. About and About.com are registered trademarks of About.com, Inc. The About logo is a trademark of About.com, Inc. All rights reserved.



August Home Publishing Company

Oops! We've made some changes in our web page addresses.
Looks like you've got a link to an "old" address.

Please find the page you're looking for by clicking on one of the links below. And then bookmark the new page. **Thanks.**



Woodsmith

[Subscription Info](#)

ShopNotes

[Cutting Diagrams](#)

[Subscription Info](#)

WORKBENCH

[Cutting Diagrams](#)

[Subscription Info](#)

[WB Interactive](#)

WoodNet

[Woodworking Forums](#)

[Weekly E-mail Tips](#)

[101+ Tips & Techniques](#)

[Tool Reviews](#)

[WoodworkingTips.com](#)

[WorkbenchPlans.com](#)

GardenGate

[GardenGateTours.com](#)

[Weekly E-Tips](#)

[Basics](#)

[Design](#)

[Projects](#)

[Plants](#)

[Gardening Forums](#)

[Subscription Info](#)

Cuisine^{at home.}

[CuisineCam.com](#)

[Weekly E-Recipes](#)

[Cooking Forums](#)

[Recipes](#)

[Cooking Tips](#)

[Subscription Info](#)

Our Ecommerce Stores





[August Home Tours](#)

[Woodsmith Tours](#)

[Garden Gate Tours](#)

[Cuisine Travel](#)

[Home](#) | [About August Home Publishing](#) | [Woodsmith Retail Store](#)
[Job Opportunities](#) | [Advertise on this Site](#) | [Contact Us](#)

© August Home Publishing Company
All Rights Reserved.



- Back to the Topic Site
- Turn off this top frame

- > [House](#)
- > [Get Crafty](#)
- > [Decorate](#)



- [Back to the Topic Site](#)
- [Turn off this top frame](#)



WOODWORKING



- FORUMS
- 101 TIPS
- TOOL REVIEWS
- WOOD LINKS
- STORE
- PLANS
- PROJECT SUPPLIES

- Woodsmith
- ShopNotes
- WORKBENCH

FREE TIPS by Email
Click here to sign up!



Visit our other
August Home
Magazines

Woodworking Forums

[register](#) | [login](#) | [browse](#)

REGISTER

Register as a new member of the WoodNet forums.

LOGIN

Login if you are already a registered member of WoodNet.

BROWSE

Browse the forums. (You will not be able to post messages until you register as a member of WoodNet.)

Need Help? [Contact Us](#)

Workbench Plans
click here
Plans NOW

Woodsmith click here
ShopNotes
Workbench
Looking for Back Issues?
BackIssueStore.com

CLICK HERE
Woodsmith Store.

PLUS...
6 bonus plans
on one easy CD!

on one
easy-to-use
CD!

EXTRUSIONS
UNLIMITED
extrusionsinc.com

[Advertise on this site](#)

© 2003 August Home Publishing Company
[Terms of Use](#) - [Privacy Policy](#) - [Contact Us](#)

Special Offer!



Click Here!



- WoodNET
- FORUMS
- 101 TIPS
- TOOL REVIEWS
- WOOD LINKS
- CUTTING DIAGRAMS
- DESIGN OPTIONS
- PLANS
- KITS & SUPPLIES
- BACK ISSUES
- FREE** PREVIEW ISSUE
- SUBSCRIBE
- RENEW
- GIVE A GIFT**
- SUBSCRIBER SERVICES

ShopNotes®

Helping You Get the Most Out of Your Shop



[Current Issue No.72](#)

[Look Inside! - Click Here](#)

- ▶ Fold-Down Workstation
- ▶ Drill Press Belt Sander
- ▶ Removing Rust with Electrolysis
- ▶ Building a Laminated Benchtop
- ▶ Modular Outfeed System

 [Online Extras - Click Here](#)



[Click Here!](#)

FREE TIPS by Email
Click here to sign up!

IN THE SHOP



Dial Indicator

Fine tune your machinery and woodworking by adding a dial indicator to your tools.

IN THE SHOP



Jig Saw Blades

Boost the performance of your jig saw by choosing the right blade.

© 2003 [August Home Publishing Company](#)
[Terms of Use](#) - [Privacy Policy](#) - [Contact Us](#)



WOODWORKING

WoodNET

FORUMS

101 TIPS

TOOL REVIEWS

WOOD LINKS

CUTTING
DIAGRAMS

DESIGN OPTIONS

PLANS

KITS & SUPPLIES

BACK ISSUES

SUBSCRIBE

RENEW

SUBSCRIBER
SERVICES

ShopNotes®

Cutting Diagrams

These are **cutting diagrams** from *ShopNotes* magazine. The full plans with step-by-step instructions can be found in past *ShopNotes* magazine issues, which can be purchased at our [Back Issues Store](#).

Note: You'll need *Adobe Acrobat Reader* installed on your computer to view and print these cutting diagrams.



[Download FREE Acrobat Reader](#) from Adobe.

Instructions

- ▶ To **view and print** a cutting diagram, click on a project photo below.
 - ▶ To **save** a cutting diagram to your computer, right-click on a project photo below and select "save target as" or "save link as."
- (Note: Mac users with a **single-button mouse**, click and hold to get the "save" option).

Cutting Diagrams



[Fold-Down Workstation](#)

From [ShopNotes #72](#)

File size: 139k



[Shop-Built Gear Box](#)

From [ShopNotes #70](#)

File size: 60k

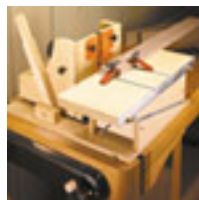

[Horizontal Mortising Machine](#)

From [ShopNotes #68](#)

File size: 55k



[Roll-Around Shop Cart](#)

From [ShopNotes #68](#)

File size: 121k

Project Kits
ON THE WEB



AUGUST HOME

[Visit our other
August Home
magazines](#)

Get Acrobat®
Reader



Mini Lathe Stand

From [ShopNotes #67](#)

File size: 173k



Table Saw Workstation

From [ShopNotes #66](#)

File size: 58k



Heavy Duty Workbench

From [ShopNotes #65](#)

File size: 54k



Adjustable V-Block System

From [ShopNotes #65](#)

File size: 47k



Hardware Storage Cabinet

From [ShopNotes #64](#)

File size: 91k



Plunge Router Mortising Jig

From [ShopNotes #64](#)

File size: 59k



Router Storage System

From [ShopNotes #63](#)

File size: 41k



Carpenter's Toolbox (with rabbet joints)

From [ShopNotes #62](#)

File size: 148k



Clamping Station

From [ShopNotes #62](#)

File size: 37k



Adjustable-Height Assembly Table

From [ShopNotes #60](#)

File size: 47k



Modular Shop Cabinets

From [ShopNotes #59](#)

File size: 69k



Sliding-Door Wall Cabinets

From [ShopNotes #59](#)

File size: 45k



Cordless Tool Storage

From [ShopNotes #58](#)

File size: 37k



Drill Press Table & Fence

From [ShopNotes #57](#)

File size: 39k



Roll-Around Store-All

From [ShopNotes #55](#)

File size: 33k



Roll-Around Tool Cart

From [ShopNotes #54](#)

File size: 51k



Table Saw Cabinet

From [ShopNotes #50](#)

File size: 126k

▶ To [ShopNotes](#) Home Page

ShopNotes Cutting Diagram

Table Saw Cabinets

Materials - Table Saw Cabinets

Table Saw Cabinet

A	Front/Back Panels (2)	14 $\frac{1}{4}$ x 23 - $\frac{3}{4}$ Ply.
B	Corner Strips (4)	$\frac{3}{4}$ x 1 $\frac{1}{2}$ - 23 Maple
C	Left Side (1)	19 $\frac{1}{4}$ x 16 - $\frac{3}{4}$ Ply.
D	Right Side (1)	19 $\frac{1}{4}$ x 23 - $\frac{3}{4}$ Ply.
E	Bottom (1)	15 $\frac{3}{4}$ x 18 $\frac{3}{4}$ - $\frac{3}{4}$ Ply.
F	Lower Rail (1)	$\frac{3}{4}$ x 3 - 19 $\frac{1}{4}$ Maple
G	Cleats (2)	$\frac{3}{4}$ x $\frac{3}{4}$ - 18 $\frac{3}{4}$ Maple
H	Stiles (2)	$\frac{3}{4}$ x 3 - 14 $\frac{3}{4}$ Maple
I	Rails (2)	$\frac{3}{4}$ x 3 - 16 $\frac{3}{4}$ Maple
J	Baffles (2)	11 x 18 $\frac{3}{4}$ - $\frac{3}{4}$ Ply.
K	Support Strips (4)	$\frac{3}{4}$ x $\frac{3}{4}$ - 9 $\frac{3}{4}$ Maple

Storage Cabinet

L	Back Panels (2)	17 $\frac{1}{2}$ x 23 - $\frac{3}{4}$ Ply.
M	Corner Strips (8)	$\frac{3}{4}$ x 1 $\frac{1}{2}$ - 23 Maple
N	Narrow Rail (4)	$\frac{3}{4}$ x 1 - 17 $\frac{1}{2}$ Maple
O	Bottom Rail (1)	$\frac{3}{4}$ x 4 - 17 $\frac{1}{2}$ Maple
P	Wide Rail (1)	$\frac{3}{4}$ x 7 $\frac{3}{4}$ - 17 $\frac{1}{2}$ Maple
Q	Side (3)	19 $\frac{1}{4}$ x 23 - $\frac{3}{4}$ Ply.
R	Right Side (1)	19 $\frac{1}{4}$ x 16 - $\frac{3}{4}$ Ply.
S	Lower Rail (1)	$\frac{3}{4}$ x 3 - 19 $\frac{1}{4}$ Maple
T	Bottom (2)	18 $\frac{3}{4}$ x 19 - $\frac{3}{4}$ Ply.
U	Stiles (4)	$\frac{3}{4}$ x 3 - 14 $\frac{3}{4}$ Maple
V	Rails (4)	$\frac{3}{4}$ x 3 - 20 Maple
W	Top Panel (2)	14 $\frac{1}{2}$ x 14 $\frac{3}{4}$ - $\frac{3}{4}$ Ply.
X	Cleats (4)	$\frac{3}{4}$ x $\frac{3}{4}$ - 18 $\frac{3}{4}$ Maple
Y	Side Apron (2)	$\frac{3}{4}$ x 3 - 20 $\frac{1}{4}$ Maple
Z	Front/Back Apron (2)	$\frac{3}{4}$ x 3 - 58 $\frac{1}{4}$ Maple

Caster System

AA	Caster Blocks (2)	1 $\frac{1}{2}$ x 6 - 18 $\frac{3}{4}$ Maple
BB	Lever Arms (2)	$\frac{3}{4}$ x 3 - 13 Maple
CC	Keeper Blocks (2)	1 $\frac{1}{2}$ x 1 $\frac{3}{4}$ - 5 Maple

Drawers

DD	Fronts/Backs (2)	$\frac{1}{2}$ x 3 - 15 $\frac{1}{2}$ Maple
EE	Sides (2)	$\frac{1}{2}$ x 3 - 18 Maple
FF	Fronts/Backs (6)	$\frac{1}{2}$ x 7 $\frac{1}{2}$ - 15 $\frac{1}{2}$ Maple
GG	Sides (6)	$\frac{1}{2}$ x 7 $\frac{1}{2}$ - 18 Maple
HH	Bottoms (4)	15 $\frac{1}{2}$ x 17 $\frac{1}{2}$ - $\frac{1}{4}$ Hardboard
II	Spacers (8)	$\frac{3}{4}$ x 1 $\frac{1}{2}$ - 18 $\frac{3}{4}$ Maple
JJ	False Front (1)	2 $\frac{3}{4}$ x 16 $\frac{1}{2}$ - $\frac{3}{4}$ Ply.
KK	False Front (2)	8 x 16 $\frac{1}{2}$ - $\frac{3}{4}$ Ply.
LL	False Front (1)	9 $\frac{1}{2}$ x 16 $\frac{1}{2}$ - $\frac{3}{4}$ Ply.
MM	Edging	$\frac{1}{2}$ x $\frac{3}{4}$ - 18 Lin. Feet

$\frac{3}{4}$ x 48 x 96 Maple Plywood

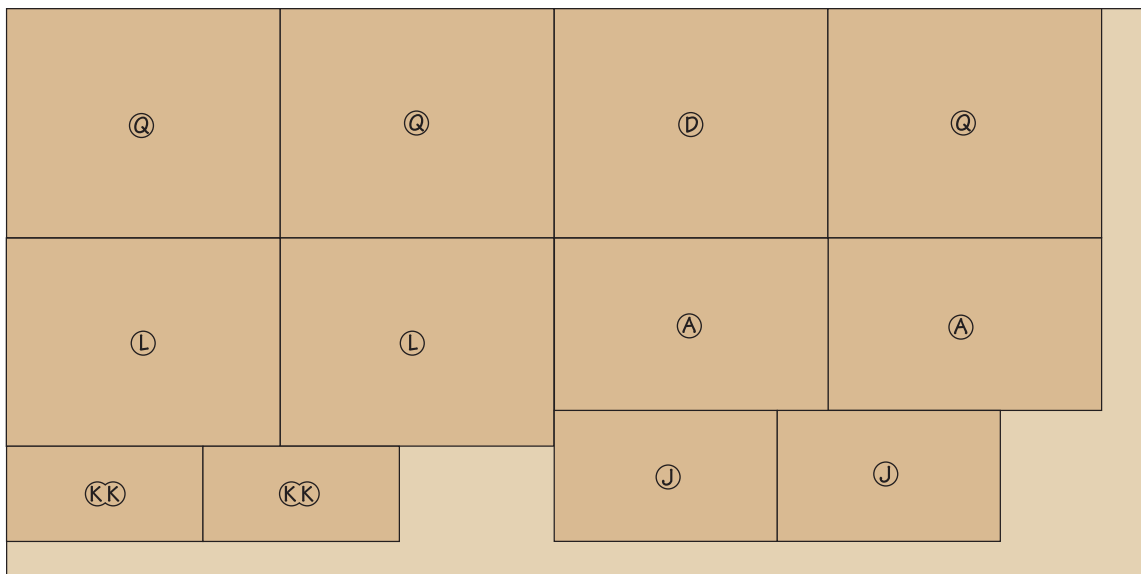

3/4 x 48 x 58 Maple Plywood

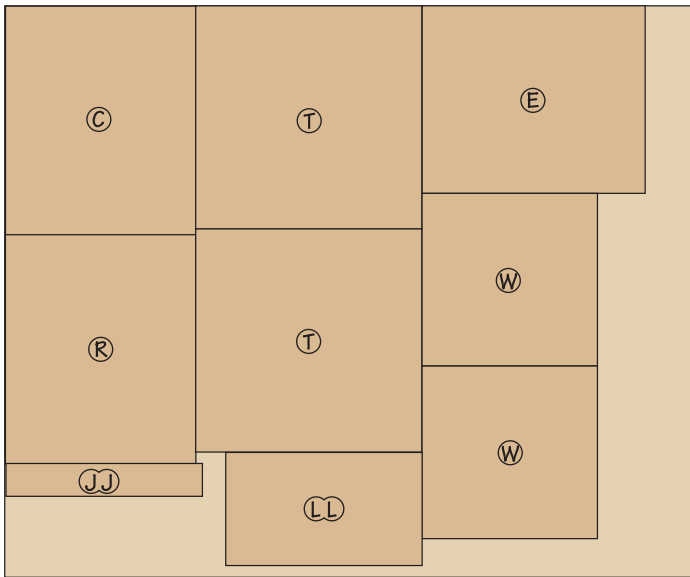

1/4 x 48 x 48 Hardboard

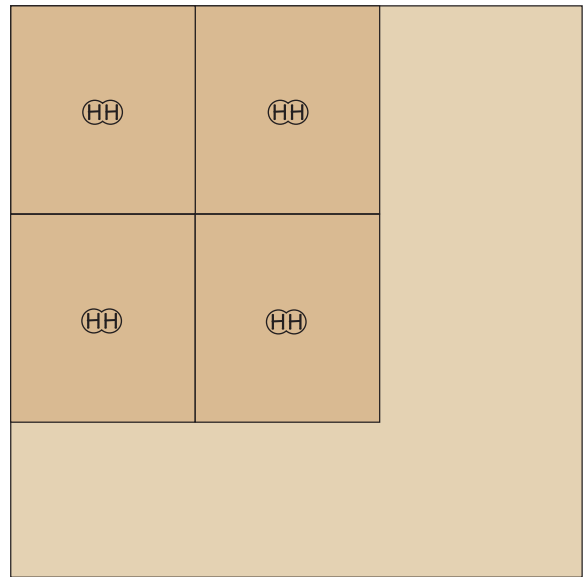

1/2 x 8 - 96 Maple



1/2 x 8 - 96 Maple (Two Boards)



3/4 x 8 1/2 - 96 Maple

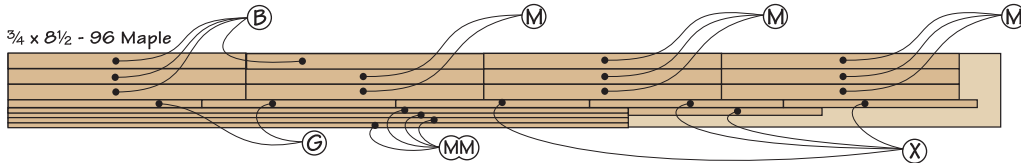

3/4 x 6 1/2 - 96 Maple (Two Boards)

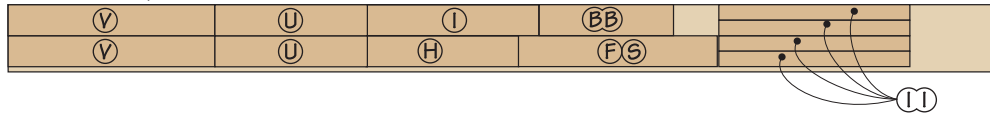

3/4 x 9 3/4 - 96 Maple

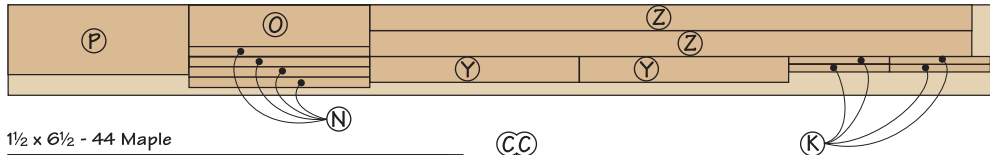

1 1/2 x 6 1/2 - 44 Maple



Table Saw Workstation

Materials

A Side Rails (4)	$\frac{3}{4}$ x 2 $\frac{1}{2}$ - 17 $\frac{1}{2}$	Q Side Stiles (4)	$\frac{3}{4}$ x 2 $\frac{1}{2}$ - 30
B Side Stiles (4)	$\frac{3}{4}$ x 2 $\frac{1}{2}$ - 16 $\frac{7}{8}$	R Side Panels (2)	22 $\frac{1}{2}$ x 25 $\frac{1}{2}$ - $\frac{1}{2}$ Ply.
C Side Panels (2)	17 $\frac{1}{2}$ x 12 $\frac{3}{8}$ - $\frac{1}{2}$ Ply.	S Subtop/Bottom (1)	26 x 26 - $\frac{3}{4}$ Ply.
D Back Rails (2)	$\frac{3}{4}$ x 2 $\frac{1}{2}$ - 21 $\frac{5}{8}$	T Front/Back Stiles (4)	$\frac{3}{4}$ x 2 $\frac{1}{2}$ - 30
E Back Stiles (2)	$\frac{3}{4}$ x 2 $\frac{1}{2}$ - 16 $\frac{7}{8}$	U Front/Back Rails (3)	$\frac{3}{4}$ x 1 $\frac{1}{2}$ - 21 $\frac{1}{8}$
F Back Panel (1)	21 $\frac{5}{8}$ x 12 $\frac{3}{8}$ - $\frac{1}{2}$ Ply.	V Door (1)	19 $\frac{3}{8}$ x 26 $\frac{7}{8}$ - $\frac{3}{4}$ Ply.
G Subtop/Bottom (2)	21 $\frac{1}{2}$ x 26 - $\frac{3}{4}$ Ply.	W Edging	$\frac{3}{4}$ x $\frac{3}{4}$ - 9 Ln. Ft.
H Lower Rail (1)	$\frac{3}{4}$ x 2 $\frac{1}{2}$ - 27	X Door Stop (1)	$\frac{3}{4}$ x 2 $\frac{3}{4}$ - 28 $\frac{1}{2}$
I Top (1)	21 $\frac{3}{4}$ x 26 $\frac{1}{2}$ - $\frac{3}{4}$ Ply.	Y Outfeed Top (1)	26 $\frac{1}{2}$ x 38 $\frac{1}{2}$ - $\frac{3}{4}$ Ply.
J Edging	$\frac{3}{4}$ x $\frac{3}{4}$ - 9 Ln. Ft.	Z Edging	$\frac{3}{4}$ x $\frac{3}{4}$ - 12 Ln. Ft.
K Fronts/Backs (4)	$\frac{3}{4}$ x 5 $\frac{1}{2}$ - 24	AA Access Plate (1)	16 x 16 - $\frac{3}{4}$ Ply.
L Sides (4)	$\frac{3}{4}$ x 5 $\frac{1}{2}$ - 20	BB Pads (4)	(Custom size to fit tablesaw)
M Bottoms (2)	19 $\frac{1}{2}$ x 24 - $\frac{1}{4}$ Ply.	CC Base	6 $\frac{1}{4}$ x 32 - $\frac{3}{4}$ Ply.
N False Fronts (2)	5 $\frac{1}{2}$ x 25 $\frac{1}{2}$ - $\frac{3}{4}$ Ply.	DD Face	5 x 32 - $\frac{1}{2}$ Ply.
O Edging	$\frac{3}{4}$ x $\frac{3}{4}$ - 11 Ln. Ft.	EE Braces	3 $\frac{1}{2}$ x 3 $\frac{1}{2}$ - $\frac{1}{2}$ Ply.
P Side Rails (4)	$\frac{3}{4}$ x 2 $\frac{1}{2}$ - 22 $\frac{1}{2}$	FF Cover	5 x 5 $\frac{15}{16}$ - $\frac{1}{2}$ Ply.

$\frac{3}{4}$ " x 6" x 96"



$\frac{3}{4}$ " x 6" x 96"

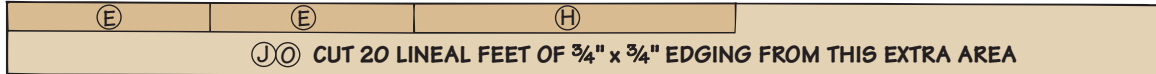

$\frac{1}{2}$ " x 6" x 96" (TWO BOARDS)



$\frac{3}{4}$ " x 6" x 96"



$\frac{3}{4}$ " x 6" x 96"



$\frac{3}{4}$ " x 8" x 96"



48" x 96" - 1/2" PLYWOOD

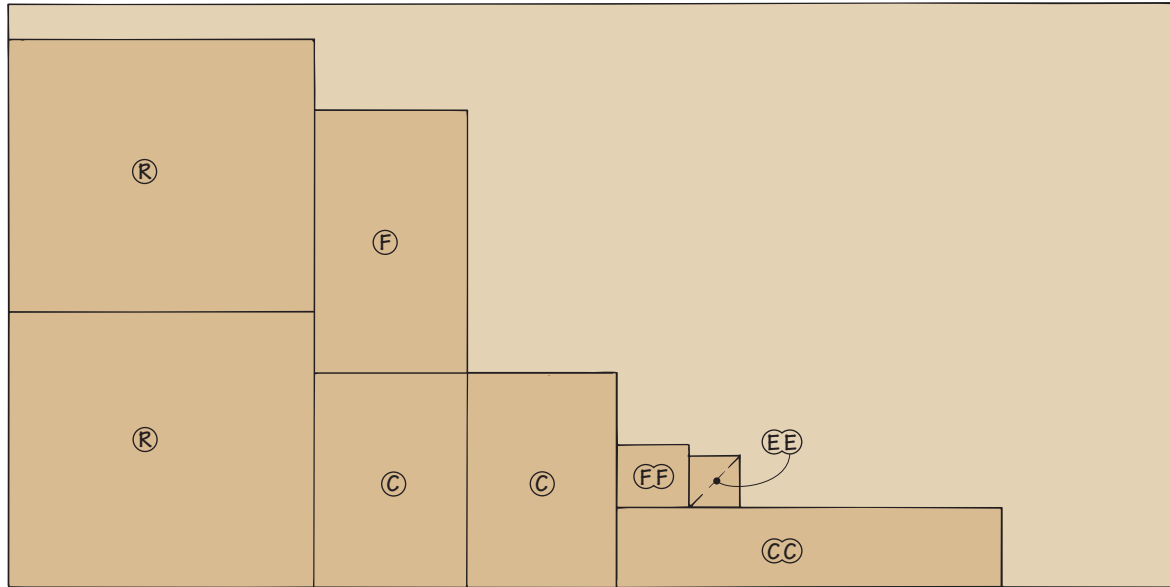

48" x 96" - 3/4" PLYWOOD

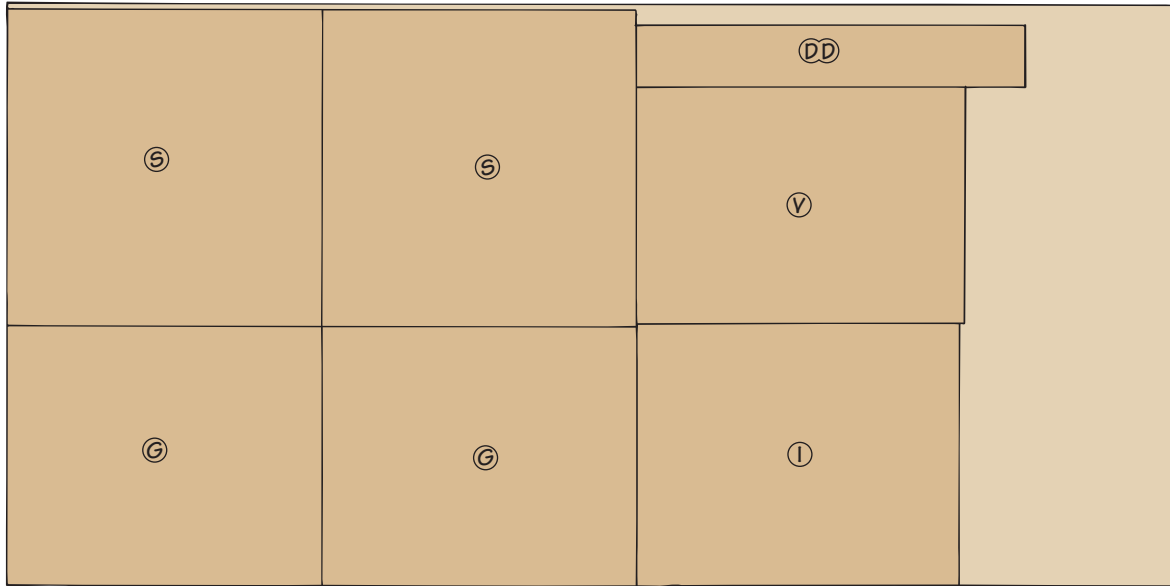

48" x 96" - 3/4" PLYWOOD

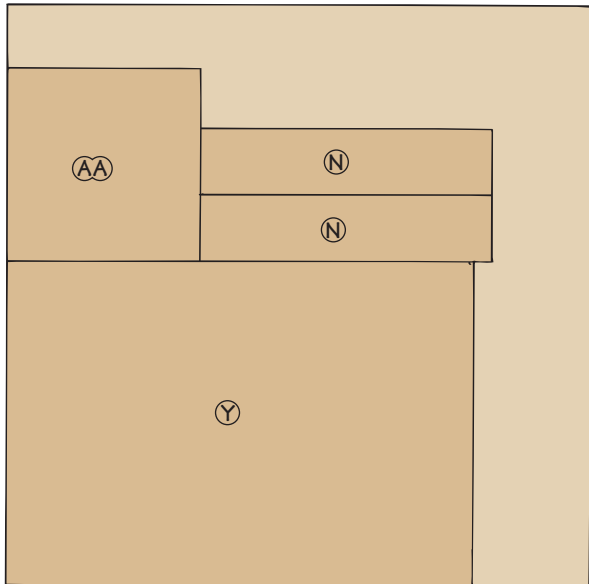

24" x 48" - 1/4" PLYWOOD

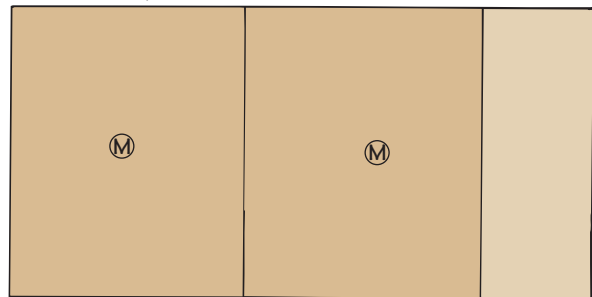

Roll-Around Shop Cart

Materials

Cart

A Stiles (4)	$1\frac{1}{2} \times 3\frac{1}{2} - 23$
B Center/Bottom Rails (4)	$1\frac{1}{2} \times 3\frac{1}{2} - 22$
C Upper Rails (2)	$1\frac{1}{2} \times 1\frac{1}{2} - 22$
D Side Panels (2)	$7\frac{1}{2} \times 22 - \frac{3}{4}$ MDF
E Filler Strips (4)	$1\frac{1}{2} \times \frac{3}{4} - 8$
F Shelf/Bottom Panel (2)	$19 \times 26\frac{1}{2} - \frac{3}{4}$ MDF
G Edging	$\frac{3}{4} \times \frac{3}{4} - 25$ Ln. Ft.
H Divider (1)	$12\frac{3}{4} \times 19\frac{3}{4} - \frac{3}{4}$ MDF
I Top (1)	$22 \times 30\frac{1}{2} - \frac{3}{4}$ MDF
J Cleats (3)	$1\frac{1}{2} \times 1\frac{1}{2} - 19$
K Caster Plates (2)	$\frac{3}{4} \times 3\frac{1}{2} - 22$

Drawers

L Small Drawer Front/Back (2)	$\frac{1}{2} \times 3\frac{1}{2} - 17\frac{1}{2}$
M Small Drawer Sides (2)	$\frac{1}{2} \times 3\frac{1}{2} - 20$
N Large Drawer Front/Back (2)	$\frac{1}{2} \times 7\frac{1}{2} - 17\frac{1}{2}$
O Large Drawer Sides (2)	$\frac{1}{2} \times 7\frac{1}{2} - 20$
P Drawer Bottoms (2)	$17\frac{1}{2} \times 19\frac{1}{2} - \frac{1}{4}$ Ply.
Q Spacers (2)	$\frac{3}{8} \times 1\frac{1}{4} - 17\frac{1}{8}$
R Small Drawer False Front (1)	$\frac{3}{4} \times 4\frac{3}{16} - 19\frac{1}{2}$
S Large Drawer False Front (1)	$\frac{3}{4} \times 8\frac{3}{16} - 19\frac{1}{2}$
T Cubby Front (1)	$\frac{3}{4} \times 3\frac{1}{8} - 19\frac{3}{4}$

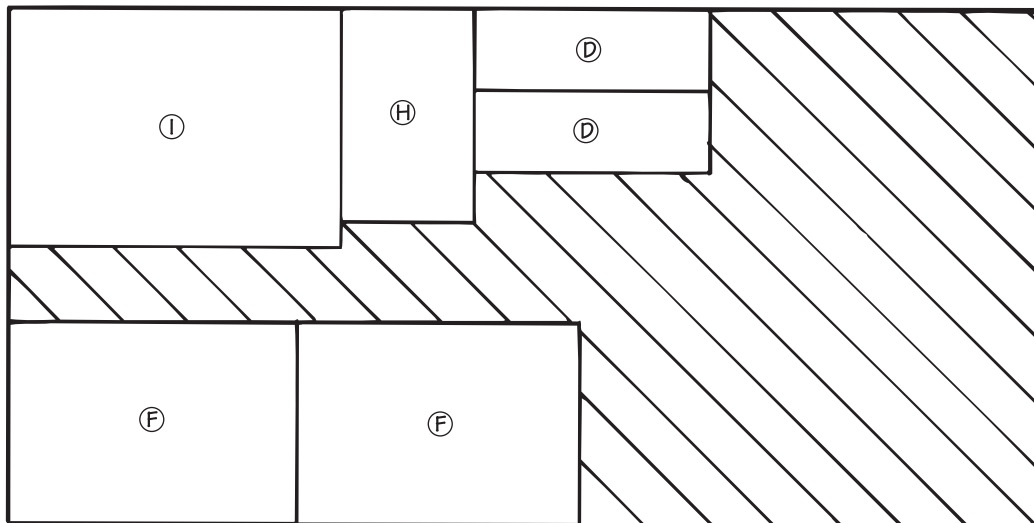

49" x 97" - $\frac{3}{4}$ " MDF

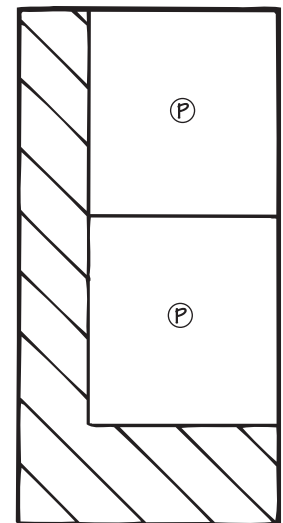

24" x 48" - $\frac{1}{4}$ " PLYWOOD

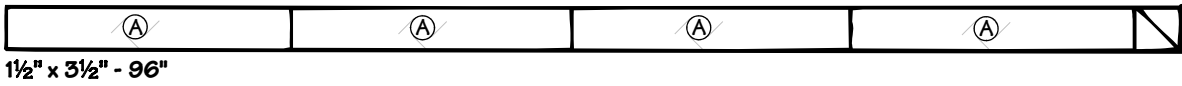

1 1/2" x 3 1/2" - 96"



1 1/2" x 3 1/2" - 96"

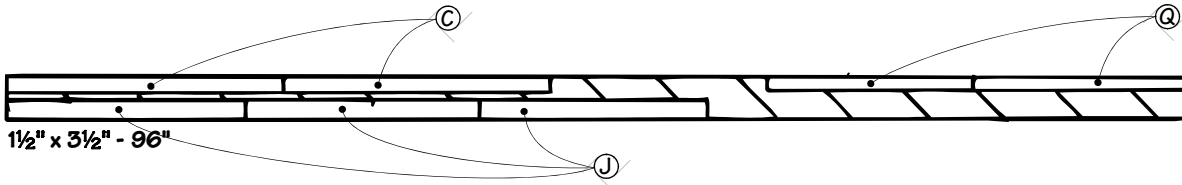

1 1/2" x 3 1/2" - 96"

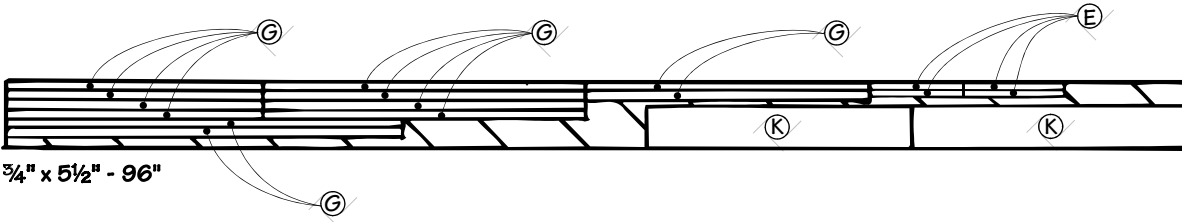

3/4" x 5 1/2" - 96"



3/4" x 5 1/2" - 96"



1/2" x 5 1/2" - 96"



1/2" x 5 1/2" - 96" (2 Boards)



Woodworking

with [Lew Soloway](#)

Your Guide to one of [hundreds of sites](#)

This page sponsored by



[Home](#) · [Articles](#) · [Forums](#) · [Chat](#) · [Newsletters](#) · [Help](#)

Subjects

ESSENTIALS

· [About Woodworking](#)

Glossary

· [A Beginner's Hand](#)

Tools List

· [How to Prepare](#)

Lumber for Projects

· [How to Choose](#)

[Sandpaper - Part 1](#)

· [How to Choose](#)

[Sandpaper - Part 2](#)

WOODWORKING

OFFERS

· [Workbench Plans](#)

· [Woodworking](#)

Machinery

· [Delta Woodworking](#)

Tools

· [Woodworking Tools](#)

· [Dewalt Tools](#)

[Dust Collection](#)

[Events](#)

[Finishing](#)

[Furniture Styles](#)

[Glossaries](#)

[Hand Tools](#)

[Joinery](#)

[Lumber](#)

In The Spotlight

WOOD Online is offering Free Sleigh Coffee Table Plan

WOOD Online is offering a free Yuletide Sleigh Coffee Table plan. The sleigh coffee table includes bent-wood laminations. The plan comes with detailed instructions, cut lists, and diagrams to take you through the entire process. This project will develop new skills and give you have a beautiful table to boot!

Click [here](#) to register for a free *WOOD Online* e-mail subscription and download the plan. While you are there you can also enter for the November tool giveaway of a Delta 14inch bandsaw with an enclosed base.

[Monday November 24, 2003](#) #

Rockler is having a big Thanksgiving Weekend Sale

While there are no woodworking shows in the U.S. this weekend, Rockler is having a big Thanksgiving Weekend Sale. From Friday, November 28th, through Sunday, November 30th, enjoy all the big savings they have to offer. There are early bird specials from 7am to 11am, each day. Take 25 percent off any one item except power tools. Take \$10 off any power tool. Also, Rockler is giving away free rubber band clamp sets while quantities last. Click [here](#) to find out more.

[Monday November 24, 2003](#) #

Chris Pye's Woodcarving Newsletter on the Web

Chris Pye, a noted English woodcarver and author, publishes a monthly newsletter that he e-mails to subscribers. The November issue includes discussion on carving chisel numbering systems, flat gouges, v-tools, cutting up trees for carving, bandsaws, and offers his famous **Green Man** for sale. He also offers downloads, articles, and links to various sites. To subscribe to the monthly e-zine, go to his wonderful website by clicking [here](#).

[Monday November 17, 2003](#) #

- [Old Tools](#)
- [Project Design](#)
- [Project Plans](#)
- [Power Tools](#)
- [Product Reviews](#)
- [Sharpening](#)
- [Shop Safety](#)
- [Training](#)
- [Woodcarving](#)
- [Woodturning](#)
- [Sources-Finishing](#)
- [Sources-General](#)
- [Sources-Hand Tools](#)
- [Sources-Power Tool](#)
- [Sources-Sharpening](#)

[Subject Library](#)

[All articles on this topic](#)

Woodworker's Journal Has Free Shaker Lap Desk & Miter Clamping Jig Plans

Woodworker's Journal Magazine is offering two new free plans for subscribers of their ezine newsletter in the first half of November. The first plan is for a shaker lap desk which continues the magazine's efforts to present authentic designs from the Hancock Shaker Village. The second plan is a **miter clamping jig**. Its an easy-to-make project for anyone wanting to make frames with mitered corners.

To get these free plans, check out their ezine free plans [site](#).

[Monday November 10, 2003 #](#)

How to Choose the Right Sandpaper - Part 1

This is Part 1 in a two-part series on the five things to consider when buying sandpaper for your woodworking and finishing projects. This part covers types of abrasives used in sandpaper and grit sizes. Part 2 addresses binders, backing material, and optional adherence materials.

[Wednesday August 13, 2003 #](#)

How to Choose the Right Sandpaper - Part 2

This is Part 2 in a two-part series on the five things to consider when buying sandpaper for your woodworking and finishing projects. This part covers binders, backing material, and optional adherence materials. Part 1 addresses types of abrasives used in sandpaper and grit sizes.

[Wednesday August 13, 2003 #](#)

How to Prepare Lumber for Your Woodworking Projects

Your guide takes you through the eight steps on how to prepare lumber for your next woodworking project. Whether you buy lumber rough or surfaced from the mill, the lumber yard, a home center, or a specialty wood store you have to prepare the lumber for use.

[Tuesday August 12, 2003 #](#)

Planning for Wood Expansion and Contraction

Wood expands and shrinks. Your guide discusses why wood moves, provides a formula for calculating the movement, and points out where wood movement can be an important consideration in your project design.

[Friday August 08, 2003 #](#)

A Hand Tools List for the Beginner

Subscribe Now



Stay up-to-date!

Subscribe to our newsletter.

ResultsAbout

New from About.com!

[Get Paid to Improve Search](#)

Find Results Now:

[Crafts](#)

[Log Homes](#)

[Cliff Notes](#)

[Death](#)

[Quotes](#)

Every woodworker needs hand tools. Here's a list of tools for the woodworker just starting out. This list is by no means exhaustive - its only meant to be a guide. A future article will include an extended list for the more experienced woodworker.

[Monday July 28, 2003](#) #

The Types of Files and Rasps Used in Woodworking

Your guide discusses the basic types of files and rasps used in woodworking. The difference between files and rasps is explained. Then the purpose of each type of file and rasp is discussed.

[Monday July 28, 2003](#) #

Advertising

> [Free Credit Report](#)

[Display Latest Headlines](#) **XML** | [Read Archives](#)

powered by [Movable Type](#)

[Email this page](#) | [Sign up for a Newsletter](#) |

FREE TRIAL ISSUE Of Crafts Magazine!

Get your FREE trial issue of *Crafts Magazine* and receive 7 more issues for ONLY \$17.97 -- **that's a 54% savings!** We'll bill you later.

Fill out the form and get great ideas to help reveal your creative genius. Just complete the information below and click on submit. **Order now!**

Trial Issue!



Give a gift!

ORDER NOW!

Email:

First Name:

Last Name:

Address Line 1:

Address Line 2:

City:

State:

Zip:

Select a payment option: Charge my credit card

Bill me later

Explore More

Most Popular Articles

- [A Hand Tools List for the Beginner](#)
- [How to Prepare Lumber for Your Woodworking Projects](#)
- [How to Choose the Right Sandpaper -- Part 1](#)
- [About Woodworking Glossary](#)
- [How to Choose the Right Sandpaper -- Part 2](#)
- [Planning for Wood Expansion and Contraction](#)
- [The Types of Files and Rasps Used in Woodworking](#)

What's Hot Now

- [How to Choose the Right Sandpaper -- Part 1](#)
- [How to Prepare Lumber for Your Woodworking Projects](#)
- [The Types of Files and Rasps Used in Woodworking](#)

[About Us](#) | [Advertise on This Site](#) | [User Agreement](#) | [Privacy Policy](#) | [Kids' Privacy Policy](#) | [Help](#)

Copyright © 2003 About, Inc. About and About.com are registered trademarks of About, Inc. The About logo is a trademark of About, Inc. All rights reserved.



ShopNotes[®] Cutting Diagram

Fold-Down Workstation

Hardware

- (2) $\frac{5}{8}$ " I.D. x $\frac{3}{4}$ " O.D. Flange Bearings
 - (2) $\frac{3}{8}$ " T-Nuts
 - (2) $\frac{3}{8}$ " Leg Levelers
 - (12) #8 x $3\frac{1}{2}$ " Fh Woodscrews
 - (8) #8 x $2\frac{1}{2}$ " Fh Woodscrews
 - (54) #8 x $1\frac{1}{4}$ " Fh Woodscrews
 - (8) #8 x 3" Fh Woodscrews
 - (2 Pr.) 3" x 2" Butt Hinges
 - (2) $\frac{1}{8}$ " x 2" - 17" Steel Plate
 - (2) $\frac{5}{8}$ " x $1\frac{3}{4}$ " Steel Rod
 - (1) $\frac{7}{16}$ " x $1\frac{1}{8}$ " Spring
 - (1) 3" x 2" Loose Pin Hinge
 - (2) $3\frac{1}{2}$ " Sash Pulls (w/screws)
 - (2 Pr.) 2" x $1\frac{5}{8}$ " Hinges w/screws
 - (2) Magnetic Catches & Strike Plates (w/screws)
 - (12) $\frac{1}{4}$ " Shelf Pins
 - (1) Vise & Handle w/mounting hardware (Opt.)
 - (2) Magnetic Tool Bars w/screws (Opt.)
- Note: Hardware list does not include hardware for mounting workstation, tool rack, or cabinet to wall.

2" x 10" - 12' (THREE BOARDS)

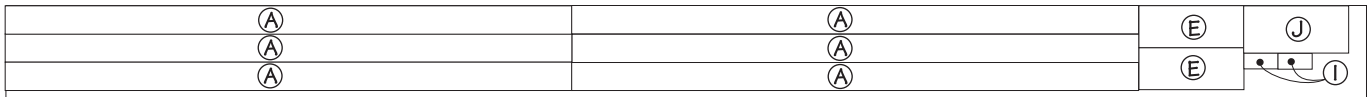

2" x 4" - 96" (TWO BOARDS)



2" x 4" - 96"



2" x 4" - 96" (TWO BOARDS)



2" x 4" - 96"



2" x 4" - 96"



2" x 4" - 96" (TWO BOARDS)

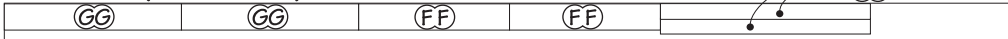

2" x 4" - 96" (TWO BOARDS)



Materials

Workbench

A Top (1)	2 1/2 x 24 - 59 3/4
B Side Panels (2)	9 1/4 x 18 7/8 - 1 1/2 Ply.
C Edging	3/4 x 1 1/2 - 96 Rgh.
D Stretchers (2)	1 1/2 x 3 1/2 - 60
E Corner Braces (4)	1 1/2 x 4 - 10
F Legs (2)	3 x 3 - 31 1/2
G Rails (4)	1 1/2 x 3 1/2 - 17 3/4
H Spacers (2)	3/4 Rgh. x 3 - 5
I Stops (2)	1 x 1 1/2 - 2 Rgh.
J Face Block (1)	3 x 4 1/2 - 10

Tool Rack

K Top Rail (1)	1 1/2 x 1 1/2 - 61
L Bottom Rail (1)	1 1/2 x 3 1/2 - 60
M End Stiles (2)	1 1/2 x 1 1/2 - 20

N Center Stiles (2)	1 1/2 x 1 1/2 - 19
O Pegboard Panel (1)	18 x 28 - 1/4 Pgbd.
P Hardboard Panel (1)	18 x 28 - 1/4 Hdbd.
Q Filler Panel (1)	17 x 27 - 3/4 Ply.
R Filler Strip (1)	1/4 x 1 1/2 - 3
S Benchtop Stop (1)	1 1/2 x 2 7/8 - 18 1/8

Wall Cabinet

T Top/Bottom (2)	9 1/4 x 62 1/2 - 3/4 Ply.
U Sides (2)	9 1/4 x 20 - 3/4 Ply.
V Dividers (2)	9 x 18 1/4 - 3/4 Ply.
W Back (1)	18 3/4 x 62 - 1/4 Hdbd.
X Side Shelves (2)	8 x 20 3/8 - 3/4 Ply.
Y Center Shelf (1)	8 x 18 7/8 - 3/4 Ply.
Z Side Edging (2)	3/4 x 3/4 - 20 3/8
AA Center Edging (1)	3/4 x 3/4 - 18 7/8

BB Cleats (2)	3 1/2 x 20 1/2 - 3/4 Ply.
CC Frame Rails (6)	3/4 x 1 1/2 - 19
DD Frame Stiles (4)	3/4 x 1 1/2 - 20
EE Filler Strip (1)	1 1/2 x 3/4 - 62
FF Door Rails (4)	3/4 x 2 1/2 - 14 3/8
GG Door Stiles (4)	3/4 x 2 1/2 - 16 7/8
HH Door Panels (2)	12 3/8 x 14 3/8 - 1/4 Hdbd.

36" x 96" - 1/4" HARDBOARD

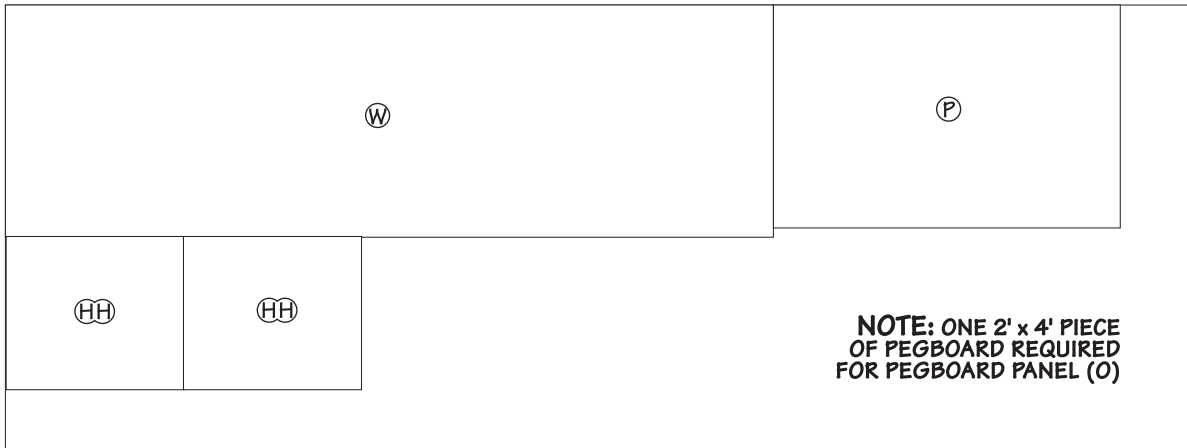

48" x 96" - 3/4" PLYWOOD

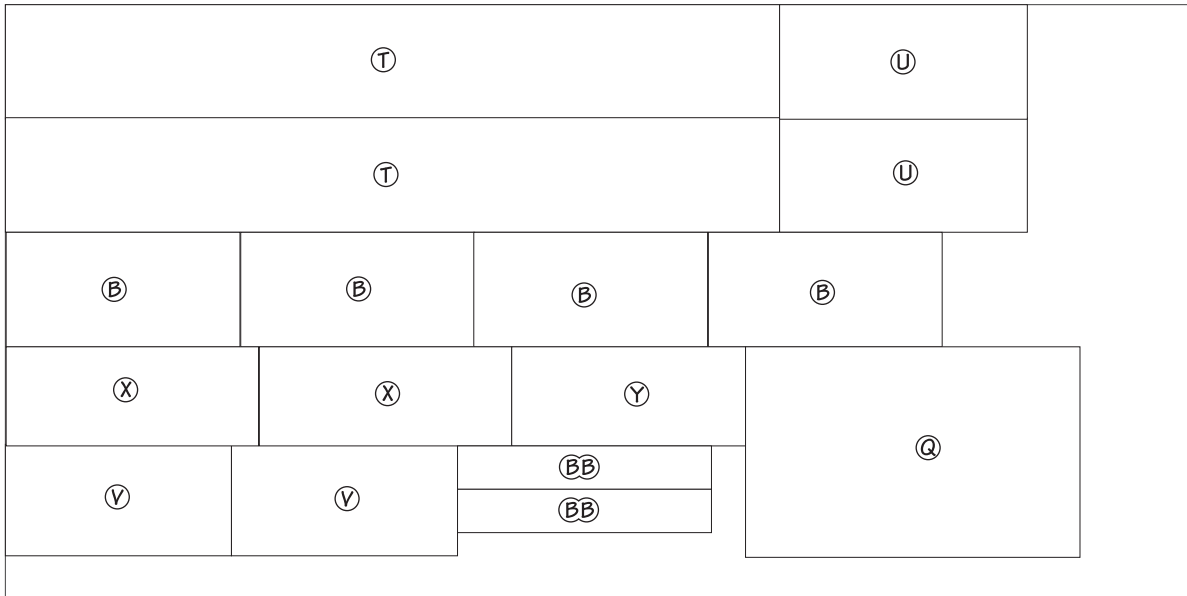



Woodworking

with [Lew Soloway](#)

Your Guide to one of [hundreds of sites](#)

This page sponsored by



[Home](#) · [Articles](#) · [Forums](#) · [Chat](#) · [Newsletters](#) · [Help](#)

Subjects

ESSENTIALS

· [About Woodworking](#)

Glossary

· [A Beginner's Hand](#)

Tools List

· [How to Prepare](#)

Lumber for Projects

· [How to Choose](#)

[Sandpaper - Part 1](#)

· [How to Choose](#)

[Sandpaper - Part 2](#)

WOODWORKING

OFFERS

· [Workbench Plans](#)

· [Woodworking](#)

Machinery

· [Delta Woodworking](#)

Tools

· [Woodworking Tools](#)

· [Dewalt Tools](#)

[Dust Collection](#)

[Events](#)

[Finishing](#)

[Furniture Styles](#)

[Glossaries](#)

[Hand Tools](#)

[Joinery](#)

[Lumber](#)

In The Spotlight

WOOD Online is offering Free Sleigh Coffee Table Plan

WOOD Online is offering a free Yuletide Sleigh Coffee Table plan. The sleigh coffee table includes bent-wood laminations. The plan comes with detailed instructions, cut lists, and diagrams to take you through the entire process. This project will develop new skills and give you have a beautiful table to boot!

Click [here](#) to register for a free *WOOD Online* e-mail subscription and download the plan. While you are there you can also enter for the November tool giveaway of a Delta 14inch bandsaw with an enclosed base.

[Monday November 24, 2003](#) #

Rockler is having a big Thanksgiving Weekend Sale

While there are no woodworking shows in the U.S. this weekend, Rockler is having a big Thanksgiving Weekend Sale. From Friday, November 28th, through Sunday, November 30th, enjoy all the big savings they have to offer. There are early bird specials from 7am to 11am, each day. Take 25 percent off any one item except power tools. Take \$10 off any power tool. Also, Rockler is giving away free rubber band clamp sets while quantities last. Click [here](#) to find out more.

[Monday November 24, 2003](#) #

Chris Pye's Woodcarving Newsletter on the Web

Chris Pye, a noted English woodcarver and author, publishes a monthly newsletter that he e-mails to subscribers. The November issue includes discussion on carving chisel numbering systems, flat gouges, v-tools, cutting up trees for carving, bandsaws, and offers his famous **Green Man** for sale. He also offers downloads, articles, and links to various sites. To subscribe to the monthly e-zine, go to his wonderful website by clicking [here](#).

[Monday November 17, 2003](#) #

- [Old Tools](#)
- [Project Design](#)
- [Project Plans](#)
- [Power Tools](#)
- [Product Reviews](#)
- [Sharpening](#)
- [Shop Safety](#)
- [Training](#)
- [Woodcarving](#)
- [Woodturning](#)
- [Sources-Finishing](#)
- [Sources-General](#)
- [Sources-Hand Tools](#)
- [Sources-Power Tool](#)
- [Sources-Sharpening](#)

[Subject Library](#)

[All articles on this topic](#)

Woodworker's Journal Has Free Shaker Lap Desk & Miter Clamping Jig Plans

Woodworker's Journal Magazine is offering two new free plans for subscribers of their ezine newsletter in the first half of November. The first plan is for a shaker lap desk which continues the magazine's efforts to present authentic designs from the Hancock Shaker Village. The second plan is a **miter clamping jig**. Its an easy-to-make project for anyone wanting to make frames with mitered corners.

To get these free plans, check out their ezine free plans [site](#).

[Monday November 10, 2003](#) #

How to Choose the Right Sandpaper - Part 1

This is Part 1 in a two-part series on the five things to consider when buying sandpaper for your woodworking and finishing projects. This part covers types of abrasives used in sandpaper and grit sizes. Part 2 addresses binders, backing material, and optional adherence materials.

[Wednesday August 13, 2003](#) #

How to Choose the Right Sandpaper - Part 2

This is Part 2 in a two-part series on the five things to consider when buying sandpaper for your woodworking and finishing projects. This part covers binders, backing material, and optional adherence materials. Part 1 addresses types of abrasives used in sandpaper and grit sizes.

[Wednesday August 13, 2003](#) #

How to Prepare Lumber for Your Woodworking Projects

Your guide takes you through the eight steps on how to prepare lumber for your next woodworking project. Whether you buy lumber rough or surfaced from the mill, the lumber yard, a home center, or a specialty wood store you have to prepare the lumber for use.

[Tuesday August 12, 2003](#) #

Planning for Wood Expansion and Contraction

Wood expands and shrinks. Your guide discusses why wood moves, provides a formula for calculating the movement, and points out where wood movement can be an important consideration in your project design.

[Friday August 08, 2003](#) #

A Hand Tools List for the Beginner

Subscribe Now



Stay up-to-date!

Subscribe to our newsletter.

ResultsAbout

New from About.com!

[Get Paid to Improve Search](#)

Find Results Now:

[Crafts](#)

[Log Homes](#)

[Cliff Notes](#)

[Death](#)

[Quotes](#)

Every woodworker needs hand tools. Here's a list of tools for the woodworker just starting out. This list is by no means exhaustive - its only meant to be a guide. A future article will include an extended list for the more experienced woodworker.

[Monday July 28, 2003](#) #

The Types of Files and Rasps Used in Woodworking

Your guide discusses the basic types of files and rasps used in woodworking. The difference between files and rasps is explained. Then the purpose of each type of file and rasp is discussed.

[Monday July 28, 2003](#) #

Advertising

> [Free Credit Report](#)

[Display Latest Headlines](#) **XML** | [Read Archives](#)

powered by [Movable Type](#)

[Email this page](#) | [Sign up for a Newsletter](#) |

FREE TRIAL ISSUE Of Crafts Magazine!

Get your FREE trial issue of *Crafts Magazine* and receive 7 more issues for ONLY \$17.97 -- **that's a 54% savings!** We'll bill you later.

Fill out the form and get great ideas to help reveal your creative genius. Just complete the information below and click on submit. **Order now!**

Trial Issue!



Give a gift!

ORDER NOW!

Email:

First Name:

Last Name:

Address Line 1:

Address Line 2:

City:

State:

Zip:

Select a payment option: Charge my credit card

Bill me later

Explore More

Most Popular Articles

- [A Hand Tools List for the Beginner](#)
- [How to Prepare Lumber for Your Woodworking Projects](#)
- [How to Choose the Right Sandpaper -- Part 1](#)
- [About Woodworking Glossary](#)
- [How to Choose the Right Sandpaper -- Part 2](#)
- [Planning for Wood Expansion and Contraction](#)
- [The Types of Files and Rasps Used in Woodworking](#)

What's Hot Now

- [How to Choose the Right Sandpaper -- Part 1](#)
- [How to Prepare Lumber for Your Woodworking Projects](#)
- [The Types of Files and Rasps Used in Woodworking](#)

[About Us](#) | [Advertise on This Site](#) | [User Agreement](#) | [Privacy Policy](#) | [Kids' Privacy Policy](#) | [Help](#)

Copyright © 2003 About, Inc. About and About.com are registered trademarks of About, Inc. The About logo is a trademark of About, Inc. All rights reserved.



Search

[Web Hosting](#)

Woodworking

Woodworking Offers > Woodworking Machinery

Sponsored Links

About these offers:

These offers are ads that have been purchased by companies that want to have their ads appear next to relevant content, based on a set of keywords they specify. The offers are administered, sorted and maintained by a third party.

Explore More

Most Popular Articles

- [A Hand Tools List for the Beginner](#)
- [How to Prepare Lumber for Your Woodworking Projects](#)
- [How to Choose the Right Sandpaper -- Part 1](#)
- [About Woodworking Glossary](#)
- [How to Choose the Right Sandpaper -- Part 2](#)
- [Planning for Wood Expansion and Contraction](#)
- [The Types of Files and Rasps Used in Woodworking](#)

What's Hot Now

- [How to Choose the Right Sandpaper -- Part 1](#)
- [How to Prepare Lumber for Your Woodworking Projects](#)
- [The Types of Files and Rasps Used in Woodworking](#)

[About Us](#) | [Advertise on This Site](#) | [User Agreement](#) | [Privacy Policy](#) | [Kids' Privacy Policy](#) | [Help](#)

Copyright © 2003 About, Inc. About and About.com are registered trademarks of About, Inc. The About logo is a trademark of About, Inc. All rights reserved.



Woodworking

with [Lew Soloway](#)Your Guide to one of [hundreds of sites](#)

This page sponsored by

[Home](#) · [Articles](#) · [Forums](#) · [Chat](#) · [Newsletters](#) · [Help](#)

Subjects

ESSENTIALS

- [About Woodworking](#)

Glossary

- [A Beginner's Hand](#)

Tools List

- [How to Prepare](#)

Lumber for Projects

- [How to Choose](#)

Sandpaper - Part 1

- [How to Choose](#)

Sandpaper - Part 2

The Types of Files and Rasps Used in Woodworking

 [Email to a friend](#)
 [Printer friendly version](#)

Elsewhere on the Web

- [How to Sharpen a Saw](#)
- [Patternmakers Rasps](#)
- [Boggs File Sharpening](#)

About Woodworking

 Subscribe to the Free Newsletter
 Your Email

Address:

I once had an instructor tell me that files are for metal and rasps are for wood. After getting a set of patternmaker's rasps that were properly sharpened, I have to agree with him. Both files and rasps, however, have places in the woodworker's shop.

What is the difference between a file and a rasp?

Files and rasps are both bars of steel with teeth cut into the metal. It is how the teeth are cut and shaped that distinguishes the file from the rasp.

Files have teeth that extend as continuous rows across the face at an angle. Files with rows of teeth going in one direction are called *mill files*. Files with rows going in both directions are called *double-cut* or *flat files*. Mill files generally provide smoother finishes than double-cut files.

The closer the rows are to each other, the finer the cut of the file in use. Coarse files are called *bastard* files. Medium files are called *second-cut* files. Fine files are called *smooth* files.

Rasps are made up of individual teeth along rows straight across the face. Again, the closer the rows and the smaller the teeth, the finer the cut. Better quality rasps, called *patternmaker's cabinet rasps* have random teeth placement across the rows indicating they weren't just stamped out on a machine. The random patterns leave smoother surfaces.

File Types

Files used on wood are coarser in comparison to files used on metal.

WOODWORKING

OFFERS

- [Workbench Plans](#)

- [Woodworking](#)

Machinery

- [Delta Woodworking](#)

Tools

- [Woodworking Tools](#)

- [Dewalt Tools](#)

Dust Collection

Events

Finishing

Furniture Styles

Glossaries

Hand Tools

Joinery

Lumber

Old Tools

Project Design

[Project Plans](#)

[Power Tools](#)

[Product Reviews](#)

[Sharpening](#)

[Shop Safety](#)

[Training](#)

[Woodcarving](#)

[Woodturning](#)

[Sources-Finishing](#)

[Sources-General](#)

[Sources-Hand Tools](#)

[Sources-Power Tool](#)

[Sources-Sharpening](#)

[Subject Library](#)

[All articles on this topic](#)

[Subscribe Now](#)



There are two types used on wood - wood files and cabinet files. They are both half round in cross-section, gradually taper towards the end, and are double-cut. The wood file is coarser than the cabinet file, which is used for final smoothing. However, neither file is common at hardware stores, home centers, or specialty woodworking stores. I haven't found the need to take the time to find them for use.

There are other uses for files in the woodshop. The most common are: preparing scrapers, sharpening saws, and sharpening bits. See the links in the [Sharpening](#) section for more information about how to do these operations.

For preparing scrapers, I use a flat mill bastard file. The mill bastard file is the most commonly found file at hardware and home stores. It is rectangular in cross-section and tapers slightly towards the tip. I have both 8 and 10 inch lengths.

For sharpening western-style saws you need two different types of files. The first is the flat mill bastard file for *jointing* or flattening the saw teeth edge. The other file is the triangular tapered file used for sharpening the sides of the saw teeth. Triangular files come in different size cross-sections for use with the different number of teeth per inch (tpi) that come on saws. There is also a *feather-edge file* that is used in sharpening Japanese-style saws.

Drill bit sharpening is done with auger-bit files. They are very different in shape from other files, being specialized for sharpening the cutting edges of drill bits, auger bits, and forstner bits.

[1](#) | [2](#) | [next](#)

Stay up-to-date!

Subscribe to our newsletter.

[Email this page](#) | [Sign up for a Newsletter](#) |

FREE TRIAL ISSUE Of Crafts Magazine!

Get your FREE trial issue of *Crafts Magazine* and receive 7 more issues for ONLY \$17.97 -- **that's a 54% savings!** We'll bill you later.

Fill out the form and get great ideas to help reveal your creative genius. Just complete the information below and click on submit. **Order now!**

ResultsAbout

New from About.com!

[Get Paid to Improve Search](#)

Find Results Now:

[Crafts](#)

[Log Homes](#)

[Cliff Notes](#)

[Death](#)

[Quotes](#)

Advertising
> [Free Credit Report](#)

Trial Issue!



Give a gift!

ORDER NOW!

Email:
First Name:
Last Name:
Address Line 1:
Address Line 2:
City:
State:
Zip:

Select a payment option: Charge my credit card Bill me later

Brought to you by **WHAT YOU NEED TO KNOW About**

Explore More

Most Popular Articles

- [A Hand Tools List for the Beginner](#)
- [How to Prepare Lumber for Your Woodworking Projects](#)
- [How to Choose the Right Sandpaper -- Part 1](#)
- [About Woodworking Glossary](#)
- [How to Choose the Right Sandpaper -- Part 2](#)
- [Planning for Wood Expansion and Contraction](#)
- [The Types of Files and Rasps Used in Woodworking](#)

What's Hot Now

- [How to Choose the Right Sandpaper -- Part 1](#)
- [How to Prepare Lumber for Your Woodworking Projects](#)
- [The Types of Files and Rasps Used in Woodworking](#)

[About Us](#) | [Advertise on This Site](#) | [User Agreement](#) | [Privacy Policy](#) | [Kids' Privacy Policy](#) | [Help](#)

Copyright © 2003 About, Inc. About and About.com are registered trademarks of About, Inc. The About logo is a trademark of About, Inc. All rights reserved.



Woodworking

with [Lew Soloway](#)

Your Guide to one of [hundreds of sites](#)

This page sponsored by



[Home](#) · [Articles](#) · [Forums](#) · [Chat](#) · [Newsletters](#) · [Help](#)

Subjects

ESSENTIALS

· [About Woodworking](#)

[Glossary](#)

· [A Beginner's Hand](#)

[Tools List](#)

· [How to Prepare](#)

[Lumber for Projects](#)

· [How to Choose](#)

[Sandpaper - Part 1](#)

· [How to Choose](#)

[Sandpaper - Part 2](#)

WOODWORKING

OFFERS

· [Workbench Plans](#)

· [Woodworking](#)

[Machinery](#)

· [Delta Woodworking](#)

[Tools](#)

· [Woodworking Tools](#)

· [Dewalt Tools](#)

[Dust Collection](#)

[Events](#)

[Finishing](#)

[Furniture Styles](#)

[Glossaries](#)

[Hand Tools](#)

[Joinery](#)

[Lumber](#)

Woodturning

[Guide picks](#)

Woodturning involves a broad range of turning subjects from turning handles and legs, to bowls and dishes, to anything imaginable.

[The American Association of Woodturners](#)

The American Association of Woodturners is an international, nonprofit organization dedicated to the advancement of woodturning. The AAW's mission is to provide education, information, and organization to those interested in turning wood.

[The Association of Woodturners of Great Britain](#)

The Association of Woodturners of Great Britain is an international, nonprofit organisation dedicated to the advancement and promotion of woodturning. The AWGB's mission is to provide education, information, and organisation to those interested in woodturning.

[The Woodturning Reference and Information Site](#)

The Woodturning Reference and Information Site was developed for both professional and amateur woodturners. The site is maintained by Alan Green of Weymouth, Dorset, England, UK. There is a lot at the site including a bulletin board and chat room, galleries, links, hints and tips, suppliers, equipment reviews, clubs and associations, etc.

[Woodturning On The Web](#)

Woodturning On The Web is dedicated to woodturners around the world with many popular links to related sites. The site has a true international flavor with sites from not only the USA, but also Greece, Columbia, Costa Rica, the UK, Luxembourg, and France.

[Woodturning Online](#)

Woodturning Online is a link and information site on turning. They have articles and projects to download, lists of publications,

[Old Tools](#)

[Project Design](#)

[Project Plans](#)

[Power Tools](#)

[Product Reviews](#)

[Sharpening](#)

[Shop Safety](#)

[Training](#)

[Woodcarving](#)

[Woodturning](#)

[Sources-Finishing](#)

[Sources-General](#)

[Sources-Hand Tools](#)

[Sources-Power Tool](#)

[Sources-Sharpening](#)

[Subject Library](#)

[All articles on this topic](#)

Subscribe Now



Stay up-to-date!

Subscribe to our newsletter.

ResultsAbout

books, and videos for turners, courses and schools to attend, clubs and organizations to join, events to attend, and whole lot more.

More Woodturning

More Woodturning is a monthly publication (ten times a year) for woodturners. It includes how-to articles, news about what is happening in woodturning circles, new product information, and classified ads. The publication is based in Snohomish, Washington, USA and ships worldwide.

Best Wood Tools

Best Wood Tools is a manufacturer of woodturning accessories for the lathe and other woodworking tools. They are located in Crossville, Tennessee, USA and ship worldwide.

The Burl Source

The Burl Source is an American distributor for the finest Australian and rare North American burls and burlwood products for turners. They are located in Sandy, Utah.

The Woodturners Catalog

The Woodturners Catalog is a provider of turning supplies based in Provo, Utah, USA. They carry tools, lathes, wood blanks, adhesives, alternate materials, project plans and kits, finishing supplies, sharpening equipment, books, and accessories. They also conduct 3 and 5 day workshops for the beginner, intermediate, and advanced student.

Wood N' Things

This site is the home of Jim Driskell, a professional woodturner, teacher, and developer of a buffing system for use on the wood lathe.

[Email this page](#) | [Sign up for a Newsletter](#) |

FREE TRIAL ISSUE Of Crafts Magazine!

New from About.com!

[Get Paid to Improve Search](#)

Find Results Now:

- [Crafts](#)
- [Log Homes](#)
- [Cliff Notes](#)
- [Death](#)
- [Quotes](#)

Advertising

> [Free Credit Report](#)

Get your FREE trial issue of *Crafts Magazine* and receive 7 more issues for ONLY \$17.97 -- **that's a 54% savings!** We'll bill you later.

Fill out the form and get great ideas to help reveal your creative genius. Just complete the information below and click on submit. **Order now!**

Trial Issue!



Give a gift!

ORDER NOW!

Email:

First Name:

Last Name:

Address Line 1:

Address Line 2:

City:

State:

Zip:

Select a payment option:

- Charge my credit card
- Bill me later

Brought to you by **About**
WHAT YOU NEED TO KNOW

Explore More

Most Popular Articles

- [A Hand Tools List for the Beginner](#)
- [How to Prepare Lumber for Your Woodworking Projects](#)
- [How to Choose the Right Sandpaper -- Part 1](#)
- [About Woodworking Glossary](#)
- [How to Choose the Right Sandpaper -- Part 2](#)
- [Planning for Wood Expansion and Contraction](#)
- [The Types of Files and Rasps Used in Woodworking](#)

What's Hot Now

- [How to Choose the Right Sandpaper -- Part 1](#)
- [How to Prepare Lumber for Your Woodworking Projects](#)
- [The Types of Files and Rasps Used in Woodworking](#)

[About Us](#) | [Advertise on This Site](#) | [User Agreement](#) | [Privacy Policy](#) | [Kids' Privacy Policy](#) | [Help](#)

Copyright © 2003 About, Inc. About and About.com are registered trademarks of About, Inc. The About logo is a trademark of About, Inc. All rights reserved.

- [Back to the Topic Site](#)
- [Turn off this top frame](#)

redwood

california redwood association

[homeowners](#) [builders](#) [merchants](#) [forests](#) [reference](#)

| [redwood](#) | [homeowners](#) | [bench](#)



build our stylish mendocino bench

The clean, horizontal lines and rich redwood tones of this bench design reflect the simple beauty of Northern California. Comfortable and elegant with a gracefully curved seat and angled backrest, it offers a standing invitation to sit, relax and enjoy.

[Plans](#) are available in Adobe Acrobat (PDF) format.

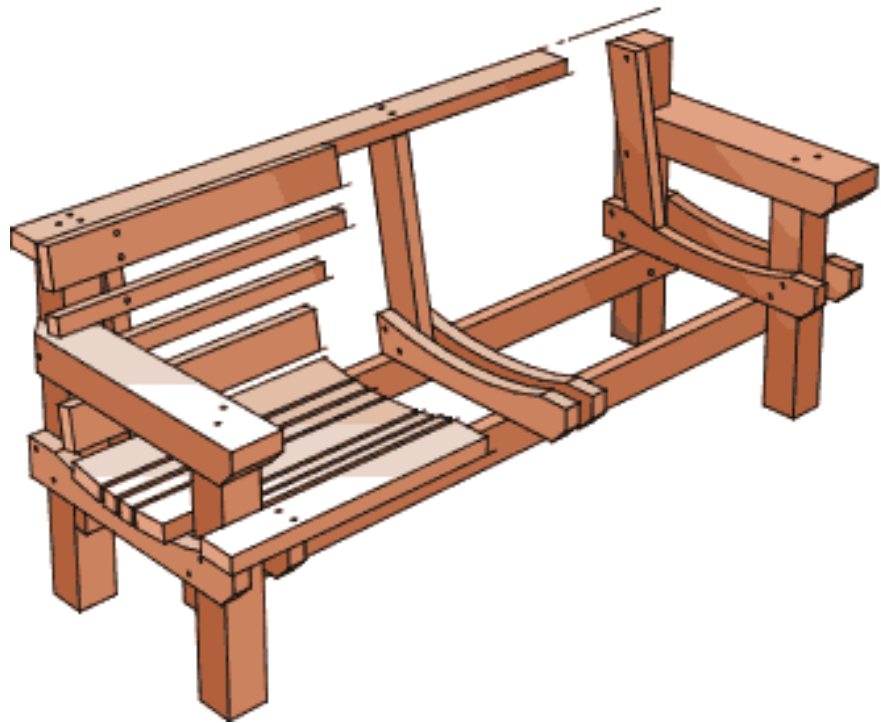

This freestanding bench uses Construction Common or Deck Common redwood grades that have a pleasing mix of heartwood and sapwood. Where increased decay resistance is needed, use all-heartwood grades: Construction Heart or Deck Heart.

Use only corrosion-resistant deck screws to prevent staining. Counter-sink and plug screw attachments.

Start building the bench by trimming and notching the armrests:

the big picture

bench materials

3d view of bench

next

step 1 - trim and notch the armrests

this page last updated: November 10, 2003



[homeowners](#) [builders](#) [merchants](#) [forests](#) [reference](#)

| [redwood](#) | [homeowners](#) | [bench](#) | [bench materials](#)

materials for benches

	quantity	size	length
top, seat and backrest rails	6	2x4	6 feet
seat and backrest rails	6	2x2	6 feet
main braces	2	2x4	5 foot 9 inches
seat and backrest supports	9	2x4	26 inches
front legs	2	4x4	20-1/2 inches
back legs	2	4x4	30-1/2 inches
armrests	2	4x6	26 inches
deck screws	1-1/2 pounds	3 and 4 inches	

close

this page last updated: April 26, 2001



Woodworking

with [Lew Soloway](#)

Your Guide to one of [hundreds of sites](#)

This page sponsored by



[Home](#) · [Articles](#) · [Forums](#) · [Chat](#) · [Newsletters](#) · [Help](#)

Subjects

ESSENTIALS

· [About Woodworking](#)

Glossary

· [A Beginner's Hand](#)

Tools List

· [How to Prepare](#)

Lumber for Projects

· [How to Choose](#)

Sandpaper - Part 1

· [How to Choose](#)

Sandpaper - Part 2

WOODWORKING

OFFERS

· [Workbench Plans](#)

· [Woodworking](#)

Machinery

· [Delta Woodworking](#)

Tools

· [Woodworking Tools](#)

· [Dewalt Tools](#)

[Dust Collection](#)

[Events](#)

[Finishing](#)

[Furniture Styles](#)

[Glossaries](#)

[Hand Tools](#)

[Joinery](#)

[Lumber](#)

Furniture Styles

Guide picks

The subject presents information about furniture discussions and links for the various periods of furniture-making around the world, including Arts & Crafts, Chinese, Contemporary, Federal, Japanese, Moderne, Queen Anne, and Rococco, among others.

[The Arts & Crafts Museum of Cheltenham Art Gallery & Museum](#)

The Cheltenham Art Gallery & Museum created this site for it's nationally-important collection on the Arts & Crafts Movement in Britain. It spanned the 1880s to about 1940. Considered one of the most inspiring and influential art movements to develop in Britain, it had an international impact.

[The Arts & Crafts Society](#)

The Arts & Crafts Society site has been created to provide an online "home" for the present-day Arts & Crafts Movement community. If you want to learn more about what the Arts & Crafts movement is all about check this site out.

[The Arts and Crafts Home](#)

The Arts and Crafts Home is a design source for home decoration featuring replicas of the greatest designers of the period. They also have designs from the Gothic Revival and Aesthetic periods.

[Colonial Williamsburg](#)

Colonial Williamsburg is a 301-acre Historic Area in which stands hundreds of restored, reconstructed, and historically furnished buildings. Costumed interpreters tell the stories of the men and women of the 18th-century city including a fully functional woodworking shop. In this historic place, they help the future learn from the past.

[Moderne Gallery](#)

Moderne Gallery showcases the works of George Nakashima, the American Craft and Studio Furniture Movement including

[Old Tools](#)

[Project Design](#)

[Project Plans](#)

[Power Tools](#)

[Product Reviews](#)

[Sharpening](#)

[Shop Safety](#)

[Training](#)

[Woodcarving](#)

[Woodturning](#)

[Sources-Finishing](#)

[Sources-General](#)

[Sources-Hand Tools](#)

[Sources-Power Tool](#)

[Sources-Sharpening](#)

[Subject Library](#)

[All articles on this topic](#)

Esherick, Maloof, Castle, Stocksdale and others, plus works from the French Art Deco period and the 40's.

[The Shaker Museum and Library](#)

The Shaker Museum and Library is a center for the interpretation and exhibition of Shaker life and culture. The collections of the Shaker Museum and Library include furniture, oval boxes, textiles, craft machinery, art, tools, agricultural machinery and archival materials.

[The Society of American Period Furniture Makers](#)

The Society of American Period Furniture Makers is intended for anyone having a passionate interest in the making, reproducing, and conservation of American period furniture and was established as a forum to promote the understanding, education, and appreciation of the craft.

[Tribu Design](#)

This site is dedicated to the decorative arts and designs of the 20th Century including furniture designers such as Nakashima, Eames, Wegner, Van de Velde, and too many others to name. If you like 20th Century furniture from around the world, this is a good place to look at designers' works.

[Winterthur](#)

Winterthur, an American country estate, is the former home of Henry Francis du Pont, an avid antiques collector and horticulturist. Most notable is an addition of 175 "period" rooms that serves as a showcase for du Pont's collection of antique American furniture, silver, needlework, textiles, paintings, prints, ceramics, and glass.

[Email this page](#) | [Sign up for a Newsletter](#) |

[Subscribe Now](#)



Stay up-to-date!
Subscribe to our newsletter.

[ResultsAbout](#)

FREE TRIAL ISSUE Of Crafts Magazine!

New from About.com!

[Get Paid to Improve Search](#)

Find Results Now:

- [Crafts](#)
- [Log Homes](#)
- [Cliff Notes](#)
- [Death](#)
- [Quotes](#)

Advertising

> [Free Credit Report](#)

Get your FREE trial issue of *Crafts Magazine* and receive 7 more issues for ONLY \$17.97 -- **that's a 54% savings!** We'll bill you later.

Fill out the form and get great ideas to help reveal your creative genius. Just complete the information below and click on submit. **Order now!**

Trial Issue!



Give a gift!

ORDER NOW!

Email:

First Name:

Last Name:

Address Line 1:

Address Line 2:

City:

State:

Zip:

Select a payment option:

- Charge my credit card
- Bill me later

Brought to you by **About**
WHAT YOU NEED TO KNOW

Explore More

Most Popular Articles

- [A Hand Tools List for the Beginner](#)
- [How to Prepare Lumber for Your Woodworking Projects](#)
- [How to Choose the Right Sandpaper -- Part 1](#)
- [About Woodworking Glossary](#)
- [How to Choose the Right Sandpaper -- Part 2](#)
- [Planning for Wood Expansion and Contraction](#)
- [The Types of Files and Rasps Used in Woodworking](#)

What's Hot Now

- [How to Choose the Right Sandpaper -- Part 1](#)
- [How to Prepare Lumber for Your Woodworking Projects](#)
- [The Types of Files and Rasps Used in Woodworking](#)

[About Us](#) | [Advertise on This Site](#) | [User Agreement](#) | [Privacy Policy](#) | [Kids' Privacy Policy](#) | [Help](#)

Copyright © 2003 About, Inc. About and About.com are registered trademarks of About, Inc. The About logo is a trademark of About, Inc. All rights reserved.



- [Back to the Topic Site](#)
- [Turn off this top frame](#)

Cutting Diagram

Drill Press Table & Fence

Materials

Base Assembly

A Bottom (1)	15 x 12 ¹ / ₂ - 1/2 Plywood
B Sides (2)	15 x 3 ⁵ / ₈ - 1/2 Plywood
C Back/Divider (2)	11 ³ / ₄ x 3 ⁵ / ₈ - 1/2 Plywood

Table Assembly

D Top Core (1)	32 x 17 - 1/2 Plywood
E Top Skins (2)	32 x 17 - 1/4 Hardboard
Inserts (1+)	4 ¹ / ₄ x 4 ¹ / ₄ - 1/4 Hardboard

Fence Assembly

F Fence Blank (1)	36 x 6 - 1/2 Plywood
	36 x 6 - 1/4 Hardboard
G Stop Block (1)	2 ¹ / ₂ x 2 ¹ / ₂ - 1/2 Plywood

Tray Assembly

H Tray Bottom (1)	11 ⁷ / ₁₆ x 6 - 1/4 Hardboard
I Front/Back (2)	10 ¹⁵ / ₁₆ x 1 ¹ / ₄ - 1/2 Plywood
J Tray Ends (2)	5 ¹ / ₂ x 1 ¹ / ₄ - 1/2 Plywood
K Tray Guides (2)	6 x 3 ³ / ₈ - 1/4 Hardboard

48 x 48 - 1/2 PLYWOOD

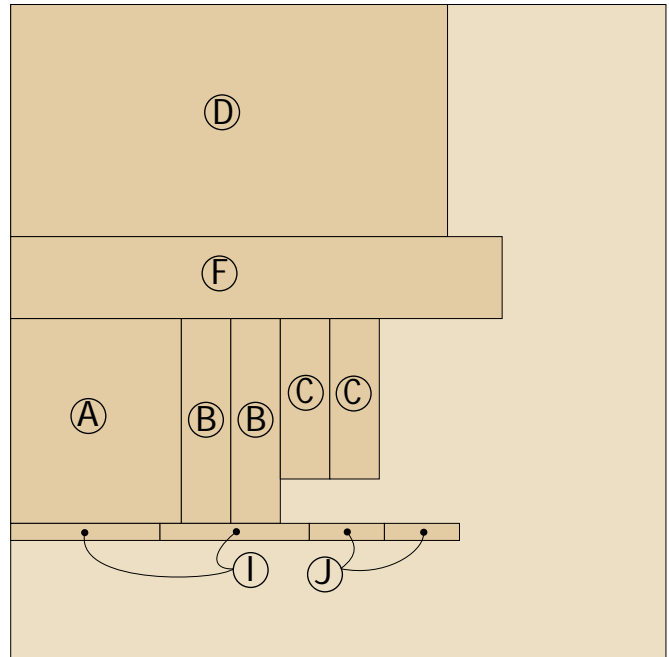

48 x 48 - 1/4 HARDBOARD

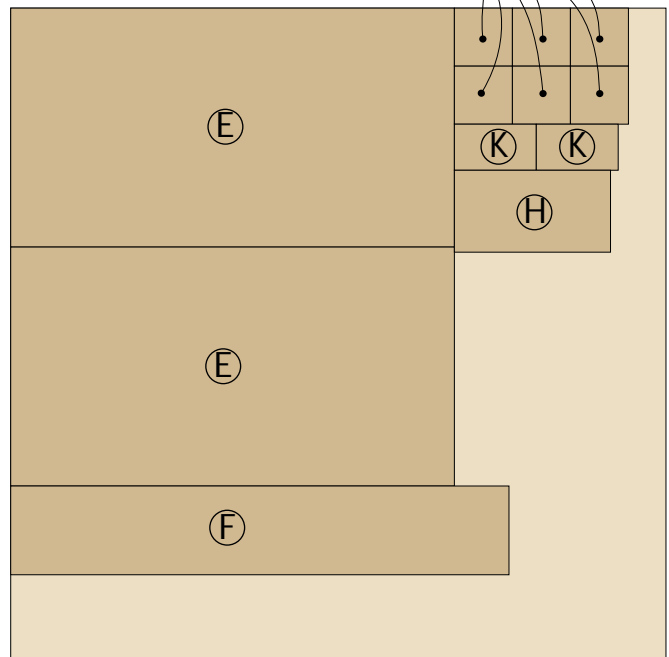

Jeff Greef Woodworking

See more [Project Plans](#) | Sign up for [Email Notices](#) of new projects

[Tell Your Friends](#)
about this page. Click here
to send an email.
Thank You!

To see more *Furniture Plans* on this site, go to:
[Printed Furniture Plans](#) or [Downloadable Furniture Plans](#) or [Furniture Plan Books](#)

ON SALE!



[ROCKLER ONLINE](#)

SPECIALS!

[See what they've got on sale this month. Some real deals here.](#)

Rockler.com
WOODWORKING
SUPERSTORE

**Search from over
9000 products!**

Corner Cabinet

This project has 3 pages.

This is Page 1.

[Go to Page 2.](#)

[Go to Page 3.](#)



This small, wall-mounted corner cabinet is very handy for storing cups, glasses or other items in a room where space is at a premium. The basic construction is not very complex or time consuming which frees you to do the fun part of the project, the carving. The vertical "S" curve pattern on either side of the door is a kind of running carving which is done very systematically, whereas the outline of the vine in the door, and the grooves around it, are done with a V-parting tool following a sketched design.



Parts List- Corner Cabinet

1- 1/2 x 10-3/8 x 32
back

1- 1/2 x 9-7/8 x 32
back

2- 1/2 x 2 x 32 front
sides

1- 1/2 x 5 x 12-1/2
top plate

2- 1/2 x 1-3/4 x 27
door stiles

2- 1/2 x 1-3/4 x 9-
3/4 door top and
bottom rails

2- 1/2 x 1-1/4 x 9-
3/4 door mid rails

2- 1/2 x 1-1/4 x 9-
3/4 door mullions

4- 1/2 x 4-3/8 x 9-
1/2 panels

1- 1/2 x 3-1/2 x 9-
1/2 bottom panel

1- 1/2 x 12-1/2 x 36
top, bottom and two
shelves, nested
along their angles.

1- 3/4 x 2-1/2 x 18
top mould

16- 1/2 x 1/2 x 2
screw blocks

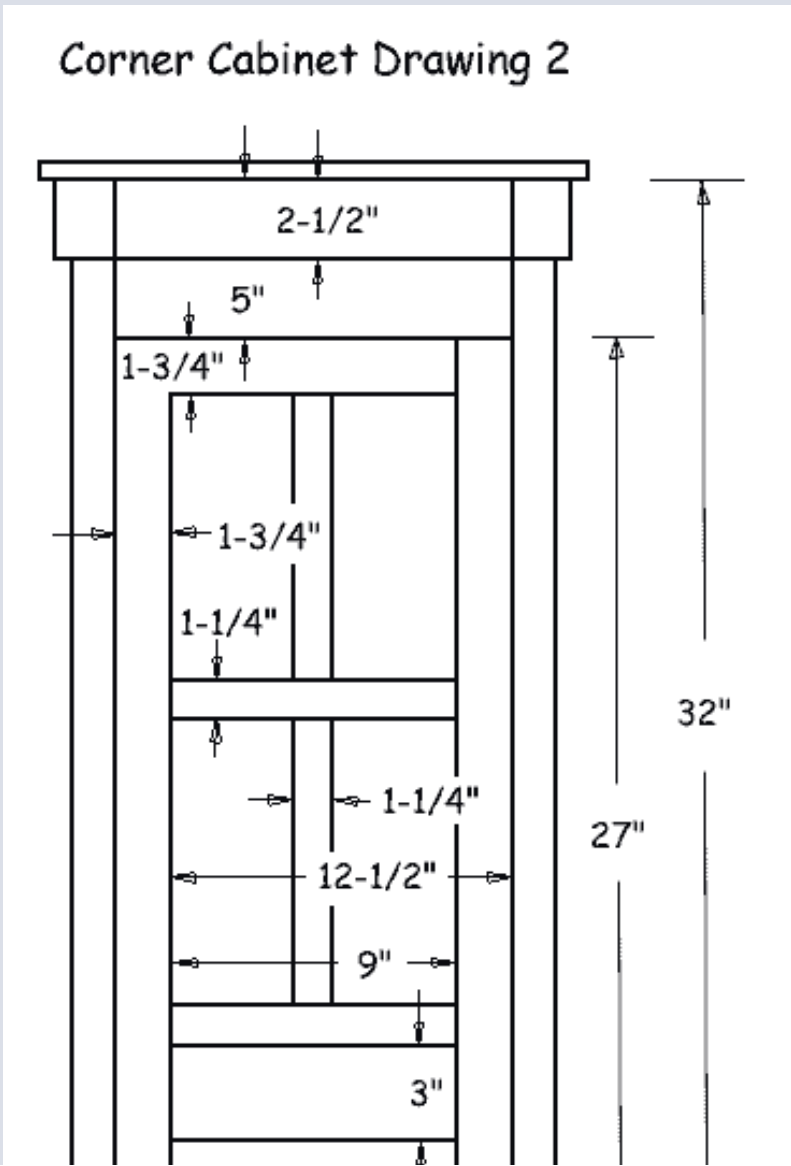
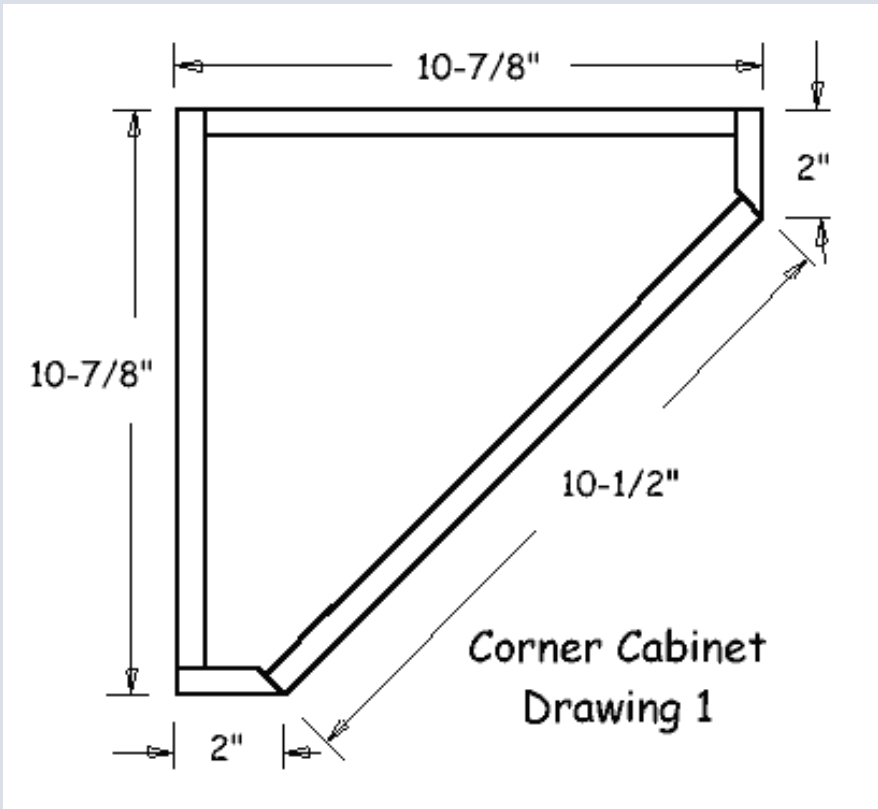

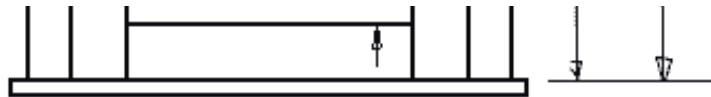

Corner Cabinet Drawing 3 Making The Top, Bottom and Shelves

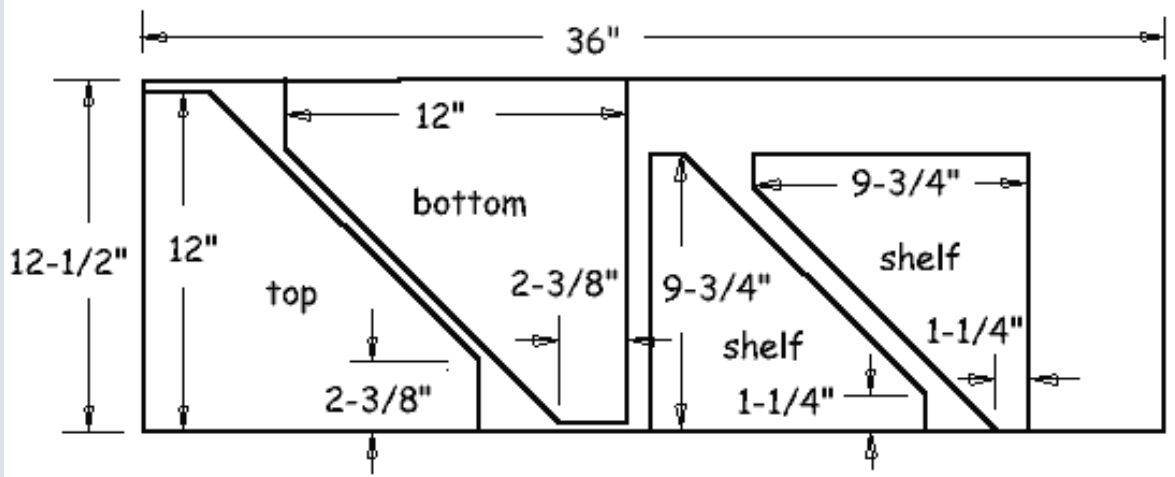

Tools and Hardware Resources

[Clamps](#) | [Plate Joiners](#) | [Table Saws and Accessories](#) | [Dado Sets](#) | [Miter Gauges](#) | [Carving Tools](#) | [Tapered Drill Bits](#) | [Hand Drills](#) | [Router Tables](#) | [Router Bits](#)

A good source of carving tools as well as hardware is [Woodcraft](#). Also try [Whitechapel](#) for hardware.



[Pipe Clamps](#)

[One of the most versatile clamps, because you can use them with pipe of any length.](#)



[Porter Cable Deluxe Biscuit Joiner](#)

[Biscuit joiners are useful for many joinery tasks.](#)

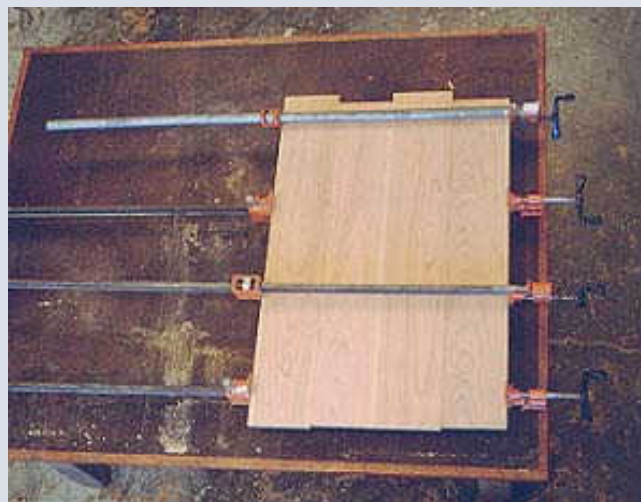

Photo 1- Edge-glue boards together to get the widths required. I use a biscuit joiner to put biscuit splines between the boards to keep them lined up at the glue up. Dowels can serve the same function, or run a groove down each edge at the table saw and fit in a spline. Aligning the boards flush to each other without anything to keep them there is not too difficult, but generally just a pain in the neck. When you adjust one it throws the other out of whack. Refer to Murphy's Law.

If you need clamps, [click here](#).

If you are considering buying a biscuit joiner, [click here](#).

GETTING STARTED

Begin by edge gluing boards to get the wide parts (photo 1); the backs, the top and bottom, and the two shelves. The latter four are all triangles and can be nested on one piece to save stock. If you don't

have a planer to make the 1/2" stock required, try visiting a local cabinet shop and offer to pay them to do it. For a lengthy treatment on making thin stock on this site [click here](#).

DOOR



Photo 2- These grooves serve both as mortises for rails and grooves for panels. If your stock is not uniform in thickness, don't flip faces as the text says, because the groove will vary as the thickness does. In this case, always keep the same part face against the fence in all passes and make careful adjustments of the fence location using test pieces to ensure that the groove is as close to centered as possible.

If you are considering buying a table saw or blade, [click here](#).

Make and assemble the door before carving it. This is a frame and panel door, with solid panels held in grooves in the surrounding frame parts. The frame joinery is a form of mortise and tenon which can be done entirely on the table saw. First get out your stock, all of which is 1/2" thick. Cut grooves at 3/8" deep by 3/16" wide on the saw as in photo 2. Do so on the inside edges of both stiles and the top and bottom rails, as well as both edges on the midrails and mullions (the vertical separators between panels).

Your table saw's dado set probably won't go as small as 3/16", so cut the grooves with your regular blade, making two passes. Set the blade at 5/32" from the fence, make one cut, then reverse the part so the opposite face is against the fence and cut again. The result is a 3/16" groove that is well centered. But note that this technique works best when the stock is very uniform in thickness (see photo 2 caption).



[Sure Lock Miter Gauge](#)
With fence and flip stop.



Photo 3- Cutting these tenons will go faster if you have a dado cutter for your table saw, but you can do just fine with a regular combination blade. If your stock varies in thickness you must use a different setup for your thinner and thicker parts. Try this- run all parts at a setup that works for the thinnest rails, then customise the tenons on the thicker ones until they fit.

If you are looking for a dado set, [click here](#).

If you are looking for a miter gauge, [click here](#).



[6" Carbide Dado Set](#)
Economical Freud dado set.

Now set the fence at 3/8" from the outside of the blade, and lower the blade to less than 1/8" above the table. Put your miter fence on the saw, and screw a backup piece onto the fence as in photo 3. Cut the tenons on the rails and mullions as shown in the photo. First make a test cut, and make multiple passes to cut out the waste. With the blade at less than 1/8" high above the table, the resulting tenon will be too thick. Raise the blade a hair and cut again, and fit again, and continue until the tenon is brought to

Rockler.com
WOODWORKING
SUPERSTORE

Search from over
9000 products!

a snug fit with the grooves. The resulting joints will appear as in photo 4.



Photo 4- The finished joints will appear as shown. This is a small joint, but then it's a small door. Still, it's important to get a good fit between the tenons and the mortise grooves for a good glue bond.

To guarantee a good glue bond with these joints, its best to clamp the groove walls onto the tenons with C-clamps and glue blocks. But you can't do this on the center joints if you glue up the door all at once because the panels are in the way, so do the glue up in two stages. Before you put the panels in the frame, indeed before you make them, glue together the mullions to the rails (except the bottom rail) as in photo 5. Carefully center the mullions in the grooves on the rails. Note in the photo that one of the stiles is located on the ends of the rails. It is dry fitted there during this primary glue up for the sole purpose of aligning the parts.



C-Clamps

[Various different sizes.](#)



Photo 5- Glue the central dividers (mullions) to the rails before making the panels and gluing up the whole door. Carefully center them on the rails. The long stile is not glued to the rails in this photo, it's just there for alignment. The C-clamps squeeze the mortise walls onto the tenons for a good glue bond. They don't need to be very tight, just light pressure.

If you are looking for C-clamps, [click here.](#)

Once these parts are out of clamps, dry assemble the door with all the frame parts and carefully measure the sizes of the openings for the panels. On the one hand you want the panels to fit perfectly in the openings so the door appears as one flat surface with a minimum of gaps, on the other hand you have to leave some room for the panels to expand and contract in the openings. Subtract a fat 32nd from the opening sizes for the panel sizes along the panel widths, and 1/64th along their lengths.

The actual panel sizes, however, are larger than these openings by the width of the tongues you put on the panels. Add 1/2" to all the dimensions you came up with from the openings to make 1/4" tongues all around. Get out your panels according to this list.



Photo 6- Cutting the panel tongues on the panels. The height of the cutter is going to determine the exact fit of the panels in the door frame parts. Test fit them while you have the setup going so you can make adjustments if necessary. Leave some room along the panel width for moisture related expansion.

Cut the tongues on the panels with a table saw setup much like the one you used for the grooves, except this time you cut to the outside rather than to the inside, and you can set up a dado to do it as in photo 6. The 2x4 clamped to the table in that photo is strictly a safety device. Since on this cut the blade is to the outside of the work, and since the parts are small and you must apply firm pressure against the fence for accuracy, this fence is a good idea to prevent your fingers from slipping into the blade.

First use a test piece the same thickness as your panels and cut the tongue too thick to start, then move the fence a hair for a thinner tongue until you get a tongue that is an easy- but not loose- fit in the groove.

Adjust the height of the blade to 1/4". This adjustment determines the final fit of the panel shoulders in the door frame, and this is what you see on the finished door. So start with the height at just less than 1/4", then dry fit the panel to see how it lines up. Raise the blade and take off more if necessary.



Photo 7- Gluing up the door. Wet out the parts, put on the bar clamps, then the C-clamps, then remove the bar clamps. Before you put on the C-clamps, be sure the door is flat.

Put the panels in their grooves and glue the rails onto the stiles. Pull the stiles together with bar clamps (no need to clamp very hard) and then apply C-clamps as before with blocks to bring the groove walls solidly onto the tenons (photo 7). Once the C-clamps are on you can remove the bar clamps.

This is Page 1 of this project.

[Go to Page 2.](#)

[Go to Page 3.](#)

[Home](#) | [Free Plans](#) | [Links](#) | [Newsletters](#) | [Tool Store](#) | [Book Store](#) | [Interviews](#) | [Contact & About](#) | [Safety](#)

You are visitor number 125485 to this page.

Jeff Greef Woodworking

See more [Project Plans](#) | Sign up for [Email Notices](#) of new projects

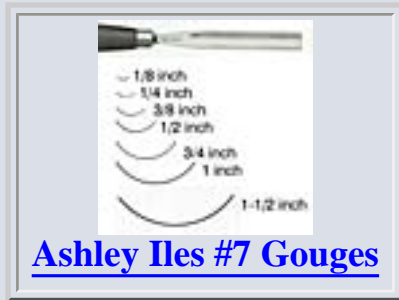

To see more *Furniture Plans* on this site, go to:
[Printed Furniture Plans](#) or [Downloadable Furniture Plans](#) or
[Furniture Plan Books](#)

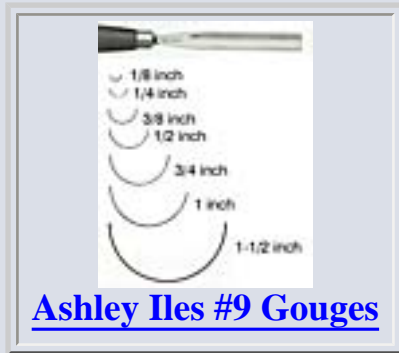

Page 2, Corner Cabinet

[Go back to Page 1.](#)

[Go to Page 3.](#)

[Tell Your Friends](#)
about this page. [Click here](#)
to send an email.
[Thank You!](#)

CARVING

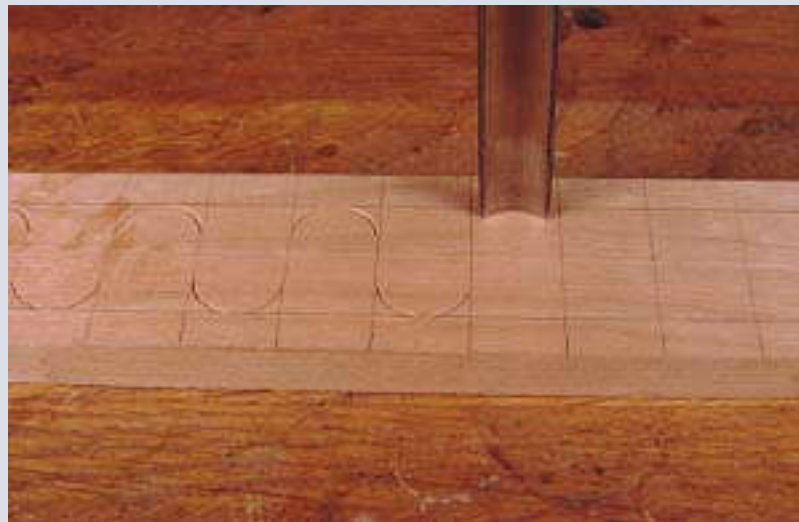

Photo 8- Using a carving gouge to establish the half circles in the carving design.

If you are looking for carving tools, [click here.](#)

While the door is drying start the carving on the front side pieces. Rip them to width, cut to length, then get out your carving tools. Before you lay out the "S" pattern of this design, you need to know what chisel you will use to make it. The pattern depends on the diameter of the half circle cut by the gouge you use. My #8 by 5/8" gouge has a

diameter of 3/4", so I marked out spaces at that dimension as in photo 8. But you could use one with a greater or lesser diameter to suit your tooling or your desires.

Mark out the spaces between half circles as described above, and also scribe two longitudinal lines 1/2" from each edge to establish the lateral position of each half circle. Begin carving by cutting half circles within your scribe marks as shown in photo 8. Cut down to a depth of 1/16" or so. Make this entire series of cuts on both pieces before you go ahead with the next step of clearing out the waste in each half circle. The only reason for this is efficiency; it will take less time if you are not switching from chisel to chisel at each half circle. This kind of methodical carving with a repeating design is called running carving and can be done with an infinite number of designs.



[Blue Chip Bevel Edge Chisels](#)
[Good set of basic bench chisels.](#)

Rockler.com
WOODWORKING
SUPERSTORE

**Search from over
9000 products!**



Photo 9- Connect the half circles with a straight bench chisel. Angle these cuts to follow the slope of the design.

Once the half circles are cut, use a regular bench chisel to connect their ends as in photo 9. Angle the chisel toward the half circle, to follow the angle of the final surface which slopes down toward the half circle. Point the bevel of the chisel toward the waste, because the flat of the chisel leaves a cleaner edge, and it is the edge not wasted away that will be seen.

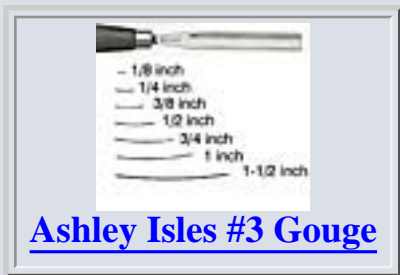

Photo 10- Make a sloping cut down into each of the half circles as shown.

Finally use a gouge with a very shallow arc to waste away the material inside the half circles, and between the bench chisel cuts (photo 10). My #3 by 1/2" gouge did the job well. Sharpen this chisel to its best, because you are cutting across the grain and the sharper it is, the smoother the finished surface will be. Slope the cut down toward the half circle, and dish it out following the radius of the gouge you use.

When the door is out of clamps, trace a vinelike design onto it, such as in the photos. Note that this design goes on the panels only, and not on the frame parts. Also, this design stays within 1/4" of the edge of the panels, to avoid chipping the edges as you carve. Sketch out your own design if you find the inspiration, and it needn't be cut only within the panels.



Photo 11- Sketch a tree or vine trunk at the bottom panel, and extend its branches up into the higher panels. Sketch and erase until you have a pleasing pattern. Then carefully outline the pattern as shown.

Use a #12 or #15 V-parting tool to outline the vines as in photo 11. Again, sharpen the tool well for best results, because as you cut directly across the

grain, a dull tool will push and crush the fibers rather than sever them. Work slowly and coax the tool through the wood rather than forcing it quickly- you may find that it will jump ahead of you, beyond the pattern!



Photo 12- Texture the background around the branches with parallel lines. Go slowly and gently so you don't slip ahead farther than you intended.

With the outline finished, cut the parallel grooves between the vines which provides a textured background (photo 12). Again go carefully or the tool may slip and cut through a vine. I confess this happened to me once or twice (okay- three times!) but it was easily repaired by gluing back in the small chip that was cut out. Note that the grooves follow the grain direction of the panel, so that the grooves on the bottom panel are horizontal whereas elsewhere vertical.

CARCASE



Photo 13- Make a shallow reference groove where the carcass parts join so that when you put it together the parts have a shoulder to sit against, keeping them in alignment.

Cut the 45o angle on the inside edge of the two front side pieces. This is just as easily done on a jointer as a table saw. Then get out the two backs, cut to length and rip to width. Set up the table saw to cut a very shallow rabbet in the side pieces and in one of the backs where the pieces butt together. Make this rabbet 1/2" wide, and only 1/32" or so deep (photo 13). The sole purpose of this rabbet is to help you locate the butt joint during assembly. Otherwise the parts would slip all over with glue in there. Be careful that the blade doesn't burn the wood in the rabbet, because that is the glue surface and glue doesn't stick very well to burnt wood.



[Bessey Power Grip
Clamps](#)



Photo 14- You'll need an armful of barclamps to glue on the side pieces as shown. If you don't have this many, do one at a time, or use no clamps and attach them with glue and nails. Pre- drill for the nails in this case so the wood doesn't split, and use small-headed finish nails.



[Tapered Drill Bits
With Countersinks](#)

If you need bar clamps such as those shown, [click here](#).



[Black and Decker 3/8"
Drill
Your basic hole
puncher.](#)

Glue the two backs together. Use nails to hold them together. If your cabinet is made of hardwood, predrill holes for the nails, much as you would for screws, to prevent splitting. Softwood like pine may not require holes. With the nails in place you don't have to wait for the glue to dry before you do more assembly, so glue and clamp on the front side pieces as in photo 14. No nails here- you don't want any nail holes next to your nice carving! Use clamping strips between the clamps and the front side pieces to prevent the clamps damaging the surface.



Photo 15- There's a screw block under all those chips from the drill bit! With any screw block it helps to bore out the holes before you go to assembly. This extra step makes the assembly procedure a joy instead of a nightmare.

If you need tapered drill bits with counter sinks, [click here](#).

If you need a hand drill, [click here](#).

Make 16- 1/2" x 1/2" x 2" screw blocks for securing the top, bottom, and shelves. Drill two screw holes with countersinks through one face of each block as in photo 15. Then mark out the location of each block on the inside of the carcass. One by one place each block in position and mark the location of its screw hole with a pencil placed in the hole. Why not just put the block in place and drill a hole through block and carcass at once? Because the bit will make the block wander all over the place and it won't get located correctly. After marking out the location of the holes, drill an appropriately sized hole on the mark and screw down the block (photo 16).

This is Page 2 of this project.

[Go to Page 3.](#)

[Go to Page 1.](#)

[Home](#) | [Free Plans](#) | [Links](#) | [Newsletters](#) | [Tool Store](#) | [Book Store](#) | [Interviews](#) | [Contact & About](#) | [Safety](#)

You are visitor number 13134 to this page.

[Tell Your Friends](#)

[about this page. Click here](#)
[to send an email.](#)
[Thank You!](#)

Jeff Greef Woodworking

See more [Project Plans](#) | Sign up for [Email Notices](#) of new projects

To see more *Furniture Plans* on this site, go to:
[Printed Furniture Plans](#) or [Downloadable Furniture Plans](#) or
[Furniture Plan Books](#)



[Cutoff Box](#)

Order Print Plans

Click photo for details.
[More printed plans.](#)



Page 3, Corner Cabinet

[Go back to Page 2.](#)

[Go back to Page 1.](#)



Photo 16- Put the screw blocks in place, and use the holes in them to mark the location of the screws in the carcass. Put a nail in the hole and tap in with a

hammer enough to leave a mark. Remove the block and nail, drill for the screw, then install the block. You need to do some tests to determine the optimum hole size and depth for your screws. A piece of masking tape on the drill bit shows you how far to bore down.

The front plate that goes above the door gets glued to two special glue blocks attached to the inside of the two front side pieces (see drawing). Cut a 45o angle into these for the front plate to contact, and glue these onto the front side pieces using the front plate itself as a guide to show where to locate the blocks. Then, let the blocks dry without the front

plate in place. You'll need it to be out of the way for more clamps on the blocks. When the blocks are dry, glue in the front plate. This is a challenge because there are no good surfaces for bar clamps to contact and you can't get in from behind with screws. Band clamp to the rescue! Photo 17. Place a piece of scrap over the front plate so the pressure from the band is applied on the front plate itself and not on the inner edges of the side pieces.



[Web Clamps](#)

Rockler.com
WOODWORKING
SUPERSTORE

Search from over
9000 products!



Photo 17- A band clamp (also called strap or web clamp) is the ideal tool for clamping odd shapes like this. The C-clamp just held the spacer in place while the band clamp was installed. An alternative to a

band clamp is nylon string. It stretches a bit, so if you wrap it tightly around the piece numerous times the combined wrappings can apply adequate pressure for a good glue bond.

If you need band clamps, [click here](#).

Make the molding for the top, using whatever router bit pattern you choose, then cut to fit and glue in place (once the top plate is out of clamps!). To determine the exact size of the top and bottom, place the cabinet on the stock for these pieces and trace the outer edge of the cabinet onto the stock. Add 1/2" along the leading edges. Measure the sizes for the shelves and trace them too. Nest the triangles on your stock for maximum stock use. Cut out the top and bottom pieces, and the shelves, with a band saw or hand saw. Clean up this edge with a block plane. Rout an ogee or other pattern into the exposed edges of the top and bottom on the router table as in photo 18.



Rockler Router Table Package

Includes table top with quality fittings, adjustable fence AND Porter Cable 690 Router. Good deal.



Ogee Router Bits



Rockler Bench Top Router Table

Mount your router into this economical unit.



C-Clamps

Various different sizes.



Photo 18- Rout a pattern in to the top edge. Make sure you make the top large enough that the pattern is beyond the top mold pieces.

If you need a router table, [click here](#).
For a selection of router bits, [click here](#).

Clamp the top and bottom in place, drill holes through the blocks and install screws. Make and install two small stops for the door, as in photo 19, to prevent it from closing too far in. Cut out mortises for your hinges, and note that you will have to angle the screws that hold the hinge leaves to the side piece, otherwise they will come out on the face. The angled screw heads will stick up a bit, so get hinges that have a fair distance between leaves when in closed position. Install whatever knob and catch you prefer, such as a small ball catch.



Photo 19- Two little custom fitted door stops, one at the top and one at the bottom, will prevent the door from swinging in too far.

Use a good quality finish for an ornate cabinet such as this. I used orange

shellac, a one pound cut with three or four coats. The orange hue it leaves goes nicely with the cherry. Wipe-on oil, such as Watco, is a good choice here too because the cabinet will not get a lot of wear like a table top would. Be careful not to allow the finish to puddle in the carvings.

This is Page 3 of this project.

[Go to Page 2.](#)

[Go to Page 1.](#)

Tools and Hardware Resources

[Clamps](#) | [Plate Joiners](#) | [Table Saws and Accessories](#) | [Dado Sets](#) | [Miter Gauges](#) | [Carving Tools](#) | [Tapered Drill Bits](#) | [Hand Drills](#) | [Router Tables](#) | [Router Bits](#)

A good source of carving tools as well as hardware is [Woodcraft](#). Also try [Whitechapel](#) for hardware.

[Home](#) | [Free Plans](#) | [Links](#) | [Newsletters](#) | [Tool Store](#) | [Book Store](#) | [Interviews](#) | [Contact & About](#) | [Safety](#)

You are visitor number 7884 to this page.



[Home](#) | [Free Plans](#) | [Links](#) | [Newsletters](#) | [Tool Store](#) | [Book Store](#) | [Interviews](#) | [Contact & About](#) | [Safety](#)

Jeff Greef Woodworking

Tool Store

[Go to Tool Store Index](#)

Router Table

Scroll down to see the router tables for sale.

You can build your own router table, so why buy one? Well, they work right out of the box so you can go straight to your project. As well, they are made out of very solid materials machined flat and straight so accuracy is easier. I've always been able to tweak what I need out of a shop-made router table, but off-the-shelf tables like these take less tweaking. They won't eliminate the need to adjust and test, but they will reduce the time it takes to get what you want.

An alternative is to make your own table using a premade base such as shown below. The point at which the router and bit meet the table plane is the critical area for accuracy, so buying a specially made product that addresses these needs will make your shop-built router table easier to use. The base shown is very rigid, has a slight crown to ensure that the wood being cut is always on the table at the point of cut, and has center ring inserts to make the hole larger or smaller as required.

CLICK THE PHOTO TO ORDER THE TOOL



Porter Cable 691RS
The Ultimate Router
Workshop
Expensive but complete
package with router,
bases, machined
aluminum table and
accessories



Porter Cable 698XXX
Router Table without
Motor
Just the table, miter
gauge and fence. Takes
your router



Woodstock
International W2000
Rebel Router Table
Solid cast aluminum
construction

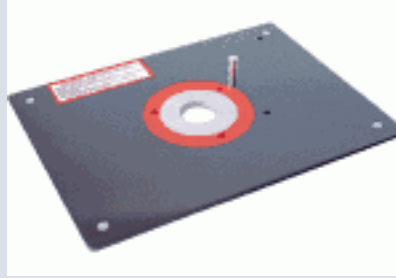

Rousseau RM3509 9" x
12" x 1/4" Deluxe
Router Base Plate
Build your own table
with this at the center



Rockler
Folding
Router Table

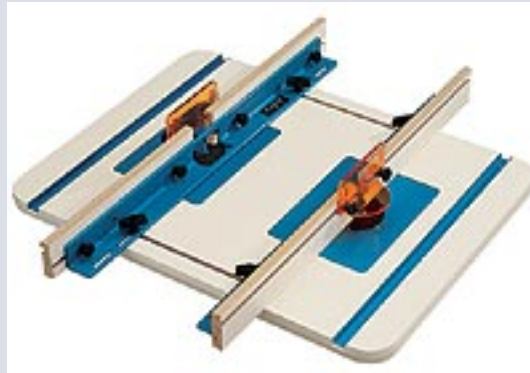

Rockler
Double Router
Table





Rockler Bench
Top Router
Table



Rockler
Router Table
Package



Rockler
Router Table
Extensions



Rockler
Router Table-
designed to
work with the
Rout-R-Lift
Plate
mechanism.

More Router Tables

See a larger selection of router tables and accessories at Amazon.com by [clicking here](#).

Search Rockler for Tools

Search Amazon for Tools

Search Corner Hardware
for Tools and Hardware

Rockler.com
WOODWORKING
SUPERSTORE

Search from over
9000 products!

Search by keywords:

amazon.com

CornerHardware.com

[Home](#) | [Free Plans](#) | [Links](#) | [Newsletters](#) | [Tool Store](#) | [Book Store](#) | [Interviews](#) | [Contact & About](#) | [Safety](#)

You are visitor number 32037 to this page.





amazon.com



VIEW CART

WISH LIST

YOUR ACCOUNT

HELP



Your Gold Box

WELCOME

YOUR STORE

BOOKS

APPAREL & ACCESSORIES

ELECTRONICS

TOYS & GAMES

HOME & GARDEN

TOOLS & HARDWARE

SEE MORE STORES

BROWSE BRANDS & PRODUCTS

TOP SELLERS

POWER TOOLS

ACCESSORIES

FREE CATALOG

GIFT IDEAS & WEDDING REGISTRY

TODAY'S DEALS

OUTLET, USED & RECONDITIONED

Search:

Browse:



[Home & Garden](#) > [Tools & Hardware](#) > [Categories](#) > [Power Tools](#) > [Accessories](#) > [Router Accessories](#) > **Tables**

Page: 1 | **2** | 3 >>

Sort by:

Search in Tables:



[Porter-Cable 698XXX Router Table without Motor](#)

Availability: Usually ships within 1 to 2 days

SALE
List Price: \$266.00
Price: **\$109.99**
You Save: \$156.01 (59%)



[Bench Dog RT250 Router Table for Table Saws](#)

Availability: Usually ships within 1 to 2 days

Price: **\$299.99**



[Bench Dog RT100 ProTop Portable Router Table](#)

Availability: Usually ships within 1 to 2 days

List Price: \$229.95
Price: **\$199.99**
You Save: \$29.96 (13%)



[Bench Dog FTB400 Complete Router Table System](#)

Availability: Usually ships within 1 to 2 days

List Price: \$500.00
Price: **\$399.99**
You Save: \$100.01 (20%)



[Triton RTA300K 27" x 22" Router Table](#)

Availability: Usually ships within 1 to 2 days

List Price: \$329.00
Price: **\$319.99**
You Save: \$9.01 (3%)



[Freud PKG0024 Router Top System](#)

Availability: Usually ships within 1 to 2 days

List Price: \$440.00
Price: **\$389.99**
You Save: \$50.01 (11%)

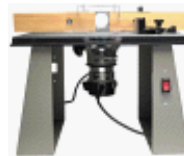

[Porter-Cable 691RS The Ultimate Router Workshop](#)

Availability: Usually ships within 1 to 2 days

Price: **\$279.99**



[Porter-Cable 6961 Stand for 697 or 698 Router Tables](#)

Availability: Usually ships within 1 to 2 weeks

Price: **\$44.99**



[JessEm LIFT-I 4-Piece Insert Ring Set \(1/4", 1/2", 1-3/16", and 2-1/2"\)](#)

Availability: Usually ships within 1 to 2 days

Price: **\$24.99**



[JessEm LIFT1 Rout-R-Lift](#)

Availability: Usually ships within 1 to 2 weeks

List Price: \$249.99
Price: **\$199.99**
You Save: \$20.00 (9%)



[Jasper 500J Model 500 Base Plate Adaptor](#)

Availability: Usually ships within 1 to 2 weeks

List Price: \$45.99
Price: **\$12.99**
You Save: \$3.00 (19%)



[Bench Dog AI-DM175 DeWalt/Fein/Makita Router Top Insert Plate](#)

Availability: Usually ships within 1 to 2 weeks

Price: **\$29.99**



[Oak Park RW20001 Router Workshop](#)

Availability: Usually ships within 1 to 2 days

List Price: \$389.39

Price: **\$329.99**

You Save: \$59.40 (15%)



[Skil 14651 Router and Router Table Combo](#)

Availability: Usually ships within 1 to 2 days

List Price: \$139.99

Price: **\$99.99**

You Save: \$40.00 (29%)



[Oak Park BP20051 Router Base Plate 11" with Pin](#)

Availability: Usually ships within 1 to 2 days

Price: **\$35.69**



[Woodstock International W2000 Rebel Router Table](#)

Availability: Usually ships within 1 to 2 days

List Price: \$229.95

Price: **\$189.99**

You Save: \$39.96 (17%)



[Oak Park BP20059 Router Base Plate 11" with Pin](#)

Availability: Usually ships within 1 to 2 days

Price: **\$35.69**



[Oak Park RPO32 Router Raised Panel System \(B\)](#)

Availability: Usually ships within 1 to 2 days

Price: **\$329.99**



[Rousseau MM2515 Router Table Attachment](#)

Availability: Usually ships within 24 hours

List Price: \$149.00

Price: **\$129.99**

You Save: \$19.01 (13%)



[Bosch RA1180 Benchtop Router Table](#)

Availability: Usually ships within 1 to 2 days

REBATE

List Price: \$400.00

Price: **\$249.99**

You Save: \$150.01 (38%)

Related Categories

- [Home & Garden](#) > [Tools & Hardware](#) > [Brands](#) > [Rousseau](#) > [Router Tables](#)
- [Home & Garden](#) > [Tools & Hardware](#) > [Brands](#) > [Bench Dog](#)

Where's My Stuff?

- Track your [recent orders](#).
- View or change your orders in [Your Account](#).

Shipping & Returns

- See our [shipping rates & policies](#).
- [Return](#) an item (here's our [Returns Policy](#)).

Need Help?

- Forgot your password? [Click here](#).
- [Redeem](#) or [buy](#) a gift certificate.
- [Visit our Help department](#).

Search for

[Top of Page](#)

[Browse Brands & Products](#) | [Top Sellers](#) | [Power Tools](#) | [Accessories](#) | [Free Catalog](#) | [Gift Ideas & Wedding Registry](#) | [Today's Deals](#) | [Outlet, Used & Reconditioned](#)

[Amazon.com Home](#) | [Directory of All Stores](#)

Our International Sites: [Canada](#) | [United Kingdom](#) | [Germany](#) | [Japan](#) | [France](#)

[Contact Us](#) | [Help](#) | [Shopping Cart](#) | [Your Account](#) | [Sell Items](#) | [1-Click Settings](#)

[Investor Relations](#) | [Press Releases](#) | [Join Our Staff](#)

Bottom of the Page™ Deals for November 24

Amazon.com = low prices. Save up to 50% on these one-day-only deals.

	Our Price	You Save
SOLD OUT FOR TODAY Tazo China Green Tips, Green Tea, Loose Bulk, (16-Ounces) A traditional green tea with a delicate taste.	\$26.99	
Memorex DVD-R 50 Pack Spindle 4x Ideal for premastering, high-volume data recording, and archiving.	\$64.99	\$55.00 (46%)
SOLD OUT FOR TODAY Duracell Coppertop AAA Batteries (84 Batteries) Stock up and save on advanced-performance Duracell Coppertop batteries.	\$35.97	
Strait-Line 64001 Laser Level The laser guide line tool every do-it-yourselfer needs!	\$31.99	\$52.01 (62%)
Pepcid Complete Antacid, Mint-Flavored 2 Pack, 150 Chewables Pepcid Complete--a single tablet delivers long-lasting heartburn relief.	\$39.99	\$34.90 (47%)
Starbucks Espresso Roast Universal Ground Coffee, 6 12-Ounce FlavorLock Bags (72 ounces total) Start the day off right with this mild, flavorful breakfast blend.	\$28.78	
Metabolife Ephedra Free Formula to Enhance Energy (400 Tablets) Boost energy the healthy, safe way with ephedra-free Metabolife.	\$79.99	\$44.41 (36%)
Calphalon Tri-Ply Stainless-Steel 3-Quart Sauté Pan This stainless-steel Calphalon pan cooks as good as it looks.	\$27.99	\$104.01 (79%)
Singer 132Q 32-Stitch Function Sewing Machine Compact and convenient, this machine's perfect for a designer on the go!	\$159.99	\$100.01 (38%)

 **FREE Super Saver Shipping on orders over \$25.** [See details.](#)

Amazon.com now offers bargains on brand-name essentials, all priced so low they've sunk to the bottom of the page! We take up to 50% off standard retail prices and deliver right to your door--no club fees, no hassle, no parking lot. These offers are only good until they're gone, and only for today. Check back tomorrow for all-new Bottom of the Page™ Deals.

800-279-4441

CATALOG QUICK ORDER | RETAIL STORES | FREE CATALOG | CAREERS | ABOUT US

DEPARTMENTS

- Hardware
- Tools
- Wood
- Plans & Books
- Finishing
-
- New Products
- Special Order Program
- Clearance
- Complete Product Index

PROJECTS

- Holiday Projects 
- Home Office
- Entertainment Centers
- Kitchen
- Furniture
- For your Shop
- Small Projects
- Outdoor

Stay Informed!
Sign up for our
**Log-On
Newsletter**

CLICK HERE
TO SIGN UP!

**\$ Become an
Affiliate**

[Tools](#) → [Rockler's Exclusive Product Line](#) → [Rockler Router Tables and Package Options](#)

Rockler Router Table With Folding Legs

Who says you can't take it with you?

[See details below](#)



[View Large Image](#)

Order Form:

Router Table and Stand:				
Quantity	Part Number	Item	Stock Status	Price
	21986	Rockler Router Table with Porter Cable 7529/690/693 Plate and anodized aluminum fence	In Stock	\$195.99 Each
	21995	Rockler Router Table with Porter Cable 7518/7539 Plate and anodized aluminum fence	In Stock	\$195.99 Each
	22007	Rockler Router Table with DeWalt 621 Plate and anodized aluminum fence	In Stock	\$195.99 Each
	23690	Rockler Router Table with Craftsman Standard Plate and anodized aluminum fence	In Stock	\$195.99 Each

	23701	Rockler Router Table with Craftsman Plunge and HD Plate and anodized aluminum fence	In Stock	\$195.99 Each
	22027	Rockler Router Table with Blank Plate and anodized aluminum fence	In Stock	\$195.99 Each
Stand Only:				
Quantity	Part Number	Item	Stock Status	Price
	24203	Tool Stand	In Stock	\$35.99 Each

More details for Rockler Router Table With Folding Legs



Holds up during use, folds up for transporting or stowing.

Now our exclusive Router Table and Fence System comes with a sturdy "Rugged Buddy" tool stand made of tubular steel with skid-proof rubber feet.

See our complete description of our [MDF Router Table](#) with anodized aluminum fence.

[Buy Now Using Form Above](#)

People who bought Rockler Router Table With Folding Legs also purchased:



[Rockler's #1 Router Table Package](#)

[Back to Top](#)

To link to this page, please use the following url:

<http://www.rockler.com/findit.cfm?page=5500>

[Tools](#) → [Rockler's Exclusive Product Line](#) → [Rockler Router Tables and Package Options](#)

Rockler Partner Link: [Return to Jeff Greef Woodworking](#)

Shop Online: [Home](#) · [Product Index](#) · [Search](#) · [Catalog Quick Order](#)

Customer Service: 1-800-279-4441 · [Help Page](#) · [Privacy Statement](#) · [Contact Us](#)

Other Pages: [Retail Stores](#) · [Free Catalog](#) · [Careers](#) · [About Us](#)

Daily Deals for November 24, 2003

	Reg Price	Sale Price	You Save
Cape Cod Blue - Legendary Colors Of Our Early History	\$15.99	\$5.99	63%
3-Pc. Japanese Chisel Set	\$79.99	\$59.99	25%
Sittin' Pretty Santa	\$13.95	\$9.99	28%

Visit Our Partner Sites:



This is a [Secure Shopping Site](#)



TESTED DAILY 24-NOV

[Copyright](#) © 2003, Rockler Companies, Inc.

800-279-4441

CATALOG QUICK ORDER | RETAIL STORES | FREE CATALOG | CAREERS | ABOUT US

DEPARTMENTS

- Hardware
- Tools
- Wood
- Plans & Books
- Finishing
-
- New Products
- Special Order Program
- Clearance
- Complete Product Index

PROJECTS

- Holiday Projects 
- Home Office
- Entertainment Centers
- Kitchen
- Furniture
- For your Shop
- Small Projects
- Outdoor

Stay Informed!
Sign up for our
Log-On
Newsletter

CLICK HERE
TO SIGN UP!

\$ Become an
Affiliate

[Tools](#) → [Rockler's Exclusive Product Line](#) → **Rockler Router Tables and Package Options**



Rockler's #1 Router Table Package



Super Combo! Plunge Router & Table Package



Rockler Router Table with PC690 Router Combo Package



Benchtop Router Table with 1-1/2 HP Router Motor Combo



Mast-R-Lift & Table & Fence



Large Plate Router Table & Fence Package



Rockler Benchtop Router Table



Rout-R-Lift Mechanism and Rockler Router Table



Rockler Double Router Table



[Rockler Router Table Extensions](#)



[Rockler Router Table With Folding Legs](#)

Rockler Partner Link: [Return to Jeff Greef Woodworking](#)

Shop Online: [Home](#) · [Product Index](#) · [Search](#) · [Catalog Quick Order](#)

Customer Service: 1-800-279-4441 · [Help Page](#) · [Privacy Statement](#) · [Contact Us](#)

Other Pages: [Retail Stores](#) · [Free Catalog](#) · [Careers](#) · [About Us](#)

Daily Deals for November 24, 2003

	Reg Price	Sale Price	You Save
Classic Humidor Plan	\$12.99	\$0.99	92%
Glowing USA Flag Plan	\$13.95	\$0.99	93%
Beveled Glass Panel Kit	\$51.99	\$39.99	23%

Visit Our Partner Sites:



This is a [Secure Shopping Site](#)



[Copyright](#) © 2003, Rockler Companies, Inc.

SEARCH:

Search by Keyword or Item Number



800-279-4441

CATALOG QUICK ORDER | RETAIL STORES | FREE CATALOG | CAREERS | ABOUT US

DEPARTMENTS

- Hardware
- Tools
- Wood
- Plans & Books
- Finishing
-
- New Products
- Special Order Program
- Clearance
- Complete Product Index

PROJECTS

- Holiday Projects
- Home Office
- Entertainment Centers
- Kitchen Furniture
- For your Shop
- Small Projects
- Outdoor

Stay Informed!
Sign up for our
**Log-On
Newsletter**

CLICK HERE
TO SIGN UP!

**\$ Become an
Affiliate**

[Tools](#) → [Rockler's Exclusive Product Line](#) → [Rockler Router Tables and Package Options](#)

Rockler Router Table Extensions

Add space to your current router set-up
— even in smaller workshops!



[See details below](#)



[View Large Image](#)

Order Form:

Best Value Packages!:				
Quantity	Part Number	Item	Stock Status	Price
	23223	23-1/2" X 27" with Fence and Porter Cable 7529/690/693, Bosch 1617/1618 Plate	Back Ordered	\$169.99 Kit
	23398	23-1/2" X 27" with Fence and Porter Cable 7518/7539 Plate	Back Ordered	\$169.99 Kit
	23405	23-1/2" X 27" with Fence and DeWalt 621 Plate	Back Ordered	\$169.99 Kit
	23426	23-1/2" X 27" with Fence and Blank Plate	Back Ordered	\$169.99 Kit
	23589	23-1/2" X 27" with Fence Craftsman (1-1/2HP or less) Plate	Back Ordered	\$169.99 Kit

	23646	23-1/2" X 27" with Fence Craftsman HD/Plunge Plate	Back Ordered	\$169.99 Kit
Table Only:				
Quantity	Part Number	Item	Stock Status	Price
	23356	23-1/2" X 27" with Porter Cable 7529/690/693 Plate without fence. *See more router options below	Back Ordered	\$109.99 Kit
	23370	23-1/2" X 27" with DeWalt 621 Plate without Fence	Back Ordered	\$109.99 Kit
	23384	23-1/2" X 27" with Blank Plate without Fence	Back Ordered	\$109.99 Kit
	23597	23-1/2" X 27" with Craftsman (1-1/2HP or less) Plate without Fence	Back Ordered	\$109.99 Kit
	23659	23-1/2" X 27" with Craftsman HD/Plunge Plate without Fence	Back Ordered	\$109.99 Kit
	23363	23-1/2" X 27" with Porter Cable 7518/7539 Plate without Fence	Back Ordered	\$109.99 Kit
Accessories:				
Quantity	Part Number	Item	Stock Status	Price
	53756	Four-Piece Router Table Accessory Kit	In Stock	\$39.99 Each
	36461	Right Angle Miter Gauge	In Stock	\$29.99 Each
	80161	MDF 7" High Replacement Router Fence (pair)	In Stock	\$14.99 Pair
	35200	Black Delrin Insert with No Opening	In Stock	\$7.99 Each
Best Value Packages! Table Only Accessories:				
Quantity	Part Number	Item	Stock Status	Price
	53677	Router Table - Table Featherboard	In Stock	\$11.99 Each

	35343	Router Table Fence Stop Block	In Stock	\$7.99 Each
	53685	Router Table Fence Featherboard	In Stock	\$9.99 Each
	35317	Router Table Dust Collection Port	In Stock	\$12.99 Each
	67157	Bit Safety Guard	In Stock	\$11.99 Each
	23216	MDF Replacement Router Table Face Fence (each)	In Stock	\$5.99 Each
	63018	36" Miter Gauge Track	In Stock	\$16.99 Each

More details for Rockler Router Table Extensions

Our exclusive router extension table was designed for maximum use of valuable space! The 24" model is made for table saws with standard fences and can be left or right mounted. They are made of durable MDF material with a solid oak substructure and fit all saws with 27" - deep tops. Included are leg levelers for mounting your own wooden legs.



Extension table mounted on Left



Extension Table Mounted on Right

All tables include your choice of our [aluminum router table plate](#) to fit your router or a blank plate if your router is not listed.. Easy- to- install [miter gauge track](#) also available (sold separately). Our exclusive router extension table was designed for maximum use of valuable space! The 24" model is made for table saws with standard fences and can be left- or right-mounted. They are made of durable MDF material with a solid oak substructure and fit all saws with 27" - deep tops. Included are leg levelers for mounting your own wooden legs.

All tables include your choice of our [aluminum router table plate](#) to fit your router or a blank plate if your router is not listed.. Easy- to- install [miter gauge track](#) also available (sold separately).

*** 23356 - Router Table Plate**

Order this item number for the following routers:

Porter-Cable 7529/690/693. Also fits **Makita** 1100-1101 series, **Bosch** 1617 and 1618, and **DeWalt** DW616 and DW618.

[Buy Now Using Form Above](#)

People who bought Rockler Router Table Extensions also purchased:				
				
Rockler's #1 Router Table Package	Rockler Router Table with PC690 Router Combo Package	Clamp-It® Assembly Square, Clamps or Combo Pack	T-bolts	5-Star Knobs and 2" T-Knobs

[Back to Top](#)

To link to this page, please use the following url:

<http://www.rockler.com/findit.cfm?page=2212>

[Tools](#) —▶ [Rockler's Exclusive Product Line](#) —▶ [Rockler Router Tables and Package Options](#)

Rockler Partner Link: [Return to Jeff Greef Woodworking](#)

Shop Online: [Home](#) · [Product Index](#) · [Search](#) · [Catalog Quick Order](#)

Customer Service: 1-800-279-4441 · [Help Page](#) · [Privacy Statement](#) · [Contact Us](#)

Other Pages: [Retail Stores](#) · [Free Catalog](#) · [Careers](#) · [About Us](#)

Daily Deals for November 24, 2003

	Reg Price	Sale Price	You Save
The Best of Fine Homebuilding CD-ROM	\$149.99	\$99.99	33%
Anti-Fatigue Mat	\$19.99	\$14.99	25%
Double-Sided Laminate Blade	\$99.99	\$89.99	10%

Visit Our Partner Sites:



FreePlans.com



This is a [Secure Shopping Site](#)



[Copyright](#) © 2003, Rockler Companies, Inc.



amazon.com

VIEW CART

WISH LIST

YOUR ACCOUNT

HELP



Your Gold Box

WELCOME

YOUR STORE

BOOKS

APPAREL & ACCESSORIES

ELECTRONICS

TOYS & GAMES

HOME & GARDEN

TOOLS & HARDWARE

SEE MORE STORES

BROWSE BRANDS & PRODUCTS

TOP SELLERS

POWER TOOLS

ACCESSORIES

FREE CATALOG

GIFT IDEAS & WEDDING REGISTRY

TODAY'S DEALS

OUTLET, USED & RECONDITIONED

Warm up for the holidays

Get \$10 off a future Amazon purchase when you spend \$50 in Apparel. [Shop now](#)

Apparel & Accessories

SEARCH

Bench Dog RT100 ProTop Portable Router Table

[Bench Dog](#)



List Price: \$229.95

Price: **\$199.99**

You Save: \$29.96 (13%)

Availability: Usually ships within 1 to 2 days



This item ships for **FREE** with **Super Saver Shipping**. [See details.](#)

READY TO BUY?

OR

[Sign in](#) to turn on 1-Click ordering.

MORE BUYING CHOICES

Get it for less!

[Order it used](#)

Have one to sell?

[Sell yours here](#)

ITEM INFORMATION

Explore this item

[buying info](#)

[editorial reviews](#)

[customer reviews](#)

[rate this item](#)

See more of the brand

[Bench Dog](#)

Customers also bought

[these other items...](#)

Share your thoughts

[write a review](#)

[write a So You'd](#)

[Like to... guide](#)

[e-mail a friend](#)

[about this item](#)

Help us help others

[submit a manual](#)



Lowest Prices Guaranteed: If you find a lower price on this item, we'll [beat it](#) by 10% of the difference.

[See larger picture](#)

Features:

- 22-by-16-inch laminated work surface
- Accepts most routers
- Extruded aluminum fence
- Built-in jointing
- Two-year limited warranty

Manufacturers, merchants, and enthusiasts: [Submit a product manual](#) for this item.

Don't have one?
We'll set one up for you.

RATE THIS ITEM

I dislike it I love it!

1 2 3 4 5

[Edit your ratings](#)

Amazon.com Sales Rank: 103

Note: Giftwrapping not available for this item.

Packaging: This item may be delivered in the manufacturer's original packaging, which could reveal the contents of the box.

Shipping: [Amazon.com's shipping rates and policies](#)

Shipping: Currently, item can be shipped only within the U.S.

Shipping weight: 41.9 pounds.

ASIN: B00002242E

Item model number: RT-100

Date first available at Amazon: November 8, 1999

Average Customer Review: ★★★★★ Based on 26 reviews. [Write a review.](#)

Customers who bought this item also bought these products:

- [Bench Dog Feather-Loc FL100 Featherboard for Tablesaws](#) Bench Dog
- [Bench Dog PWR400 Power-Loc 15 Amp Auxillary Switch](#) Bench Dog
- [Freud 91-100 13-Piece 1/2" Shank Set](#) Freud
- [Big Horn 10221B Push Stick](#) Big Horn

Visit the [Books Store](#)

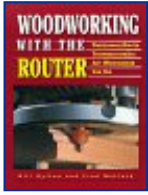

[Woodworking With the Router: Professional Router Techniques and Jigs Any Woodworker Can Use](#)
by Bill Hylton, Fred Matlack

► [Explore Similar Items: 18 in Tools & Hardware, and 5 in Books](#)

What's Your Advice?

Is there an item you'd recommend instead of or in addition to this one? Let the world know! Enter the item's ASIN ([what's an ASIN?](#)) in the box below, select advice type, then click Submit.

I recommend: in addition to this product
 instead of this product

Editorial Reviews

From the Manufacturer

More than just another benchtop router table, this one has a premium fence, miter gauge track, and cabinet base. The heavy extruded aluminum fence features built-in jointing, front and back T-slots, dust extraction, dual position bit guard, and a movable 3/4-inch MDF subfence for zero clearance settings. The 22-by-16-inch high-pressure laminate top features 12 leveling screws for the clear acrylic insert, quality PVC bumper molding, and an adjustable miter gauge track with a built-in T-slot. Includes jointer shims and fully illustrated manual.

Favorite Magazines!



Subscribe to other [Arts & Crafts magazines](#).

Spotlight Reviews [\(What's this?\)](#)

[Write an online review](#) and share your thoughts with other customers.

7 of 11 people found the following review helpful:

★★★★☆ **Not a very satisfying experience**, March 24, 2003

Reviewer: **A home improvement enthusiast** from Elizabeth, Colorado USA

My major complaint with this table is the poor quality of the instructions. The photography was unreadable. It would have helped if there was a pictorial breakdown of the parts, or if the panels were labeled. Also, I don't understand why the instructions went to great length to explain how install the Miter Gauge when there was none included. The European Cabinet hinges are trash. One of them would not mount until I removed them completely and formed them with a pair of pliers. This is a very steep price to pay for something made out of "Genuine Chipboard" \$... would have been more like it. This was my first tool from Bench Dog and it will be the last.

Was this review helpful to you?

Shop Gourmet Food

\$10 ✨
Special Offer

Get \$10 off a future purchase when you spend \$50 in our new [Gourmet Food Store](#).

8 of 8 people found the following review helpful:

★★★★★ **A Great Value**, October 21, 2002

Reviewer: **Jim Evans** from Springfield, VA USA

This is a well made and very sturdy bench top router table. Assembly is straight forward, with very clear directions. My table came with a stiffer and heavier phenolic insert, rather than the acrylic insert advertised. The fence is well designed and very nicely made. Overall, you can't beat the value. Though this isn't a criticism, there are two areas for improvement: 1) it should ship with a switch assembly to turn the router on/off, and 2) it should also ship with a pair of feather boards. Bench Dog sells a pair for [\$\$]- highly recommended as they work perfectly with this table.

Was this review helpful to you?

All Customer Reviews

Avg. Customer Review: ★★★★★

[Write an online review](#) and share your thoughts with other customers.

Get the Amazon.com Visa Card
Earn **3%** back
on Amazon.com purchases
Save \$30 instantly
[Learn more](#)

\$10
Special
Offer

Get \$10 off a future Amazon.com order when you make a purchase of \$50 or more in [Apparel](#), [Gourmet Food](#), [Sporting Goods](#), [Jewelry & Watches](#), or any combination of the four. [Here's how.](#)

2 of 2 people found the following review helpful:

★★★★★ **It's Great**, October 4, 2003

Reviewer: **A home improvement enthusiast** from Hyde Park, Utah United States

Just got it today. Set up was easy, instructions clear and was using it 45 minutes after opening the box. I would buy it again.

Was this review helpful to you?

**Lowest Prices
Guaranteed**



If you find a better price elsewhere on any Tools & Hardware product offered by Amazon.com, we will [match](#) that price and beat it by 10% of the difference.

2 of 2 people found the following review helpful:

★★★★★ **A Great Value in a Router Table**, July 20, 2003

Reviewer: **Frank Doss** from Warner Robins, Georgia United States

I could hardly believe that someone could make a Router Table with such quality! I received my bench in perfect condition and found the assembly easy to understand without any flaws. All the hardware (even extra was shipped) was present and assembly was very simple. I also installed the PL1002 Router Adjustment System and now I have a "First Class" set up. I would recommend the Bench Dog to anyone looking for the ideal setup!

Was this review helpful to you?

6 of 6 people found the following review helpful:

★★★★★ **Quality well built table**, June 19, 2003

Reviewer: **Anthony Michaud** from Milford, NH United States

This is my first router table and I don't think I'll ever have to buy another one. This thing is really nice. I am very impressed. I shopped around and looked at the Porter Cable (which got so-so reviews) and Craftsman (seem cheezy) but didn't want to spend an arm and a leg on some of the larger tables. Yet I still wanted quality. This has it. At a very reasonable price too!

It's heavy enough to keep it from sliding around, but has a lip on the bottom to clamp it to the work surface if you need to. It also has a lip on the table top for clamping feather boards etc.

The fence is solid, straight, and easily adjustable. It can even be shimmed (shims included) to be used as a joiner. Mine came with an upgrade from the acrylic plate to the phenolic plate. Nice surprise. It comes with a drilling template for mounting many popular routers to the blank plate. The instructions for assembly are straight-forward and easy to follow. It probably took me a half hour to 45 minutes to assemble taking my time.

The only drawback I have found is that you need to open the door to get to the power switch on the router. It would be nice if it had a switch built in to control the router and vacume, but then I guess it would cost more. I'll just add my own I guess. Benchdog does sell the switch if your intrested.

Because of that it really should get 4.5 stars.

Was this review helpful to you?

4 of 4 people found the following review helpful:

★★★★★ **Outstanding Product**, March 30, 2003

Reviewer: **[Bill Rychel \(see more about me\)](#)** from Boulder Junction, WI USA

What a pleasure to receive a product that is better than advertised! I can't remember the last time I received something with 'Assembly Required' that went together so well. All of the pieces were in the box, and they fit like a glove.

This table is extremely well designed and built to exacting tolerances. The most time consuming part of assembly is mounting the router to the table insert, because the template provided did not match my router (Dewalt PK618 Fixed Base).

By the way, this router, with it's snap-out motor, takes about 10 seconds to remove from the table and snap in to the plunge base. I'm a very happy camper.

Was this review helpful to you?

▶ [See all 26 customer reviews...](#)

Listmania!

- [why hasn't santa brought these down the chimney?](#): A list by [drew anderson](#), wisher
- [Woodworking books I want](#): A list by [ryansmith111](#), man who wants to build
- [Sawdust Junkie Stash](#): A list by [daniland11](#), Router Enthusiast

Browse for **Tools & Hardware** in:

- [Tools & Hardware](#) > [Brands](#) > [Bench Dog](#)
- [Tools & Hardware](#) > [Categories](#) > [Power Tools](#) > [Accessories](#) > [Router Accessories](#) > [Tables](#)



Suggestion Box

Your comments can help make our site better for everyone. If you've found something incorrect, broken, or frustrating on this page, let us know so that we can improve it.

Please mark as many of the following boxes that apply:

- Product information is missing important details.
- Product information is incorrect.
- The page contains typographical errors.
- The page takes too long to load.
- The page has a software bug in it.
- Content violates [Amazon.com's policy on offensive language](#).
- Product offered violates [Amazon.com's policy](#) on items that can be listed for sale.

Comments or Examples:

Examples: Missing information such as dimensions and model number, typos, inaccuracies, etc.

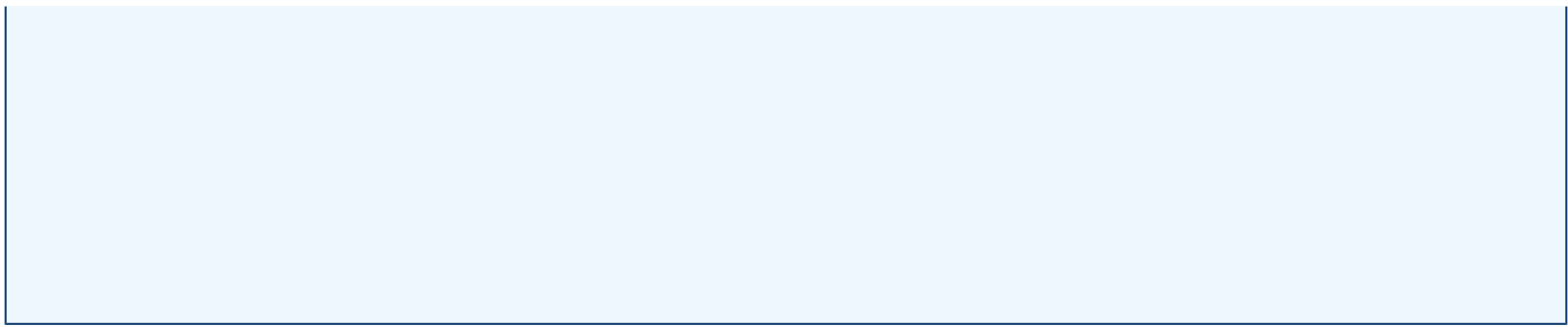

- | | | |
|--|--|---|
| <p>Where's My Stuff?</p> <ul style="list-style-type: none"> Track your recent orders. View or change your orders in Your Account. | <p>Shipping & Returns</p> <ul style="list-style-type: none"> See our shipping rates & policies. Return an item (here's our Returns Policy). | <p>Need Help?</p> <ul style="list-style-type: none"> Forgot your password? Click here. Redeem or buy a gift certificate. Visit our Help department. |
|--|--|---|

Search **for**

Your Recent History
[Learn More](#)

Recently Viewed Categories

 [Home & Garden](#) > [Tools & Hardware](#) > [Categories](#) > [Power Tools](#) > [Accessories](#) > [Router Accessories](#) > [Tables](#)

[Top of Page](#)

[Browse Brands & Products](#) | [Top Sellers](#) | [Power Tools](#) | [Accessories](#) | [Free Catalog](#) | [Gift Ideas & Wedding Registry](#) | [Today's Deals](#) | [Outlet, Used & Reconditioned](#)

[Amazon.com Home](#) | [Directory of All Stores](#)

Our International Sites: [Canada](#) | [United Kingdom](#) | [Germany](#) | [Japan](#) | [France](#)

[Contact Us](#) | [Help](#) | [Shopping Cart](#) | [Your Account](#) | [Sell Items](#) | [1-Click Settings](#)

[Investor Relations](#) | [Press Releases](#) | [Join Our Staff](#)

Bottom of the Page™ Deals for November 24

Amazon.com = low prices. Save up to 50% on these one-day-only deals.

	Our Price	You Save
<p>SOLD OUT FOR TODAY Tazo China Green Tips, Green Tea, Loose Bulk, (16-Ounces) A traditional green tea with a delicate taste.</p>	\$26.99	
<p>Memorex DVD-R 50 Pack Spindle 4x Ideal for premastering, high-volume data recording, and archiving.</p>	\$64.99	\$55.00 (46%)
<p>SOLD OUT FOR TODAY Duracell Coppertop AAA Batteries (84 Batteries) Stock up and save on advanced-performance Duracell Coppertop batteries.</p>	\$35.97	
<p>Strait-Line 64001 Laser Level The laser guide line tool every do-it-yourselfer needs!</p>	\$31.99	\$52.01 (62%)

[Pepcid Complete Antacid, Mint-Flavored 2 Pack, 150 Chewables](#)

Pepcid Complete--a single tablet delivers long-lasting heartburn relief.

\$39.99

\$34.90
(47%)

[Starbucks Espresso Roast Universal Ground Coffee, 6 12-Ounce FlavorLock Bags \(72 ounces total\)](#)

Start the day off right with this mild, flavorful breakfast blend.

\$28.78

[Metabolife Ephedra Free Formula to Enhance Energy \(400 Tablets\)](#)

Boost energy the healthy, safe way with ephedra-free Metabolife.

\$79.99

\$44.41
(36%)

[Calphalon Tri-Ply Stainless-Steel 3-Quart Sauté Pan](#)

This stainless-steel Calphalon pan cooks as good as it looks.

\$27.99

\$104.01
(79%)

[Singer 132Q 32-Stitch Function Sewing Machine](#)

Compact and convenient, this machine's perfect for a designer on the go!

\$159.99

\$100.01
(38%)



FREE Super Saver Shipping on orders over \$25. [See details.](#)

Amazon.com now offers bargains on brand-name essentials, all priced so low they've sunk to the bottom of the page! We take up to 50% off standard retail prices and deliver right to your door--no club fees, no hassle, no parking lot. These offers are only good until they're gone, and only for today. Check back tomorrow for all-new Bottom of the Page™ Deals.

SEARCH:

Search by Keyword or Item Number



800-279-4441

CATALOG QUICK ORDER | RETAIL STORES | FREE CATALOG | CAREERS | ABOUT US

DEPARTMENTS

- Hardware
- Tools
- Wood
- Plans & Books
- Finishing
-
- New Products
- Special Order Program
- Clearance
- Complete Product Index

PROJECTS

- Holiday Projects
- Home Office
- Entertainment Centers
- Kitchen
- Furniture
- For your Shop
- Small Projects
- Outdoor

Stay Informed!
Sign up for our
**Log-On
Newsletter**

CLICK HERE
TO SIGN UP!

**\$ Become an
Affiliate**

[Tools](#) → [Power Tools](#) → [Router Table Line](#)

Rockler's #1 Router Table Package

"The Rockler model offers a lot of value ... None of the other tables priced under \$200 seem worth the investment, in our opinion. "

"Router Table Review"
Wood Magazine
March 2000

[See details below](#)



[View Large Image](#)

Order Form:

Select Plate Option:

Quantity	Part Number	Item	Stock Status	Price
	68365	Complete Rockler Router Table Package with Porter Cable 8529 Plate	In Stock	\$159.99 KT
	23293	Complete Rockler Router Table Package with Porter Cable 7529/690/693 Plate	In Stock	\$159.99 Kit
	23300	Complete Rockler Router Table Package with Porter Cable 7518/7539 Plate	In Stock	\$159.99 Kit
	23314	Complete Rockler Router Table Package with Bosch 1617/1618 Plate	In Stock	\$155.99 Kit
	23307	Complete Rockler Router Table Package with DeWalt 621 Plate	In Stock	\$159.99 Kit
	23321	Complete Rockler Router Table Package with Blank Plate	In Stock	\$159.99 Kit
	23609	Complete Rockler Router Table Package with Small Craftsman Plate	In Stock	\$159.99 Kit

	23669	Complete Rockler Router Table Package with Craftsman HD/Plunge Plate	In Stock	\$159.99 Kit
Additional Inserts:				
Quantity	Part Number	Item	Stock Status	Price
	35200	Black Delrin Insert with No Opening	In Stock	\$7.99 Each
	35174	Insert for Template Guide with 1-1/4" Opening	In Stock	\$7.99 Each
Optional Accessories:				
Quantity	Part Number	Item	Stock Status	Price
	53756	Four-Piece Router Table Accessory Kit	In Stock	\$39.99 Each
	38970	Router Table Leg Set (Oak)	In Stock	\$110.99 Each
	20878	Router Table Leg Set (Pine)	In Stock	\$69.99 Each
	36461	Right Angle Miter Gauge	In Stock	\$29.99 Each
	80161	MDF 7" High Replacement Router Fence (pair)	In Stock	\$14.99 Pair
	32155	Router Table Extension Wing	In Stock	\$28.99 Pack
Components:				
Quantity	Part Number	Item	Stock Status	Price
	23517	Fence System with Bit Guard	In Stock	\$60.00 PK
	53677	Router Table - Table Featherboard	In Stock	\$11.99 Each
	35343	Router Table Fence Stop Block	In Stock	\$7.99 Each

	53685	Router Table Fence Featherboard	In Stock	\$9.99 Each
	35317	Router Table Dust Collection Port	In Stock	\$12.99 Each
	67157	Bit Safety Guard	In Stock	\$11.99 Each
	23216	MDF Replacement Router Table Face Fence (each)	In Stock	\$5.99 Each
	63018	36" Miter Gauge Track	In Stock	\$16.99 Each

More details for Rockler's #1 Router Table Package

The best value router table on the market!

The Rockler router table was created by woodworkers for woodworkers in our very own shop!

Click to see an [Animated Flash Presentation!](#)

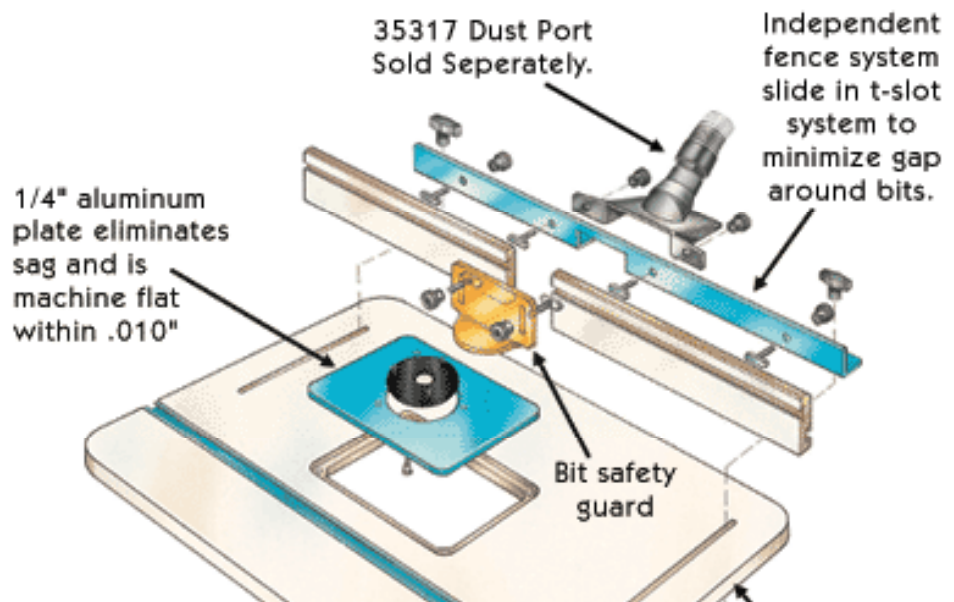



It has a large 24" x 32" surface made of 1-1/8" Medium Density Fiberboard (MDF) and surfaced with melamine on both sides.

Includes an aluminum miter track and heavy-duty 1/4" thick aluminum mounting plate (pre-drilled for various routers, including Porter-Cable).

The plate has interchangeable Black Delrin inserts with a 1-1/2" diameter opening and an insert with no opening.

Rockler's precision router fence features:

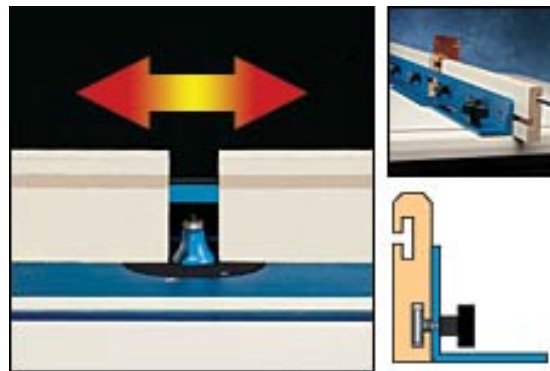

- A 32" long anodized aluminum angle that's machined straight and flat to within .010" for exact cuts.
- Two 3" x 16" adjustable melamine faces that can be adjusted to minimize the gap around the router bit.
- The faces include a T-slot for universal positioning of all accessories.
- The fence attaches to the table with a simple T-bolt system and comes with a bit safety guard.

OPTIONAL ACCESSORIES:

Router Table Accessories Complete the workshop!

Our Accessories help turn your workshop into one fit for a master woodworker. From bases to cut down set-up time to our router table plates designed specifically for your brand, you'll find what you need to improve your craftsmanship right here! *Accessories are purchased separately.*

Our NEW 4-piece router accessory kit will help give you a safe and clean cut every time – PLUS removes dust to keep your work space clean!



Four-Piece Router Accessory Kit Includes:

- 2-1/2" Integrated Dust Collection Port
- 2 Infeed/Outfeed Fence Featherboards
- 1 Table featherboard

Featherboards feature easy-to-grip locking knobs that provide safe positioning anywhere along the fence or in miter slot track. Includes new, improved miter gauge locking keys.

Maximize your router table with these options:



Rockler/Kreg Pocket Hole System



Plates for Jig Saws



Plates for Spindle Sanders



Extension Wings



Steel Router Table Leg Stand



Pine Router Table Leg Set



[Large Plate Router Table, Plate and Fence](#)







[Extra Large Plates for Big Routers](#)



[Folding Leg Stand](#)

[Buy Now Using Form Above](#)

People who bought Rockler's #1 Router Table Package also purchased:

				
Rockler Router Table Extensions	Rockler Router Table with PC690 Router Combo Package	Clamp-It® Assembly Square, Clamps or Combo Pack	1/4" Machined Aluminum Router Table Plates	Router Table Cabinet

[Back to Top](#)

To link to this page, please use the following url:
<http://www.rockler.com/findit.cfm?page=10160>

[Tools](#) → [Power Tools](#) → [Router Table Line](#)

Rockler Partner Link: [Return to Jeff Greef Woodworking](#)

Shop Online: [Home](#) · [Product Index](#) · [Search](#) · [Catalog Quick Order](#)
Customer Service: 1-800-279-4441 · [Help Page](#) · [Privacy Statement](#) · [Contact Us](#)
Other Pages: [Retail Stores](#) · [Free Catalog](#) · [Careers](#) · [About Us](#)

Daily Deals for November 24, 2003

	<u>Reg Price</u>	<u>Sale Price</u>	<u>You Save</u>
Gravity Lock For 3/4" Center Partition	\$3.99	\$1.99	50%
Beveled Glass Panel Kit	\$51.99	\$39.99	23%

[3 pc Countersink Set](#)

\$42.99

\$29.99

30%

Visit Our Partner Sites:



This is a [Secure](#) Shopping Site



[Copyright](#) © 2003, Rockler Companies, Inc.

800-279-4441

CATALOG QUICK ORDER | RETAIL STORES | FREE CATALOG | CAREERS | ABOUT US

DEPARTMENTS

- Hardware
- Tools
- Wood
- Plans & Books
- Finishing
-
- New Products
- Special Order Program
- Clearance
- Complete Product Index

PROJECTS

- Holiday Projects 
- Home Office
- Entertainment Centers
- Kitchen
- Furniture
- For your Shop
- Small Projects
- Outdoor

Stay Informed!
Sign up for our
**Log-On
Newsletter**

CLICK HERE
TO SIGN UP!

**\$ Become an
Affiliate**

[Tools](#) → [Rockler's Exclusive Product Line](#) → [Customize Your Router Table](#)

Rockler Jig Saw Plate

This plate allows you use your jigsaw like a scroll saw! Most jigsaws easily mount to the plate which sets into the Rockler router table giving you the use of the table's miter slot and fence. The specially designed angle cutting hole even lets you cut your jigsaw shapes at angles.



[View Large Image](#)

Order Form:

Quantity	Part Number	Item	Stock Status	Price
	31985	Rockler Jig Saw Plate	In Stock	\$49.99 Each

People who bought Rockler Jig Saw Plate also purchased:



[Rockler Router Table Extensions](#)

[Back to Top](#)

To link to this page, please use the following url:
<http://www.rockler.com/findit.cfm?page=5767>

[Tools](#) —▶ [Rockler's Exclusive Product Line](#) —▶ [Customize Your Router Table](#)

Rockler Partner Link: [Return to Jeff Greef Woodworking](#)

Shop Online: [Home](#) · [Product Index](#) · [Search](#) · [Catalog Quick Order](#)

Customer Service: 1-800-279-4441 · [Help Page](#) · [Privacy Statement](#) · [Contact Us](#)

Other Pages: [Retail Stores](#) · [Free Catalog](#) · [Careers](#) · [About Us](#)

Daily Deals for November 25, 2003

	Reg Price	Sale Price	You Save
Tool Rest (SVD-110) - Tormek Sharpening System	\$59.99	\$20.79	65%
Gravity Lock For 3/4" Center Partition	\$3.99	\$1.99	50%
Patriotic Shirt/Blouse Pin Designs	\$7.95	\$0.99	88%

Visit Our Partner Sites:



This is a [Secure Shopping Site](#)



[Copyright](#) © 2003, Rockler Companies, Inc.

800-279-4441

CATALOG QUICK ORDER | RETAIL STORES | FREE CATALOG | CAREERS | ABOUT US

DEPARTMENTS

- Hardware
- Tools
- Wood
- Plans & Books
- Finishing
-
- New Products
- Special Order Program
- Clearance
- Complete Product Index

PROJECTS

- Holiday Projects 
- Home Office
- Entertainment Centers
- Kitchen Furniture
- For your Shop
- Small Projects
- Outdoor

Stay Informed!
Sign up for our
**Log-On
Newsletter**

CLICK HERE
TO SIGN UP!

**\$ Become an
Affiliate**

[Tools](#) → [Rockler's Exclusive Product Line](#) → [Rockler Router Tables and Package Options](#)

Rockler Router Table Extensions

Add space to your current router set-up
— even in smaller workshops!



[See details below](#)



[View Large Image](#)

Order Form:

Best Value Packages!:

Quantity	Part Number	Item	Stock Status	Price
	23223	23-1/2" X 27" with Fence and Porter Cable 7529/690/693, Bosch 1617/1618 Plate	Back Ordered	\$169.99 Kit
	23398	23-1/2" X 27" with Fence and Porter Cable 7518/7539 Plate	Back Ordered	\$169.99 Kit
	23405	23-1/2" X 27" with Fence and DeWalt 621 Plate	Back Ordered	\$169.99 Kit
	23426	23-1/2" X 27" with Fence and Blank Plate	Back Ordered	\$169.99 Kit
	23589	23-1/2" X 27" with Fence Craftsman (1-1/2HP or less) Plate	Back Ordered	\$169.99 Kit

	23646	23-1/2" X 27" with Fence Craftsman HD/Plunge Plate	Back Ordered	\$169.99 Kit
Table Only:				
Quantity	Part Number	Item	Stock Status	Price
	23356	23-1/2" X 27" with Porter Cable 7529/690/693 Plate without fence. *See more router options below	Back Ordered	\$109.99 Kit
	23370	23-1/2" X 27" with DeWalt 621 Plate without Fence	Back Ordered	\$109.99 Kit
	23384	23-1/2" X 27" with Blank Plate without Fence	Back Ordered	\$109.99 Kit
	23597	23-1/2" X 27" with Craftsman (1-1/2HP or less) Plate without Fence	Back Ordered	\$109.99 Kit
	23659	23-1/2" X 27" with Craftsman HD/Plunge Plate without Fence	Back Ordered	\$109.99 Kit
	23363	23-1/2" X 27" with Porter Cable 7518/7539 Plate without Fence	Back Ordered	\$109.99 Kit
Accessories:				
Quantity	Part Number	Item	Stock Status	Price
	53756	Four-Piece Router Table Accessory Kit	In Stock	\$39.99 Each
	36461	Right Angle Miter Gauge	In Stock	\$29.99 Each
	80161	MDF 7" High Replacement Router Fence (pair)	In Stock	\$14.99 Pair
	35200	Black Delrin Insert with No Opening	In Stock	\$7.99 Each
Best Value Packages! Table Only Accessories:				
Quantity	Part Number	Item	Stock Status	Price
	53677	Router Table - Table Featherboard	In Stock	\$11.99 Each

	35343	Router Table Fence Stop Block	In Stock	\$7.99 Each
	53685	Router Table Fence Featherboard	In Stock	\$9.99 Each
	35317	Router Table Dust Collection Port	In Stock	\$12.99 Each
	67157	Bit Safety Guard	In Stock	\$11.99 Each
	23216	MDF Replacement Router Table Face Fence (each)	In Stock	\$5.99 Each
	63018	36" Miter Gauge Track	In Stock	\$16.99 Each

More details for Rockler Router Table Extensions

Our exclusive router extension table was designed for maximum use of valuable space! The 24" model is made for table saws with standard fences and can be left or right mounted. They are made of durable MDF material with a solid oak substructure and fit all saws with 27" - deep tops. Included are leg levelers for mounting your own wooden legs.



Extension table mounted on Left



Extension Table Mounted on Right

All tables include your choice of our [aluminum router table plate](#) to fit your router or a blank plate if your router is not listed.. Easy- to- install [miter gauge track](#) also available (sold separately). Our exclusive router extension table was designed for maximum use of valuable space! The 24" model is made for table saws with standard fences and can be left- or right-mounted. They are made of durable MDF material with a solid oak substructure and fit all saws with 27" - deep tops. Included are leg levelers for mounting your own wooden legs.



All tables include your choice of our [aluminum router table plate](#) to fit your router or a blank plate if your router is not listed.. Easy- to- install [miter gauge track](#) also available (sold separately).

*** 23356 - Router Table Plate**

Order this item number for the following routers:

Porter-Cable 7529/690/693. Also fits **Makita** 1100-1101 series, **Bosch** 1617 and 1618, and **DeWalt** DW616 and DW618.

[Buy Now Using Form Above](#)

People who bought Rockler Router Table Extensions also purchased:				
				
Rockler's #1 Router Table Package	Rockler Router Table with PC690 Router Combo Package	Clamp-It® Assembly Square, Clamps or Combo Pack	T-bolts	5-Star Knobs and 2" T-Knobs

[Back to Top](#)

To link to this page, please use the following url:

<http://www.rockler.com/findit.cfm?page=2212>

[Tools](#) —▶ [Rockler's Exclusive Product Line](#) —▶ [Rockler Router Tables and Package Options](#)

Rockler Partner Link: [Return to Jeff Greef Woodworking](#)

Shop Online: [Home](#) · [Product Index](#) · [Search](#) · [Catalog Quick Order](#)

Customer Service: 1-800-279-4441 · [Help Page](#) · [Privacy Statement](#) · [Contact Us](#)

Other Pages: [Retail Stores](#) · [Free Catalog](#) · [Careers](#) · [About Us](#)

Daily Deals for November 25, 2003

	Reg Price	Sale Price	You Save
Gravity Lock For 3/4" Center Partition	\$3.99	\$1.99	50%
3-Pc. Japanese Chisel Set	\$79.99	\$59.99	25%
CREDO Epsilon Regulators	\$41.99	\$29.99	29%

Visit Our Partner Sites:



FreePlans.com



This is a [Secure](#) Shopping Site



[Copyright](#) © 2003, Rockler Companies, Inc.