

# ROTARY CUTTER PARTS



Parts are not original equipment parts and are not sponsored, affiliated, or otherwise connected with any major brand.

- A-8227** Bolt, Rotary Cutter Blade  
Uses 8227JN Jam Nut & 8227LW Lock Washer  
*Alamo* SEVERAL  
*BMB* SEVERAL
- A-02964330** Bolt, Rotary Cutter Blade  
*Alamo* SEVERAL
- A-00761402** Bolt, Rotary Cutter Blade  
*Alamo* SEVERAL
- A-TC-2** Bolt, Rotary Cutter Blade  
*Brown* SEVERAL
- A-102297** Bolt, Rotary Cutter Blade  
*Brown* SEVERAL
- A-1259BH** Bolt, Rotary Cutter Blade  
*Bush Hog* 104, 204, 204H, RAZORBACK RZ60, SQ36, SQ42, SQ420, SQ48, SQ480
- A-63605BH** Bolt Kit, Rotary Cutter Blade  
1 each of: Blade Bolt, 1-3/8" Lock Washer, 1-3/8"-12 Nut  
*Bush Hog* 406
- A-7A5000** Bolt Kit, Rotary Cutter Blade  
Kit Contains 1 Each 7A4997 Bolt, 7A4999 Nut & 7A4998 Lock Washer  
*Bush Hog* 105, 109, 1109, 1126, 12, 1209, 1226, 126, 1310, 1315, 160, 1600, 205, 206, 226, 305, 306, 307, 307R, 310, 315, 502, 6, 600  
*Fred Cain* SEVERAL  
*Great Plains*  
*Hico* SEVERAL  
*Marvel* SEVERAL  
*Mohawk* SEVERAL  
*Mono* SEVERAL
- A-63607BH** Bolt Kit, Rotary Cutter Blade  
Contains 2 Each 7A4997 Bolts, Nuts & Lock Washers  
*Bush Hog* 105, 109, 1109, 1126, 12, 1209, 1226, 126, 1310, 1315, 160, 1600, 205, 206, 226, 305, 306, 307, 307R, 310, 315, 502, 6, 600  
*Marvel* SEVERAL
- A-90613BH** Bolt Kit, Shredder (2)  
For 3200 Series Cutters (Kit Contains 2 each of 90612BH Bolt, 44383BH Slotted Nut, 86310BH Pivot Bushing, 15473BH Cotter Pin)
- A-VLH1711** Shredder Bolt
- A-VLH1712** Shredder Bushing
- A-44383BH** Nut 1-1/8"-12 Slotted  
*Bush Hog* 3209, 3210
- A-906712BH** Shredder Bolt Kit  
For 3200 Series Cutters (Contains One of Each of Following: 90612BH Bolt, 44383BH Slotted Nut, 86310BH Pivot Bushing, 15473BH Cotter Pin)
- A-VLH1711** Shredder Bolt
- A-VLH1712** Shredder Bushing
- A-44383BH** Nut 1-1/8"-12 Slotted  
*Bush Hog* 3209, 3210
- A-T5-001** Bolt, Rotary Cutter Blade  
*Brown* SEVERAL
- A-7A5495** Bolt Kit, Rotary Cutter Blade  
Kit Contains Bolt, Nut & Lock Washer
- A-101056KK** Bolt  
*Covington* SEVERAL  
*Dixie* SEVERAL  
*Hico* SEVERAL  
*Imco* SEVERAL  
*Mono* SEVERAL

**A-309719** Bolt Kit, Rotary Cutter Blade  
Includes Bolt, Nut, Spacer, & Cotter Pin  
*Ford / New Holland* 22-47, 22-60, 22-70

**A-7A5500** Bolt Kit, Rotary Cutter Blade  
Kit Contains 1 each of 7A5548 blade bolt, 7A5547 washer, 7A5546 nut

**A-7A5548** Blade Bolt  
*Hardee* SEVERAL

**A-C-48** Bolt, Rotary Mower Blade  
*Hardee* SEVERAL

**A-7A5575** Bolt Kit  
Contains 1 each of HL418N blade bolt, 7A4999 nut, 7A4998 washer  
*Hico* SEVERAL



**A-HL418N** Bolt, Rotary Cutter Blade  
*Hico* SEVERAL w/ new square shoulder

**A-W38686** Bolt, Blade  
*John Deere* 1008, 1018, 1418, 1508, 1517, 1518, 2018, 506, 509, 516 S/N <003525, 606, 609, 709, (727, 737 ALL S/N 1990->

**A-W38054** Bolt, Blade  
*John Deere* 1517, 403, 413, 503, 513, 516 S/N <003525, 603, 613, 717, CX15, CX20, HX10, HX14, HX15, HX20, LX4, LX5, LX6, MX10, MX5, MX6, MX7

**A-7A6032** Bolt & Nut  
Contains 1 each of: W22237 blade bolt, H29619 nut (Not used on double blade application).

**A-W22237** Blade Bolt Only

**A-H29619** Nut 1-1/8"-12 Toplink  
*John Deere* 1008, 1408, 1418, 1508, 509, 609, 709, 727, 737

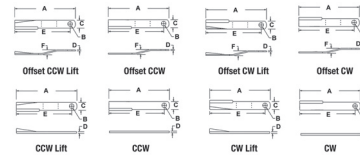

**A-W38686KIT** Bolt Kit, Rotary Cutter Blade  
*John Deere* (1008, 1018, 1418, 1508 ALL w/ Single Blade), 1517 w/ Single 4" Blade, (1518, 2018, 509, 609, 709 ALL w/ Single Blade), (727, 737 ALL w/ Single Blade S/N 1990->)

**A-W38679** Spacer, Blade  
Used w/ Dual Blades  
*John Deere* 1008, 1018, 1418 SN 001501>, 1508 SN <029600, 1517, 1518, 2018, 509, 609, 709, (727, 737 ALL SN 1990->)

**A-4128043** Bolt, Rotary Cutter Blade  
1" LH w/ Round Shoulder  
*Modern* SEVERAL

**A-41280432** Bolt, Rotary Cutter Blade  
1" LH w/ Round Shoulder  
*Modern* SEVERAL

**A-7A6000** Bolt Kit, Rotary Cutter Blade  
Contains 1 each: 7A5997 Bolt, 7A5998 Nut, 7A6009 Spacer & Cotter Pin  
*Mono* SEVERAL w/ 1/2" Blades

**A-7A6010** Bolt Kit, Rotary Cutter Blade  
Contains 1 each: 7A5997 Bolt, 7A5998 Nut, 16197SW Spacer & Cotter Pin  
*Mono* SEVERAL w/ 3/8" Blades

# ROTARY CUTTER PARTS

**A-B36107A2ALH** Bolt Kit, Rotary Cutter Blade  
Contains 1 each: 36107A2ALH Blade Bolt & 7A5512 Lock Nut

**A-36107A2ALH** Bolt

**A-7A5512** Lock Nut

**Rhino** SEVERAL

**A-B571044** Bolt Kit, Rotary Cutter Blade  
Contains 1 each: 7A5710 1" LH bolt, 7A5161 LH nut

**Rhino** SEVERAL

**A-57-104-4** Bolt, Rotary Cutter Blade

**Rhino** SEVERAL

**A-8251** Bolt, Rotary Cutter Blade  
1" Bolt w/ square shoulder. Uses Nut W38134

**Rhino** SE7, TW120, TW144, TW96

**A-251101** Bolt, Rotary Cutter Blade

**Schulte** 5026, S100, V1280, XH1000, XH600

**A-251-007** Bolt, Rotary Cutter Blade

**Schulte** SEVERAL

**A-251-101** Bolt Kit, Rotary Cutter Blade

**Schulte** 5026, S100, V1280, XH1000, XH1500, XH600

**A-27723SW** Bolt Kit, Rotary Cutter Blade  
Contains 1 each: 16196SW Bolt, 7A5491 Nut & 7A6009 Spacer

**Sidewinder** SEVERAL w/ 1/2" Blade, 6X6

**A-27722SW** Bolt Kit, Rotary Cutter Blade  
Contains 1 each: 16196SW Bolt, 7A5491 Nut & 16197SW Spacer

**Sidewinder** SEVERAL w/ 3/8" Blade, 6X6

**A-7A5492** Bolt Kit  
Contains 1 each: 16196SW Bolt & 7A5491 Nut. Order Spacer, 16197SW (3/8") or 7A6009 (1/2") separately

**Sidewinder** SEVERAL

**A-27724SW** Bolt Kit, Rotary Cutter Blade  
Contains 1 each: 15060SW Bolt & 15061SW Nut

**Sidewinder** FW16, FW216, GB605, GB725, GB842, RS160, RS213, SW66, SW72, SW84, SW842

**A-15060SW** Bolt, Rotary Cutter Blade

**Sidewinder** SEVERAL

**A-505785** Bolt, Rotary Cutter Blade

**Taylor (Midland)** SEVERAL

**A-810801** Shredder Bolt

**Taylor (Midland)** SEVERAL

**A-7A6042** Bolt Kit, Rotary Cutter Blade  
For 02761500 blade (Contains 02782900 Bolt, 7A4998 Washer, 00020900 Nut & Roll Pin)

**A-02782900** Bolt only

**Terrain King** A1300M, A-BOOM

**A-00752827** Bolt, Blade

**Terrain King** SEVERAL

**A-00020900** Nut 1-1/8"-12 Slotted

**Terrain King** A1300M MOWERS, A-BOOM

**A-7A6015** Bolt Kit, Rotary Cutter Blade  
Contains 1 each: 6T1022R Bolt & 6T1023R Lock Nut

**A-6T1022R** Blade Bolt

**A-6T1023R** Lock Nut

**Tiger** SEVERAL

**A-WD32602** Bolt, Blade

**Woods** SEVERAL

## SLIP CLUTCHES

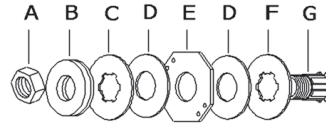

**A-80A80** Spring, Heavy  
**BMB** 2162 w/ 3 spring 60° and 72° cutters

**A-7142** Front Plate  
**BMB** 2162 w/ 3 spring 60° and 72° cutters

**A-8053** Facing, 2 Required  
**BMB** 2162 w/ 3 spring 60° and 72° cutters

**A-7143** Back Plate rotary Cutter  
**BMB** 2162 w/ 3 spring 60° and 72° cutters

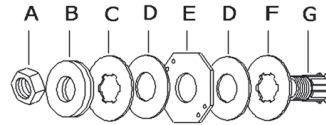

**A-80A75** Slip Clutch Assy. w/ 2 Springs

**A-C61A** Adjustable Nut, 1 reqd (A)

**A-C60A** Spring, 2 reqd (B)

**A-C56A** Front Plate (C)

**A-36F42** Facing, 2.625" hole, 6.25" OD, 2 reqd (D)

**A-80A81** Drive Plate, 1 reqd (E)

**A-C433** Back Plate (F)

**A-80A79** Hub (G)

**Hardee** T160LT, T160LTO, T166LT, T166LTO, T172LT, T172LTO, T52LT

**Mono** SEVERAL

**Terrain King** SEVERAL 6' Cutters

**Vermeer** SEVERAL

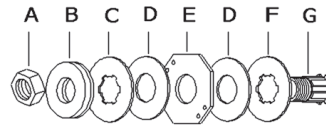

**A-0731070000** Slip Clutch Assy. w/ 3 Springs

**A-80A79** Hub (G)

**Rhino** SEVERAL

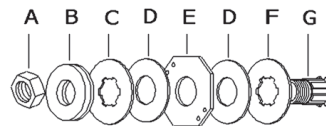

**A-3054** Clutch Assembly, w/ 3 springs

**A-4406** Clutch Assembly, w/ 2 springs

**A-8320** Adjustable Nut, 1 Reqd (A)

**A-8319** Spring, as reqd (B)

**A-8322** Drive Plate, 1 Reqd (C)

**A-8323** Facing, 6.5" OD, 2.625" ID, 2 Reqd (D)

**A-8318** Plate, 1 Reqd (E)

**A-8324** Back Plate, 1 Reqd (F)

**A-3061** Hub, 1 Reqd (G)

**A-3059** Facing, 6.5" OD, 2" ID

**Caldwell** SEVERAL

Parts are not original equipment parts and are not sponsored, affiliated, or otherwise connected with any major brand.

# ROTARY CUTTER PARTS

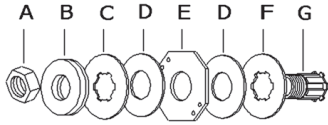

- A-15432-03SW** Slip Clutch Assy. w/ 1-3/8" 6 Splines
- A-15440SW** Adjusting Nut (A)
- A-18311-018SW** Spring (B)
- A-15435SW** Front Plate (C)
- A-15436SW** Facing (D)
- A-15437-03SW** Drive Plate (E)
- A-15435-02SW** Back Plate (F)
- A-20770SW** Hub (G)

**Sidewinder** SEVERAL

- A-202227** Slip Clutch Disc
- Ford / New Holland** 22-116, 22-127, 22-127A, 22-147, 22-149, 22-151, 22-153, 22-155, 22-157, 22-166, 22-176, 22-177, 22-47, 22-60, 901, 908, 909, 910

- A-122119** Slip Clutch Disc
- Ford / New Holland** 60, 72

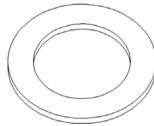

- A-DC38275** Slip Clutch Disc
- John Deere** (1418, 709 ALL Late models w/ spring loaded slip clutch)

- A-W39301** Slip Clutch Disc
- John Deere** 1008, 1408, 1418, 1508, 1518, 205, 227, 307, 407, 506, 509, 606, 609, 706, 709, 727, 737, 15A, 16A

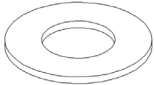

- A-058-1060-003** Slip Clutch Disc, 3.75" hole, 7" O.D.
- Rhino** TW60, TW72, TW84

- A-00754202** Slip Clutch Disc, 6" O.D., 3.625" I.D.
- Terrain King** SEVERAL

- A-106416017** Slip Clutch Disc
- Vermeer** SEVERAL

- A-7280WD** Slip Clutch Disc
- For Rotary Cutters
- Woods** 0120, 0121, 120, 121, 208, 2090, 214, 60, 72, 84, B106, B214, B315, B320, D15, D210R, HD210, HD315, M121, M208, M4, M5, M60, M72, M84, MB106, MC72, MK105, R105, S105, S106, SM2090, SM214

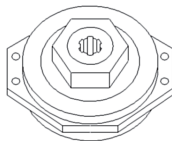

- A-7502531** Slip Clutch
- Ford / New Holland** 908

- A-7500438** Slip Clutch

- A-7500438-H** Slip Clutch Assy.
- Has 2 Heavy Springs.
- Ford / New Holland** 909, 910

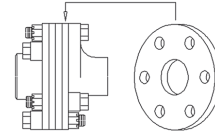

- A-970-2110** Friction Disc, 6" O.D.
- For Flexible Couplers

**Bush Hog**  
**Hardee** SEVERAL  
**Rhino** SEVERAL  
**Sidewinder** SEVERAL  
**Taylorway** SEVERAL

- A-567300** Friction Disk (6.024" O.D. X 3.583" I.D.)
- For W2100, W2200, W1, W2300, W220, W230, W2400, W11, W240, W2500, W2600 German Type PTO

**Miscellaneous**

- A-W168556** Friction Clutch Disc, (6.024" O.D. X 3.583" I.D.)
- Miscellaneous**

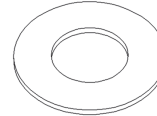

- A-BP247000054-A** Slip Clutch Lining, 5.5" O.D., 3.375" I.D.
- For 800 Series Cutters

**Bush Hog** (1257R, 257R ALL lift & pull type), 40, 52, 60, RT32  
**Hardee** 800 SERIES

- A-64644BH** Lining, (160mm) 6-5/16" OD
- 6-5/16" (160 MM) O.D.

**Bush Hog** 1220R, 1310R, 1315R, 220R, (255R, 256R ALL LIFT & PULL TYPE), 310R, 315R

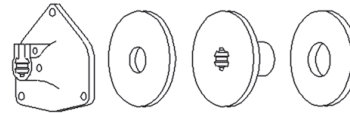

- A-372-1BH** Clutch Facing, Outer
- For 368-1BH Slip Clutch
- Bush Hog** (ROTARY CUTTER: SEVERAL)

- A-374BH** Clutch Facing, Inner
- Bush Hog** (ROTARY CUTTER: SEVERAL)

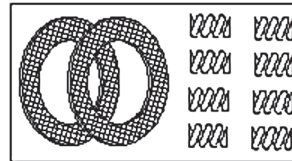

- A-67303BH** Spring & Lining Kit
- Kit Contains 2-Linings & 8-64657BH 6MM Springs
- Bush Hog** SQ60, SQ60-4 w/ spline input shaft on gearbox, SQ72-3 pull type

- A-67304BH** Spring & Lining Kit
- Kit Contains: 2-64644BH Linings, 8-64657BH 6MM Linings
- Bush Hog** 12610, 12615, 255R, 255R-2, 256R, 256R-2, 2610, 2615, (1220R, 1220RW, 1220S, 1220SW, 1310R, 1310RW, 1310S, 1310SW, 1315R, 1315RW, 1315S, 1315SW, 220, 220R, 220RW, 220S, 220SW, 310R, 310RW, 310S, 310SW, 315R, 315RW, 315S, 315SW ALL for wing drive shaft), (SQ72-2, SQ72-3 ALL lift models w/ input shaft on gearbox)

Parts are not original equipment parts and are not sponsored, affiliated, or otherwise connected with any major brand.

# ROTARY CUTTER PARTS

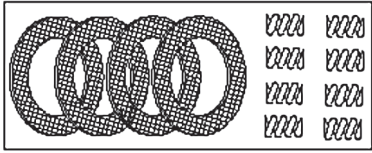

**A-67305BH** Spring & Lining Kit  
Kit Contains: 4-Linings & 8-64657BH 6MM Springs

**Bush Hog** 12680R, 1268R, 2680R, 268R, 277, (12620, 13615, 2620 ALL for wing and center driveline), 3615 for wing and center driveline), (1256R-2, 1257R, 1257R-2 ALL pull models), (257R, 257R-2 ALL lift models), (2512-11, 2512-13, 2512-14, 2512-18 ALL w/o jackshaft)

**A-67306BH** Spring & Lining Kit  
Kit Contains: 4-64644BH Linings & 8-64657BH 6MM Springs

**Bush Hog** 13108, 13108 OFFSET, 13126, 13126 OFFSET, 13368, 13618, 3108, 3108 OFFSET, 3126, 3126 OFFSET, 3168, 3368, (2512, 12512 ALL w/ lift & semi-lift mounts), 2512 pull type, (1220R, 1220RW, 1220S, 1220SW, 1310R, 1310RW, 1310S, 1310SW, 1315R, 1315RW, 1315S, 1315SW, 220, 220R, 220RW, 220S, 220SW, 2512-01, 2512-03, 2512-04, 2512-08, 310R, 310RW, 310S, 310SW, 315R, 315RW, 315S, 315SW ALL w/ jackshaft)



**A-64828BH** BUSHING

**Bush Hog** 1220R, 1310R, 1315R, 220R, 310R, 315R, 40, 52, 60, RT32, (1257R, 257R ALL lift & pull type)

**A-810800** Shredder Bushing

**Taylor (Midland)** SEVERAL

**A-BP351016370** Spring Coil, (5mm) 3/16", 8 Required

**Bush Hog**

**A-64657BH** Spring Coil, (6mm) 1/4", 8 Required  
1/4" / 6 mm Coil, 8 Required

**Bush Hog** SEVERAL

**A-64648BH** Spring Coil, (7mm) 9/32", 8 Required  
9/32" / 7 mm Coil, 8 Required

**Bush Hog** SEVERAL

## WHEEL ASSEMBLY

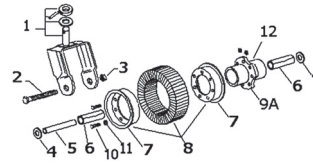

**A-12269BH** Caster Wheel Kit (1-1/2" Dia Shank)  
New Style w/400 x 8 Tire

**A-12269BHSPL** Caster Wheel Assy. (1-1/4" Dia Shank)

**A-12528BH** Fork Assy. (1)

**A-20123BH** Bolt 3/4"-10x8" (2)

**A-15591BH** Lock Nut 3/4" - 10 (3)

**A-12261BH** Wear Washer (4)

**A-VLH1722** Spacer (5)

**A-12250BH** Roller Brg w/Sleeve (6)

**A-500BH** 400x8 Tail Wheel Assy. (8)

**A-233BH** Wheel Half (7) \*not included

**A-12105BH** Hub less Bolts (9B)

**A-12268BH** Hub w/ Bolts (9A) \*not included

**A-HD12X1NCBLT** Bolt 1/2" - 13x1" (10)

**A-HD12LW** 1/2" Lock Washer (11)

**A-GF1428TT** Grease Fitting (12)

**A-8A911** Bearing Set for 12268BH \*1 req per hub

**Bush Hog** 104, 105, 1050, 1051, 109, 1109, 1126, 12, 1209, 1226, 126, 1307, 1405, 1405HR, 1406, 1406HR, 266, 305, 306, 307, 405, 405HR, 406, 406HR, 502, 600

**A-12269BH** Caster Wheel Kit (1-1/2" Dia Shank)

**A-12269BHSPL** Caster Wheel Assy. (1-1/4" Dia Shank)

**Hardee** SEVERAL



**A-7977** Hub, Rotary Cutter

**Replaces:** 65297

**Bush Hog** 126, 160, 166, 220, 2315, 2415, 2510, 2512, 255, 256, 2610, 2614, 268, 310, 3108, 3209, 3368, 3610, 502, CR15F, CR20F

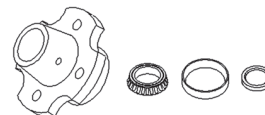

**A-80A1311** Wheel Hub w/ Bolts & Cups

**Imco** SEVERAL

**Terrain King** SEVERAL

**A-12250BH** Roller Bearing Kit  
For New Style Tail Wheel

**Bush Hog** 104, 105, 1050, 1051, 109, 1109, 1126, 12, 1209, 1226, 126, 1307, 1405, 1405HR, 1406, 1406HR, 266, 305, 306, 307, 405, 405HR, 406, 406HR, 502, 600

Parts are not original equipment parts and are not sponsored, affiliated, or otherwise connected with any major brand.

# ROTARY CUTTER PARTS

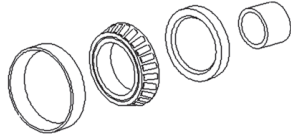

**A-8A91** Roller Bearing Kit  
w/2 Each Cups, Cones & Seals

**Forest City** SEVERAL

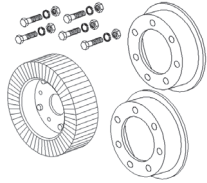

**A-AC27** Wheel, 4" X 8" Tail Rim Wheel Assembly

**A-80A502** 2 Wheel Halves w/ Bolts

**A-80A501** 1 Wheel Half

**Fred Cain** SEVERAL

**A-80A500** Wheel, 4" X 8" Tail Rim Wheel Assembly

**A-80A502** 2 Wheel Halves w/ Bolts

**A-80A501** 1 Wheel Half

**Hardee** SEVERAL

**Marvel** SEVERAL

**Modern**

**Mono** SEVERAL

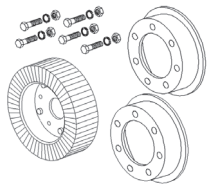

**A-4010048** Wheel, 4" X 8" Tail Rim-Wheel Assembly

**A-80A502** 2 Wheel Halves w/ Bolts

**A-80A501** 1 Wheel Half

**Modern** SEVERAL

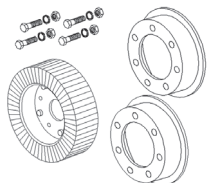

**A-373024H** Wheel, 4" X 8" Tail Rim-Wheel Assembly

**A-00025200** 6X9 Tail Tire w/ Rims

**A-373024B** 2 Wheel Halves w/ Bolts

**A-80A501** 1 Wheel Half

**A-373024C** Tail Wheel Hub

**A-8A993** Bearing Set

**New Idea** SEVERAL

SEVERAL

**A-15205SW** Wheel, 4" X 8" Tail Rim Wheel Assembly

**A-17122SW** Tail Tire w/ Rims

**A-80A502** 2 Wheel Halves w/ Bolts

**A-80A501** 1 Wheel Half

**A-80A600** 4 Bolt Hub (5" center), less Bushing

**A-80A612** .725" ID Bushing

**A-80A616** 1" ID Bushing

**A-16952SW** Hub w/ Bolts & Cups

**A-80A196** Hub w/ Bolts, Cups, Cones, Seals, Bushings

**A-15196SW** Bushing

**A-8A993** Bearing Set

**Sidewinder** SEVERAL

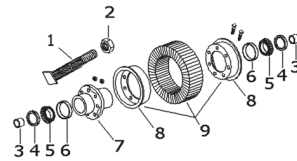

**A-215BH** Caster Wheel Assy.

**A-1317BH** Axle Bolt, 1"x7", 3/4" thread (1)

**A-15591BH** Lock Nut 3/4" - 10 (2)

**A-610335BH** Bushing (3)

**A-30BH** Seal (4)

**A-22BH** Cone (5)

**A-170BH** Cup (6)

**A-1311BH** Hub w/ brg cups (7)

**A-233BH** Wheel Half (8)

**A-500BH** 400x8 Tail Wheel Assy. (9)

**Bush Hog** SEVERAL

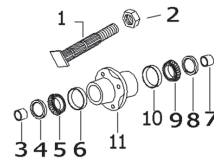

**A-80A311** Hub Assembly  
Includes Hub, 4 Lug Bolts, Bearings, Seals, Spacers, Axle Bolt & Lock Nut

**Bush Hog** SEVERAL

Parts are not original equipment parts and are not sponsored, affiliated, or otherwise connected with any major brand.



# ROTARY CUTTER PARTS

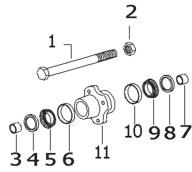

- A-80A350** Hub Assembly
- A-80A1311** Wheel Hub w/ Bolts & Cups
- A-BC18** Hub Axle Bolt
- A-HD1NCNUT** Hub Axle Nut, 1"-8 HEX
- A-452554** SEAL
- A-AC21** Bushing
- A-8A901** Bearing Set \*order seperately
- A-8A902** Bearing Set (set of 2) \*order seperately

**Fred Cain** SEVERAL

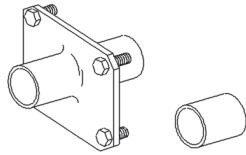

- A-80A600** 4 Bolt Tail Wheel Hub (5" Center), w/o Bushing
- A-80A616** 1" ID Bushing

**Fred Cain** SEVERAL

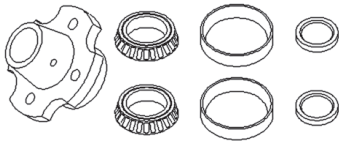

- A-VPN1004** 4 Bolt Hub Kit (5" center) w/ Brgs & Seals

**Rhino** SEVERAL

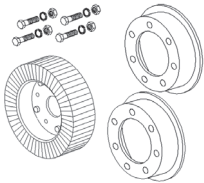

- A-80A196** Hub w/ Bolts, Cups, Cones, Seals, Bushings

**Sidewinder**

- A-16952SW** Hub w/ Bolts & Cups

- A-80A15196** Bushing

- A-8A993** Wheel Bearing Kit \*sold separately

**Sidewinder** SEVERAL

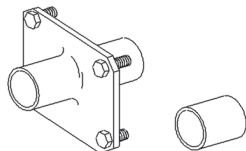

- A-80A600** 4 Bolt Tail Wheel Hub (5" Center), w/o Bushing

- A-80A612** .725" ID Bushing

- A-80A616** 1" ID Bushing

**Sidewinder**

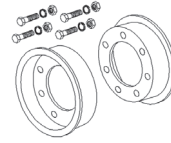

- A-80A502** Rim, Two Wheel Halves With Bolts  
Wheel Assy. Less Tire for 400x8 Solid Tire, Complete w/Bolts, Nuts & Lockwashers

**Bush Hog** SEVERAL

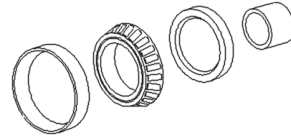

- A-8A901** Bearing, Set  
Used in 80A311 Hub Kit, Contains one of the following: Seal, Cone, Cup, Bushing

**Bush Hog** SEVERAL



- A-8A993** Wheel Bearing Kit  
For Tail Wheel Hub, C37

**Hardee** SEVERAL

**Rhino** CY60, CY72, G72, RHINO 128, SAT5, SAT6, SAT7, SAT8

**Sidewinder** SEVERAL

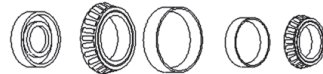

- A-8A996** Wheel Bearing Kit (6 Bolt Hub)

For Pull Type Cutters

**Rhino** FLEX 1310, FLEX 15

- A-8A994** Wheel Bearing Kit

For Pull Type Cutters

**Rhino** CY60, CY72, FLEX 15 w/ 5 bolt hub, FS15 outside axle only, G60, G72, SAT6, SAT7, SAT8

- A-8A995** Wheel Bearing Kit

For Pull Type Cutters

**Rhino** 1310 w/ 5 Bolt Hub, FLEX 15 Center Axle Only, (GR84, RHINO 128 ALL w/ 5 Bolt Hub)

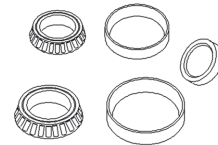

- A-VLH1717** Tail Wheel Bearing Set

**Rhino** FL15M, SEVERAL, SR15M, TW168



- A-VPN1035** Wheel, 4" X 8" Tail Rim Wheel Assembly

**Bush Hog** (SEVERAL w/1-1/2" Shaft

**Hardee** (SEVERAL w/1-1/2" Shaft

**Land Pride** (SEVERAL w/1-1/2" Shaft

Parts are not original equipment parts and are not sponsored, affiliated, or otherwise connected with any major brand.

# ROTARY CUTTER PARTS



**A-37-302-4C** Tail Wheel Hub  
**Rhino** SAT5, SAT6, SAT7, SAT8, CY60, CY72, G72, RHINO 128

**A-8A1035** Bearing Kit w/spindle assy.  
 For VPN1035: Contains 2 Each Brg. Cones, Cups, Seals & 1 Spindle Tube w/ Nuts.

**Bush Hog** SEVERAL  
**Hardee** SEVERAL  
**Land Pride** SEVERAL

**A-VPN1038** Wheel bearing kit rotary mower  
 For VPN1035 Contains 2 Each Bearing Cones, Cups & Seals

**Bush Hog** SEVERAL  
**Hardee** SEVERAL  
**Land Pride** SEVERAL

**A-4A1035** Spindle Assembly  
 For VPN1035 (Contains: Spindle Tube w/Nuts)

**Bush Hog** SEVERAL  
**Hardee** SEVERAL  
**Land Pride** SEVERAL

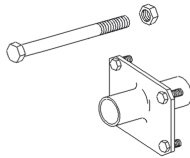

**A-60990BH** Hub, 4 Bolt on 5" Circle, w/o Bushings  
 W/Bolts, Less Bushing

**Bush Hog** SEVERAL

**A-63813BH** Hub, 4 Bolt on 5" Circle, w/ .750" Bushings

**Bush Hog** SEVERAL

**A-44090BH** Bolt, Tail Wheel Hub (3/4" x 7")

**Bush Hog** SEVERAL

**A-15591BH** Lock Nut 3/4" - 10

**Bush Hog** 104, 105, 1050, 1051, 109, 1109, 1126, 12, 1209, 1226, 126, 1307, 1405, 1405HR, 1406, 1406HR, 266, 305, 306, 307, 405, 405HR, 406, 406HR, 502, 600, SEVERAL

**A-63811BH** Bushing, 3/4" I.D.  
 3/4" I.D., 2 Req'd Per Hub

**Bush Hog**

**A-80A616** Bushing, 1" I.D.  
 1" I.D., 2 Req'd Per Hub

**Bush Hog**

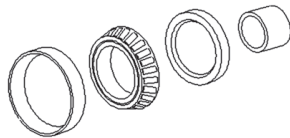

**A-610335BH** Bushing

**Bush Hog** SEVERAL

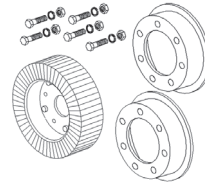

**A-294BH** Wheel, 6" X 9" Tail Rim-Wheel Assembly

**Bush Hog** SEVERAL

**A-12528BHSPL** Fork, 1 1/4" Dia. Shaft

**Bush Hog** SEVERAL

**A-12528BHSPL** Fork, 1 1/4" Dia. Shaft

**Bush Hog**

**A-92150** Dual Spindle

**Bush Hog** (ROTARY CUTTER: 2610L, 2615L)



**A-92008** Spindle, Single, Rotary Cutter

**Bush Hog** 2610L, 2615L

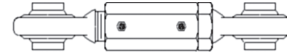

**A-50047270** Turnbuckle

**Replaces:** 50018319

**Bush Hog** 2610L, 2615L, 2720, 3710, 3715, 12720, 13710, 13715

**A-7114BH** Seal, Gearbox (473214)

**Bush Hog** 1050, 109, 1115S, 126, 160, 166, 220, 310

**A-EF7502617** Hanger-Ford

**Ford / New Holland** 917 Course Cut

**A-EF7501730** Link

**Ford / New Holland** 917 Fine Cut

**A-EF7501732** Blade, Flail Mower

**Ford / New Holland** 917 5' Fine Cut, 917 6' Fine Cut, 917 7' Fine Cut

**A-EF222157** Link-Ford

**Ford / New Holland** 917 Course Cut

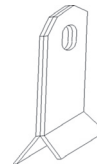

**A-7501971** Blade, Flail Mower, Course

**Ford / New Holland** 907, 917 5' Course Cut, 917 6' Course Cut, 917 7' Course Cut, 917A

**A-8A902** Bearing, Set

Contains two of the following: Seal, Cone, Cup, Bushing

**Bush Hog** SEVERAL

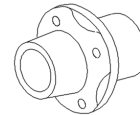

**A-C37** Tail Wheel Hub

**Hardee** SEVERAL



**A-700717701** Skid Shoe

**Hesston** 1365, 8070

Parts are not original equipment parts and are not sponsored, affiliated, or otherwise connected with any major brand.

# ROTARY CUTTER PARTS

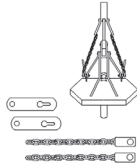

**A-159335** Stabilizer Kit, Mower Deck Height  
Kit Contains 2 Chains w/ Brackets

**Miscellaneous** SEVERAL

**A-49B830** Universal Frame Brackets  
Order 1 To Receive 2

**Miscellaneous** SEVERAL

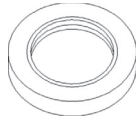

**A-37124A10C** Seal

**Rhino** SEVERAL

**A-18175SW** Seal

**Sidewinder** ALL MODELS

**A-15673SW** Seal

**Sidewinder** ALL MODELS



**A-314WD** Seal

**Woods** 84

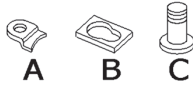

**A-32606WD** Pin Kit, Rotary Cutter Blade  
Contains 1 each: 4622WD Pin, 7A6003 Keyhole Plate, 7A6004 Lock Clip

**A-4622WD** Blade Pin (C)

**A-7A6005** Clamp Kit (A, B)

**Woods** SEVERAL

**A-7A6200** Pin Kit, Rotary Cutter Blade

**Woods** SEVERAL

**A-7A6350** Pin Kit, Rotary Cutter Blade  
Contains 1 each: 32616WD Blade Pin, 7A6003 Keyhole Plate, 7A6004 Lock Clip

**A-32616WD** Blade Pin

**Woods** SEVERAL

**A-7A6425** Pin Kit, Rotary Cutter Blade  
Contains 1 each: WD32602 Blade Bolt, 7A6003 Keyhole Plate, 7A6004 Lock Clip

**Woods** SEVERAL

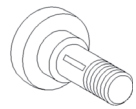

**A-15331WD** Pin, Rotary Cutter Blade

**Woods** SEVERAL

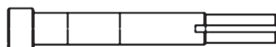

**A-4105** Arbor shaft finishing mower  
**Woods** 59AC, 59C-1, 59C-2, 59CF, 59CL-4, 59HB, 59HC, 59LB, 59TB, RM48KB, RM48KB\_E, RM48SB, RM48WH

**A-23902** Arbor shaft finishing mower

**Woods** RM306

**A-28897** Arbor shaft finishing mower

**Woods** RM59 Special

**A-15803WD** Pin, Rotary Cutter Blade

**Woods**

**A-7A5491** NUT 1" - 14 HEX JAM  
Used w/ 8227 Bolt & 8227LW Lock Washer

**Alamo** SEVERAL

**BMB** SEVERAL

**A-1259BHKIT** Bolt Kit, Rotary Cutter Blade  
Kit Contains: 2 Bolts, 2 Lock Washers & 2 Nuts

**Bush Hog** 104, 204, 204H, RAZORBACK RZ60, SQ36, SQ42, SQ420, SQ48, SQ480

Parts are not original equipment parts and are not sponsored, affiliated, or otherwise connected with any major brand.