



NUMBER: SB136012
 DATE: 07/21/05
 MODEL: All with Air
 Suspension

(Not applicable to Mack Trucks Australia)
 (Supersedes SB136012 dated 02/25/05)

Air Suspension Ride Height Gauges

Several different air suspensions are available for MACK model chassis. Each suspension model is unique in that the ride height specifications are different, along with the gauges used to measure ride height and the method of adjustment. This bulletin provides information concerning ride height gauge part numbers, which gauge is used for each suspension model, where the gauges can be ordered and identifying features of each suspension.

MAXLITE™ 20–40 Rear Air Suspension

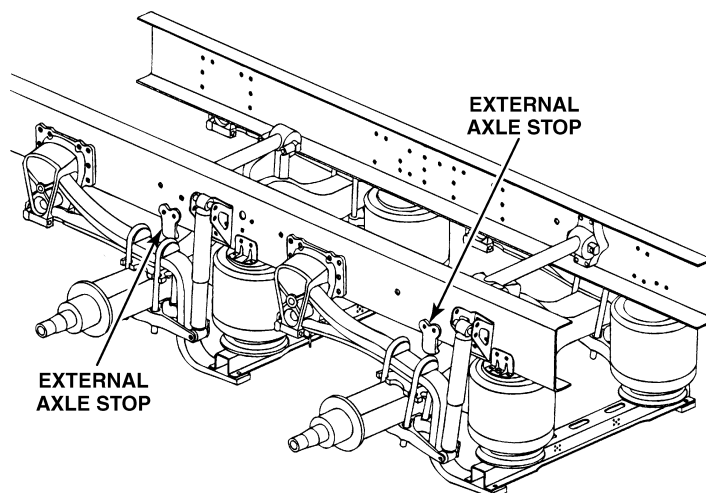

101646a

Figure 1 — MAXLITE™ 20–40 Rear Air Suspension

- **Suspension Model Designation and Usage** — MAXLITE™ 20–40 rear air suspension is used on CXN and CHN model chassis equipped with ArvinMeritor™ and Eaton axles.
- **Unique Identifying Feature** — The unique identifying feature of the MAXLITE™ air suspension is the external axle stops (see figure 1 above).
- **Ride Height Specification** — 8-1/2 in. (216 mm) as measured from the top of the axle housing (mid-point) to the top of the left-hand axle stop.

- **Ride Height Gauge Part No. and Ordering Information** — Use ride height gauge part No. TS89604 (refer to figure 2). This gauge can be ordered on-line by visiting the Service Publications section on the Mack Trucks web site www.macktrucks.com, or by faxing a completed BR313 Requisition Form to Pacesetters Business Services at 610-264-9465.

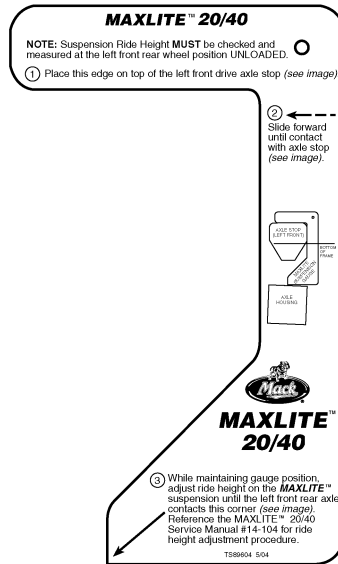

100642b

Figure 2 — MAXLITE™ 20–40 Ride Height Gauge

- **Service Manual** — For ride height measurement and adjustment procedures, along with all other service information, refer to the *MAXLITE™ 20–40 Rear Air Suspension Service Manual*, 14-104.

MaxAir™ 40/40A Rear Air Suspension

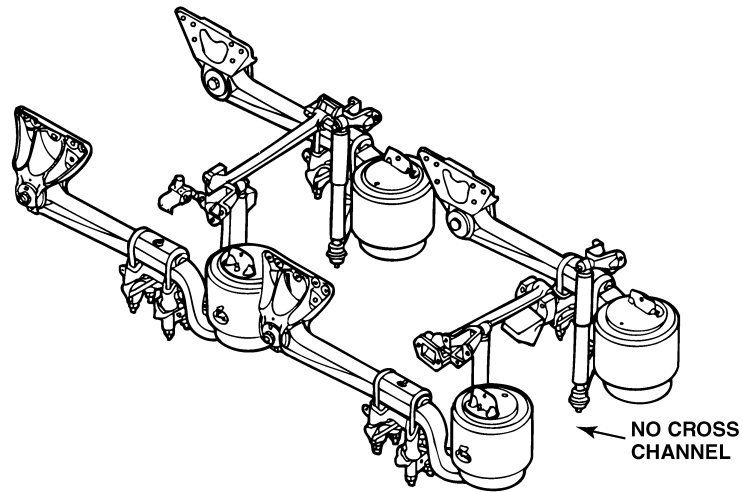

101647a

Figure 3 — MaxAir™ 40/40A Rear Air Suspension

- **Suspension Model Designation and Usage** — The MaxAir™ 40/40A is used on CH and CX model chassis equipped with either ArvinMeritor™ or Eaton axles.
- **Unique Identifying Feature** — The most obvious identifying feature of the MaxAir™ 40/40A suspension is that this suspension does not utilize a cross channel section between the air bags (refer to figure 3 above).
- **Ride Height Specification** — Beginning March 19, 2001, a different axle seat and spacer was implemented into production. This change resulted in the ride height being 3/8 in. (9.53 mm) lower than chassis manufactured prior to March 19, 2001. To identify chassis having the different axle seats and spacers, the spring clip (U-bolt) top caps on both sides of the chassis are marked with an “X” (refer to service bulletin SB-136-010). Ride height specifications for the MaxAir™ 40/40A suspension are as follows:
 - Chassis manufactured March 19, 2001 and later — 4-7/8 in. (123.83 mm)
 - Chassis manufactured prior to March 19, 2001 — 5-1/4 in. (133.35 mm)

- **Ride Height Gauge Part No. and Ordering Information** — The difference in ride heights requires two different ride height gauges. Part numbers for the gauges are as follows:
 - **Hendrickson Part No. 45745-164C** — For MaxAir™ 40/40A suspensions manufactured March 19, 2001 and later (the spring clip caps on these chassis are marked with an “X”)
 - **Hendrickson Part No. 45745-127** — For MaxAir™ 40/40A suspensions manufactured prior to March 19, 2001.

Both of the above gauges are available from Hendrickson Truck Suspension Systems and can be ordered by calling the Hendrickson Technical Center at 630-910-2800.

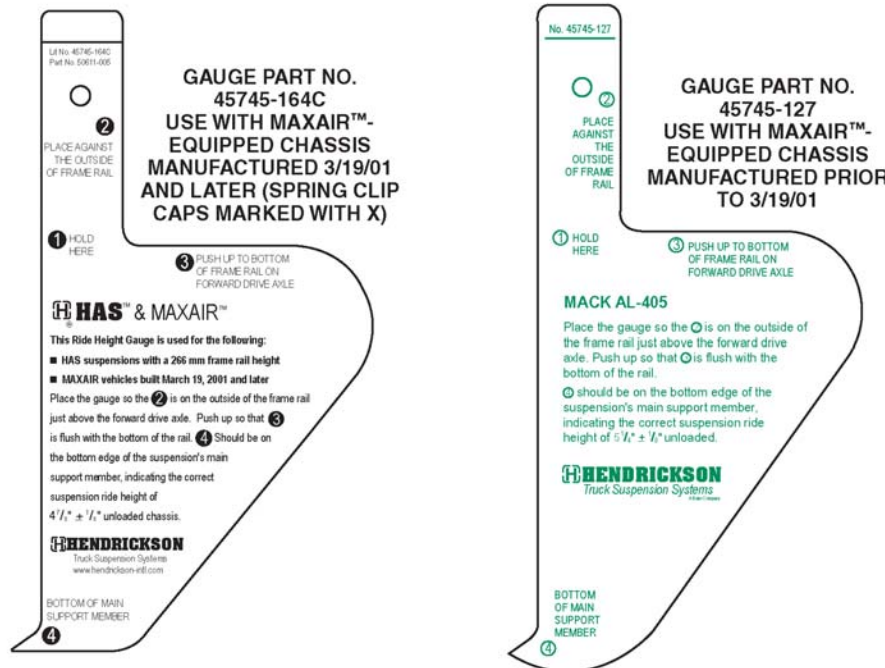

101648a

Figure 4 — MaxAir™ 40/40A Rear Air Suspension Ride Height Gauges

- **Service Manual** — For ride height measurement and adjustment procedures, along with all other service information, refer to the *MaxAir™ 40/40A Air Suspension Service and Repair Manual*, 14-102.

MACK AL and AL II Air Suspension

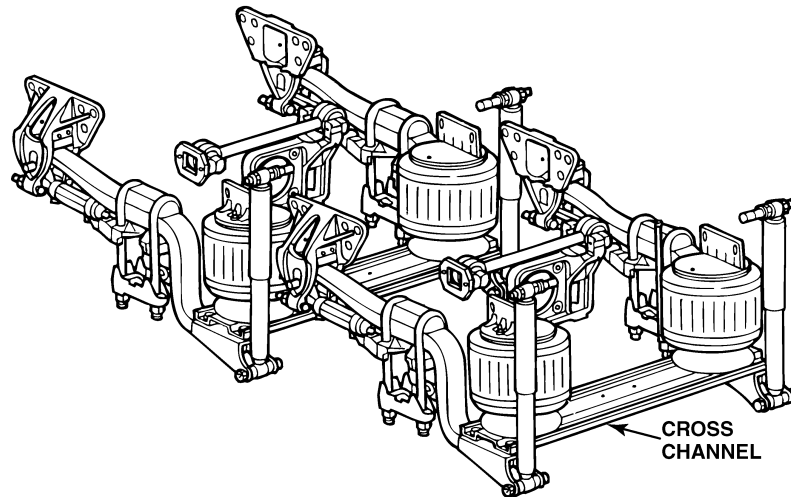

101649a

Figure 5 — MACK AL and AL II Air Suspension

- ▶ **REV** • **Suspension Model Designation and Usage** — The MACK AL and AL II air suspensions are used on CXN, CHN, CX, CH, CV, CT, CL and RD model chassis equipped with either MACK, ArvinMeritor™ or Eaton rear axles.
- **Unique Identifying Feature** — The MACK AL and AL II suspensions utilize a cross channel/tube between the air bags (refer to figure 5).
- **Ride Height Specifications** — Ride height specifications are as follows:
 - AL II (AL401, AL401LH and AL461) used with CXN and CHN models having 266 mm (10.47 in.) frame rails and MACK axles — 4-7/8 in. (123.83 mm)
 - ▶ **REV** – AL, AL II, AL401LH, and AL461 used with all CX, CH, CV, CT, CL and RD models equipped with MACK, ArvinMeritor™ and Eaton axles, and CXN and CHN models having 300 mm (11.81 in.) frame rails and MACK axles — 4-1/4 in. (107.95 mm)

NOTE

Frame rail height is measured from the top of the upper flange to the bottom of the lower flange.

- **Ride Height Gauge Part No. and Ordering Information** — Part numbers for the AL and AL II ride height gauges are as follows:

– **Hendrickson Part No. 45745-164C** — For CXN and CHN models having AL II (AL401, AL401LH and AL461) suspensions, 266 mm (10.47 in.) frame rails and MACK axles



– **Hendrickson Part No. 45745-050C** — For CX, CH, CV, CL and RD model chassis having AL or AL II suspensions and MACK, ArvinMeritor™ or Eaton axles, and CXN, CHN and CT model chassis having AL II suspensions, 300 mm (11.81 in.) frame rails and MACK axles

The above ride height gauges are available directly from Hendrickson Truck Suspension Systems and can be ordered by calling the Hendrickson Technical Center at 630-910-2800.

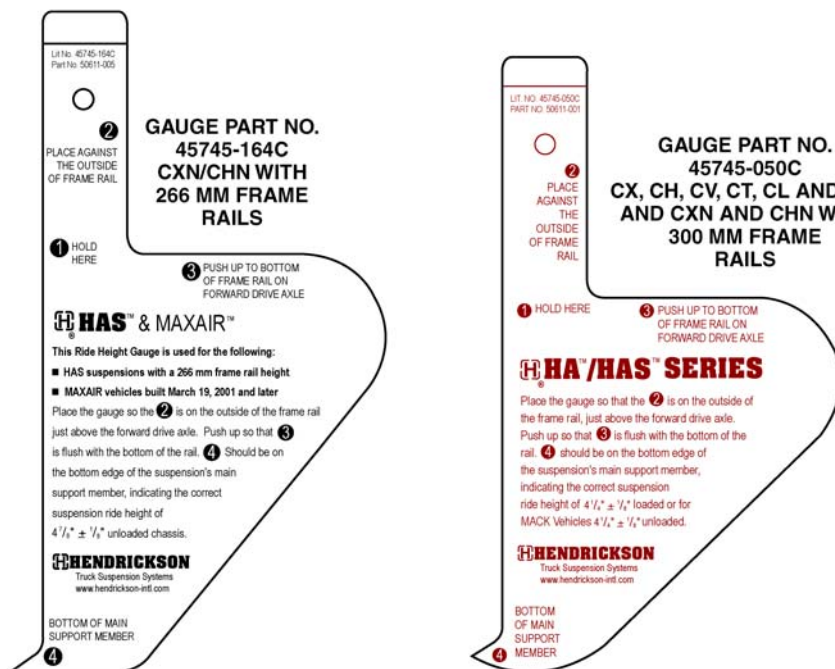

101650a

Figure 6 — MACK AL and AL II Air Suspension Ride Height Gauges

- **Service Manual** — For ride height measurement and adjustment procedures, along with all other service information, refer to the *MACK AL and AL II Air Suspension Service and Repair Manual*, 14-101.

AIRTEK® Front Axle Air Suspension

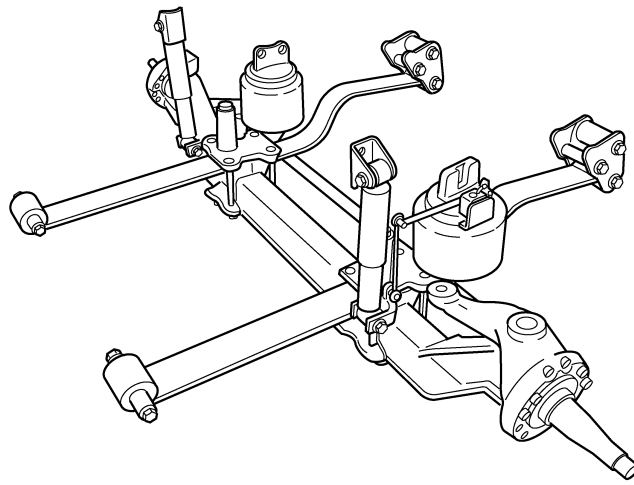

101651a

Figure 7 — AIRTEK® Front Axle Air Suspension

- **Suspension Model Designation and Usage** — AIRTEK® front steer axle air suspension used on CXN model chassis with 12.0 K or 14.6 K front axles.
- **Unique Identifying Feature** — Air suspension used on front axles (refer to figure 7).
- **Ride Height Specifications** — Ride height specifications for AIRTEK® front air suspensions are as follows:
 - CXN models with 12.0 K front axle and AIRTEK® front suspension — 7-7/8 in. (200.03 mm)
 - CXN models with 14.6 K front axle and AIRTEK® front suspension — 8-1/8 in. (206.50 mm)
- **Ride Height Gauge Part No. and Ordering Information** — Ride height gauge part numbers are as follows:
 - **Hendrickson Part No. 45745-170** — CXN models with 12.0 K front axle and AIRTEK® suspension
 - **Hendrickson Part No. 45745-195** — CXN models with 14.6 K front axle and AIRTEK® suspension



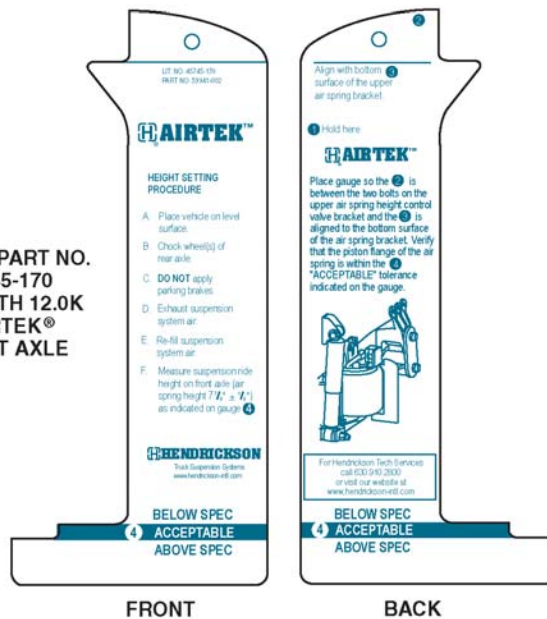
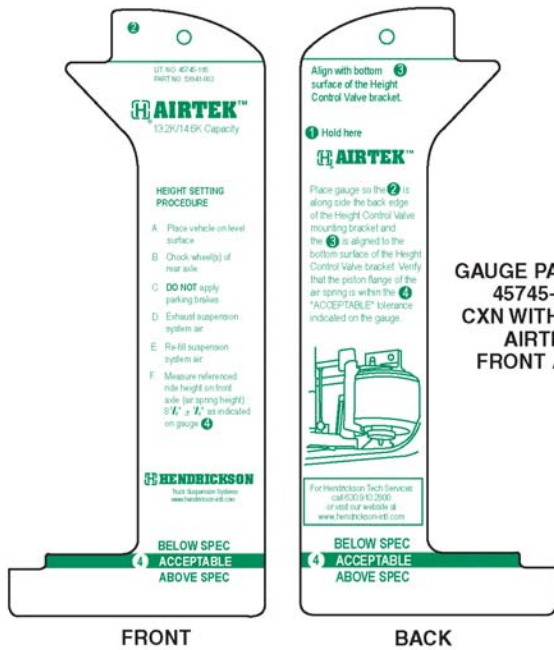



The above ride height gauges are available directly from Hendrickson Truck Suspension Systems and can be ordered by calling the Hendrickson Technical Center at 630-910-2800.

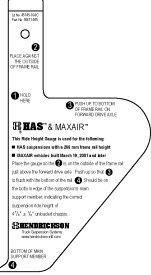

101652a

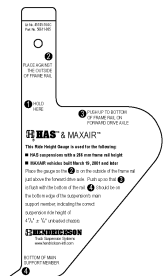
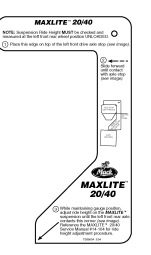
Figure 8 — AIRTEK® Front Suspension Ride Height Gauges

- **Service Manual** — For ride height measurement and adjustment procedures, along with all other service information, refer to the Technical Procedure Manual, AIRTEK® Service Instructions, publication No. 17730-247. The above manual is available directly from Hendrickson Truck Suspension Systems, and can be ordered by calling the Hendrickson Technical Center at 630-910-2800.

| | | | |
|---|--|---|---|
| <p>CXN/CHN AL II (AL401, AL401LH and AL461, or Hendrickson Designation HAS 40-46) 266 mm Frame Rails</p> | <p style="text-align: center;">REV</p>  <p>Ride Height — 4-7/8" Gauge Part No. 45745-164C Gauge Text Color — Black</p> | <p>CXN/CHN/CT AL II (AL401, AL401LH and AL461 or Hendrickson Designation HAS 40-46) 300 mm Frame Rails</p> |  <p>Ride Height — 4-1/4" Gauge Part No. — 45745-050C Gauge Text Color — Red</p> |
| <p>CX/CH MaxAir™ 40/40A Prior to 3/10/02</p> |  <p>Ride Height — 5-1/4" Gauge Part No. — 45745-127 Gauge Text Color — Green</p> | <p>CX/CH MaxAir™ 40/40a After 3/19/01</p> |  <p>Ride Height — 4-7/8" Gauge Part No. 45745-164C Gauge Text Color — Black</p> |
| <p>CXN/CHN MAXLITE™ 20-40</p> |  <p>Ride Height — 8-1/2" Gauge Part No. — TS89604 Gauge Text Color — Black</p> | <p>CX/CH/CL/CV/RD AL, AL II (AL401, AL401LH and AL461 or Hendrickson Designation HAS 40-46)</p> |  <p>Ride Height — 4-1/4" Gauge Part No. — 45745-050C Gauge Text Color — Red</p> |
| <p>CXN AIRTEK® Front Axle Air Suspension 12,000 Lb. Front Axle</p> |  <p>Ride Height — 7-7/8" Gauge Part No. — 45745-170 Gauge Text Color — Blue</p> | <p>CXN AIRTEK® Front Axle Air Suspension 14,600 Lb. Front Axle</p> |  <p>Ride Height — 8-1/8" Gauge Part No. — 45745-195 Gauge Text Color — Green</p> |